

# IEEE/LISS 2016

---

## Final Program

6<sup>th</sup> IEEE International Conference on

Logistics, Informatics and Service Sciences

24-27 July, 2016, Sydney, Australia & Beijing, China

**Hosted by**

IEEE Technical Committee on Logistics Informatics and Industrial Security Systems  
The International Center for Informatics Research of Beijing Jiaotong University, China  
China Center for Industrial Security Research of Beijing Jiaotong University, China  
School of Economics and Management of Beijing Jiaotong University, China

**In cooperation with**

The Institute of Transport and Logistics Studies in the University of Sydney Business School,  
the University of Sydney, Australia  
Informatics Research Centre, University of Reading, United Kingdom

**Supported by**

IEEE Systems, Man, and Cybernetics Society  
NSFC (National Natural Science Foundation of China)  
K. C. Wong Education Foundation (Hong Kong)  
Sino-EU Doctoral School for Sustainability Engineering (Program in Logistics, Information,  
Management and Service Science)  
EU FP7 (7th Framework Programme)  
Beijing Logistics Informatics Research Base  
Key Laboratory of Logistics Management and Technology of Beijing

## **Secretariat Contacts**

### **Secretariat in Australia:**

Email: [itls.liss2016@sydney.edu.au](mailto:itls.liss2016@sydney.edu.au)

Website: <http://sydney.edu.au/business/itls/LISS2016>

### **Secretariat in China:**

Address: Room753, 7th Teaching Building, Beijing Jiaotong University, Beijing, China, 100044

Tel.: +86-(0)10 - 51684188

Email: [liss@bjtu.edu.cn](mailto:liss@bjtu.edu.cn)

Website: <http://icir.bjtu.edu.cn/liss2016>

WeChat: LISS-IEIS国际会议



# Table of Contents

Foreword.....	1
Organizing Committees .....	3
International Steering Committee .....	5
International Program Committee .....	6
Opening Session.....	8
Keynote Lectures.....	18
The Sputnik of Servgoods: Autonomous Vehicles .....	19
Effects of Air Transport Liberalization on Foreign Traffic Inflow and Service Export and Import Trades.....	20
Order picking – A Critical Function in Supply Chain Management.....	22
Deep Learning Applications in Traffic and Transportation .....	23
Management Science in China and The 13th Five-year Plan for Management Science of NSFC.....	24
Global Value Chain and the Development in Logistics Industrial.....	25
Resilience and Sustainability of Container Supply Chains – a risk analysis perspective .....	26
Logistics Considerations in International Trade .....	27
To Transport Million Tons of Stored Coal in Datong by Using Overall Planning Method and Optimization Method.....	28
Conference Organisers.....	29
The Institute of Transport and Logistics Studies in the University of Sydney Business School, the University of Sydney, Australia.....	30
Henley Business School, University of Reading.....	32
School of Economics and Management, Beijing Jiaotong University.....	34
International Center for Informatics Research, Beijing Jiaotong University.....	37
China Center for Industrial Security Research.....	39
Workshops .....	40
Sustainable Container Supply Chain Management .....	41
Transport Economics and Modelling.....	46
Special Sessions.....	47
Intelligent Data Analysis .....	48
Social Event.....	50
Performance by Descendance International.....	51
General Information .....	52
Rooms Layout.....	54
Sydney Venue.....	55
China Venue.....	57
Program Layout .....	60
Sydney Venue (Local Time) .....	61
China Venue (Local Time) .....	64
Final Program.....	67
Contents .....	68
Session Schedule .....	92
Author Index.....	108



## Foreword

This volume contains the proceedings of the 6<sup>th</sup> IEEE International Conference on Logistics, Informatics and Services Sciences (LISS'2016) which is held in Sydney, Australia and Beijing, China, and hosted by IEEE Technical Committee on Logistics Informatics and Industrial Security Systems. The International Center for Informatics Research of Beijing Jiaotong University (ICIR), China Center for Industrial Security Research of Beijing Jiaotong University (CCISR), and School of Economics and Management of Beijing Jiaotong University (SEM), in cooperation with the Institute of Transport and Logistics Studies in the University of Sydney Business School, the University of Sydney, Australia, Informatics Research Centre, University of Reading, United Kingdom, and supported by IEEE SMC, the National Natural Science Foundation of China (NSFC), K. C. Wong Education Foundation (Hong Kong), Sino-EU Doctoral School for Sustainability Engineering (Program in Logistics, Information, Management and Service Science), EU FP7 (7th Framework Programme), Beijing Logistics Informatics Research Base, and Key Laboratory of Logistics Management and Technology of Beijing.

This conference is a prime international forum for both researchers and industry practitioners to exchange latest fundamental advances in state-of-art and practice of logistics, informatics, service operations and service sciences. It has four simultaneous tracks, which cover different aspects and include: Service Management, Logistics Management, Information Management, and Engineering Management. Papers published in each track describe state-of-art research works that are often oriented towards real world applications and highlight the benefits of related methods and techniques for the emerging field of logistics, informatics and service science development.

LISS'2016 received 573 paper submissions from 13 countries and regions. 281 papers were accepted and published after strict peer reviews. The total acceptance ratio is 49%. Additionally, a number of invited talks, presented by internationally recognized experts in different areas, have positively contributed to reinforce the overall quality of the conference and to provide a deep understanding of related areas.

The program for this conference required the dedicated effort of many people. Firstly, we would like to thank the authors, whose research and development efforts are recorded here. Secondly, we thank the members of the program committee and the additional reviewers for a valuable help with their expert reviewing of all submitted papers. Thirdly, we thank the invited speakers for their invaluable contribution and the time for preparing their talks. Fourthly, we thank the special session chairs whose collaboration with LISS was much appreciated. Finally many thanks are given to the colleagues from Beijing Jiaotong University and the Institute of Transport and Logistics Studies in the University of Sydney Business School, the University of Sydney for their hard work in organizing this event.

Together with LISS'2016 and IEIS'2016, we are also honored to simultaneously host four other important academic events, i.e., 2016 Doctoral International Summer School for Modern Logistics Management, 2nd Summer School of Sino-EU Doctoral School for Logistics, Information, Management, and Service Science, Forum of Sustainable Container Supply Chain Management, and Forum of Big Data Driven Innovation and Management of Intelligent Healthcare.

We wish you all enjoyed an exciting conference and an unforgettable stay in Sydney, Australia or in Beijing, China. We hope to meet you again next year for the LISS'2017 at Kyoto University, Japan, and the details of which will soon be available at <http://icir.bjtu.edu.cn/liss2017>.

Prof. Runtong Zhang

International Center for Informatics Research, Beijing Jiaotong University, China

Prof. Juliang Zhang

International Center for Informatics Research, Beijing Jiaotong University, China

Prof. David Hensher

University of Sydney, Australia

Prof. Xiaowen Fu

University of Sydney, Australia

Prof. Guowei Hua

International Center for Informatics Research, Beijing Jiaotong University, China

Prof. Mincong Tang

International Center for Informatics Research, Beijing Jiaotong University, China

# Organizing Committees

## Honorary Chairmen

Academician Shoubo Xu (Academician of China National Academy of Engineering), Beijing Jiaotong University, China

Academician James M. Tien (Academician of America National Academy of Engineering, Past President of IEEE SMC, IEEE Fellow), University of Miami, USA

C. L. Philip Chen (Past President of IEEE SMC, IEEE Fellow, AAAS Fellow, University of Macau, China)

## General Chairs

Runtong Zhang, Beijing Jiaotong University, China

David Hensher, University of Sydney, Australia

Zhongliang Guan, Beijing Jiaotong University, China

C. L. Philip Chen, University of Macau, China

Kecheng Liu, University of Reading, United Kingdom

## Program Chairs

Zhenji Zhang, Beijing Jiaotong University, China

Xiaowen Fu, University of Sydney, Australia

Juliang Zhang, Beijing Jiaotong University, China

Xianliang Shi, Beijing Jiaotong University, China

## Financial Chairs

Shifeng Liu, Beijing Jiaotong University, China

## Secretariat

Dan Chang, Beijing Jiaotong University, China

Yisong Li, Beijing Jiaotong University, China

## Publication Chairs

Guowei Hua, Beijing Jiaotong University, China

Mincong Tang, Beijing Jiaotong University, China

Honglu Liu, Beijing Jiaotong University, China

## Organization Chairs

Xiaowen Fu, University of Sydney, Australia

Xiaochun Lu, Beijing Jiaotong University, China

## Special Session/Workshop Chairs

Hongjie Lan, Beijing Jiaotong University, China

Xiaowen Fu, University of Sydney, Australia

## Publicity Chairs

Organizing Committees

Jie Gao, Beijing Jiaotong University, China

Xiaomin Zhu, Beijing Jiaotong University, China

Xiaopu Shang, Beijing Jiaotong University, China



## International Steering Committee

### CHAIRS

**James M. Tien**, University of Miami, USA  
**Shoubo Xu**, Beijing Jiaotong University, China  
**Bin Ning**, Beijing Jiaotong University, China  
**C. L. Philip Chen**, University of Macau, China

### MEMBERS

**Francisco Vallverdu Bayes**, Universitat Politècnica de Catalunya BarcelonaTech, Sydney  
**Guoqing Chen**, Tsinghua University, China  
**Jian Chen**, Tsinghua University, China  
**Yu Chen**, Renmin University of China, China  
**Zhixiong Chen**, Mercy College, USA  
**T. C. Edwin Cheng**, The Hong Kong Polytechnic University, China  
**Waiman Cheung**, The Chinese University of Hong Kong, China  
**Jae-Sun Choi**, Korea Maritime Institute, Korea  
**Shicheng D**, Royal Institute of Technology-KTH, Sweden  
**Dingyi Dai**, China Federation of Logistics & Purchasing, China  
**Xuedong Gao**, University of Science and Technology Beijing, China  
**David Gonzalez-Prieto**, Universitat Politècnica de Catalunya BarcelonaTech, Sydney  
**Liming He**, China Federation of Logistics & Purchasing, China  
**Harald M. Hjelle**, Molde University College, Norway  
**Joachim Juhn**, Anglia Ruskin University, UK  
**Kim Kap-Hwan**, Pusan National University, Korea  
**Harold Krikke**, Tilburg University, The Netherlands  
**Erwin van der Laan**, RSM Erasmus University, The Netherlands  
**Der-Horng Lee**, The National University of Singapore, Singapore  
**Dong Li**, University of Liverpool, UK  
**Menggang Li**, China Center for Industrial Security Research, China  
**Cheng-chang Lin**, National Cheng Kung University, Taipei, China  
**Kecheng Liu**, University of Reading, UK  
**Oriol Lordan**, Universitat Politècnica de Catalunya BarcelonaTech, Sydney  
**Qining Mai**, The University of Hong Kong, China  
**Theo Notteboom**, University of Antwerp, Belgium  
**Yannis A. Phillis**, The Technical University of Crete, Greece  
**Robin Qiu**, Pennsylvania State University, USA  
**Jurgita Raudeliuniene**, Vilnius Gediminas Technical University, Lithuanian  
**Linda Rosenman**, Victoria University, Australia  
**Kurosu Seiji**, Waseda University, Japan  
**Zuojun (Max) Shen**, University of California, USA  
**Jiuh-BiingSheu**, National Chiao Tung University, Taipei  
**Carlos Sicilia**, Universitat Politècnica de Catalunya BarcelonaTech, Sydney  
**Pep Simo**, Universitat Politècnica de Catalunya BarcelonaTech, Sydney

**Dong-Wook Song**, Edinburgh Napier University, UK  
**dr. Jelena Stankeviciene**, Vilnius Gediminas Technical University, Lithuanian  
**A Min Tjoa**, Vienna University of Technology, Austria  
**Jaume Valls-Pasola**, Universitat Politècnica de Catalunya BarcelonaTech, Sydney  
**Lida Xu**, Old Dominion University, USA  
**David C. Yen**, Miami University, USA

## International Program Committee

**Muna Alhammad**, University of Reading, UK  
**Bernhard Bauer**, University of Augsburg, Germany  
**Ida Bifulco**, University of Salerno, Italy  
**Christoph Bruns**, Fraunhofer Institute for Material Flow and Logistics, Germany  
**Luis M. Camarinha-Matos**, New University of Lisbon, Portugal  
**Mei Cao**, University of Wisconsin – Superior, USA  
**Maiga Chang**, Athabasca University, Canada  
**Sohail Chaudhry**, Villanova University, USA  
**Gong Cheng**, University of Reading, UK  
**Alessandro Creazza**, University of Hull, UK  
**Lu Cui**, Hohai University, China  
**Kamil Dimililer**, Near East University, Cyprus  
**Chunxiao Fan**, Beijing University of Posts and Telecommunications, China  
**Zhi Fang**, Beijing Institute of Technology, China  
**Vicenc Fernandez**, Universitat Politècnica de Catalunya BarcelonaTech, Sydney  
**Juan Flores**, Universidad Michoacana de San Nicolás de Hidalgo, Mexico  
**Alexander Gelbukh**, National Polytechnic Institute, Mexico  
**Joseph Giampapa**, Carnegie Mellon University, USA  
**Wladyslaw Homenda**, Warsaw University of Technology, Poland  
**Wei-Chiang Hong**, Oriental Institute of Technology, Taipei  
**Alexander Ivannikov**, State Research Institute For Information Technologies and Telecommunications, Russian Federation  
**Taihoon Kim**, Sungshin Women's University, Korea  
**Rob Kusters**, Eindhoven University of Technology, The Netherlands  
**Der-Horng Lee**, the National University of Singapore, Singapore  
**Kauko Leiviskä**, University of Oulu, Finland  
**Zhi-Chun Li**, Huazhong University of Science and Technology, China  
**Da-Yin Liao**, National Chi-Nan University, Taipei  
**Shaoyi Liao**, City University of Hong Kong, HK  
**Cheng-Chang Lin**, National Cheng Kung University, Taipei  
**Shixiong Liu**, University of Reading, UK  
**Miguel R. Luaces**, Universidade da Coruña, Sydney  
**Zhimin Lv**, University of Science Technology Beijing, China  
**Nuno Mamede**, INESC-ID/IST, Portugal  
**Vaughan Michell**, Reading University, UK

**Jennifer Min**, Ming Chuan University, Taipei  
**Nada Nadhrah**, University of Reading, UK  
**Paolo Napoletano**, University of Salerno, Italy  
**David L. Olson**, University of Nebraska, USA  
**Stephen Opoku-Anokye**, University of Reading, UK  
**Rodrigo Paredes**, Universidad de Talca, Chile  
**Puvanasvaran A. Perumal**, Universiti Teknikal Malaysia Melaka, Malaysia  
**Dana Petcu**, West University of Timisoara, Romania  
**Henryk Piech**, The Technical University of Czstochowa, Poland  
**Geert Poels**, Ghent University, Belgium  
**Elena Prosvirkina**, National Research University, Russian Federation  
**Michele Risi**, University of Salerno, Italy  
**BaasemRoushdy**, Arab Academy for Science and Technology, Egypt  
**Ozgur Koray Sahingoz**, Turkish Air Force Academy, Turkey  
**Liao Shaoyi**, City University of Hong Kong, HK  
**Cleyton Slaviero**, Universidade Federal Fluminense, Brazil  
**Lily Sun**, University of Reading, UK  
**Ryszard Tadeusiewicz**, AGH University of Science and Technology, Poland  
**Shaolong Tang**, Hong Kong Baptist University, China  
**Vladimir Tarasov**, Jnkping University, Sweden  
**Arthur Tatnall**, Victoria University, Australia  
**Lu-Ming Tseng**, Feng Chia University, Taipei  
**Theodoros Tzouramanis**, University of the Aegean, Greece  
**Wenjie Wang**, Donghua University, China  
**Zhong Wen**, Tsinghua University, China  
**Martin Wheatman**, Brightace Ltd, UK  
**Sen Wu**, University of Science Technology Beijing, China  
**Yuxin Wu**, Beijing University of Posts and Telecommunications, China  
**Yibin Xiao**, University of Electronic Science and Technology of China  
**Hangjun Yang**, University of International Business and Economics, China  
**Jie Yang**, University of Houston-Victoria, USA  
**Muhamet Yildiz**, Northwestern University, USA  
**Wen-Yen**, WuI-Shou University, Taipei  
**Jiashen You**, University of California Los Angeles, USA  
**Rui Zhang**, Donghua University, China  
**Yong Zhang**, Southeast University, China  
**Matthew Zeidenberg**, Columbia University, USA  
**Eugenio Zimeo**, University of Sannio, Italy  
**J. X. Zhang**, Xian Technology University, China  
**Zhongxiang Zhang**, Fudan University, China  
**Bo Zou**, University of Illinois at Chicago, USA

# Opening Session

## **Australia**

**Monday, 25 July**

09:00-09:30 (Local Time)

Lec Room 1, Level 17, University of Sydney Business School CBD Campus  
133 Castlereagh St, Sydney, Australia

## **China**

**Monday, 25 July**

09:00-09:30 (Local Time)

International Conference Center, Beijing Jiaotong University  
3 Shangyuancun, Haidian District, Beijing, China



# Keynote Lectures

---

**Sydney**

**Monday, 25 July**

**09:30-10:15 (Local Time)**

**Room: Lec Room 1**

## **The Sputnik of Servgoods: Autonomous Vehicles**

James M. Tien

*IEEE Fellow, Academician of America National Academy of Engineering*

*Distinguished Professor and Dean of College of Engineering*

*University of Miami, Coral Gables, Florida, USA*

In an earlier paper [Tien 2015], the author defined the concept of a servgood, which can be thought of as a physical good or product enveloped by a services-oriented layer that makes the good smarter or more adaptable and customizable for a particular use. Adding another layer of physical sensors could then enhance its smartness and intelligence, especially if it were to be connected with each other or with other servgoods through the Internet of Things. Such sensed servgoods are becoming the products of the future. Indeed, autonomous vehicles can be considered the exemplar servgoods of the future; it is about decision informatics and embraces the advanced technologies of sensing (i.e., Big Data), processing (i.e., real-time analytics), reacting (i.e., real-time decision-making), and learning (i.e., deep learning). Since autonomous vehicles constitute a huge quality-of-life disruption, it is also critical to consider its policy impact on privacy and security, regulations and standards, and liability and insurance. Finally, just as the Soviet Union inaugurated the space age on October 4, 1957, with the launch of Sputnik, the first man-made object to orbit the Earth, the U. S. has inaugurated an age of automata or autonomous vehicles that can be considered to be the U. S. Sputnik of servgoods, with the full support of the U. S. government, the U. S. auto industry, the U. S. electronic industry, and the U.S. higher educational enterprise.



In 2007, Dr. James M. Tien became a Distinguished Professor and the Dean of the College of Engineering at the University of Miami, Coral Gables, Florida. He received the BEE from Rensselaer Polytechnic Institute (RPI) and the SM, EE and PhD from the Massachusetts Institute of Technology (MIT). He has held leadership positions at Bell Telephone Laboratories, at the Rand Corporation, and at Structured Decisions Corporation (which he co-founded). He joined the Department of Electrical, Computer and Systems Engineering at RPI in 1977, became Acting Chair of the department, joined a unique interdisciplinary Department of Decision Sciences and Engineering Systems as its founding Chair, and twice served as the Acting Dean of Engineering. Dr. Tien has published extensively, been invited to present dozens of plenary lectures, and been honored with both teaching and research awards, including being elected a Fellow in IEEE, INFORMS and AAAS and being a recipient of the IEEE Joseph G. Wohl Outstanding Career Award, the IEEE Major Educational Innovation Award, the IEEE Norbert Wiener Award, the IEEE Richard M. Emberson Award, and the IBM Faculty Award. He received a Doctor of Engineering (honoris causa) from Canada's University of Waterloo and is also an Honorary Professor at over a dozen non-U.S. universities. Dr. Tien is an elected member of the prestigious U. S. National Academy of Engineering.

---

**Sydney**

**Monday, 25 July**

**10:35-11:20 (Local Time)**

**Room: Lec Room 1**

## **Effects of Air Transport Liberalization on Foreign Traffic Inflow and Service Export and Import Trades**

Tae Hoon OUM

*UPS Chair Professor, Sauder School of Business, University of British Columbia, Canada;*

*Chairman, the Air Transport Research Society (ATRS)*

Models for measuring the effects of Open Skies Agreements (OSAs) on bilateral foreign traffic inflow and on service export and import trades are constructed, and applied to Canada's and United States' bilateral foreign passenger inflow and service trade export and import data. The effects of US Open Skies agreement on Canada's bilateral foreign traffic inflow and services trades are also investigated. Our service trade data includes GATS Mode 1 (cross-border trade) and Mode 2 (cross-border consumption including transportation and tourism) service trades.



Dr. Tae Oum focuses on research and teaching in economics, management strategy and policy analysis in transport/logistics and public utility sectors. He serves on Editorial Boards of twelve international journals including having served as an Editor of Journal of Transport Economics and Policy for 13 years (1998-2011). Also, he has been the founding chair of the ATRS Global Airport Performance benchmarking Task Force report project from its inception in 2002.

He has authored/co-authored 36 books, 130+ refereed journal papers, and numerous reports for international organizations including World Bank, OECD, International Transport Forum, APEC, ICAO and for many government agencies, regulatory commissions and major corporations (Canada, United States, UK, Netherlands, Japan, Korea, Australia, New Zealand, Singapore, Turkey). He has delivered over 350 keynote addresses, invited speeches/seminars, and presentations including two open addresses at the ICAO conferences (2012, 2014).

The honors and distinctions he received include Air Transport News (ATN) Distinguished Career Researcher Awards (2013); the Distinguished Career Research Achievement Award from the (US) Transportation Research Forum (TRF, 2006); Overall Best Paper Prize from the US TRF (2009); The Overall Best Paper Prize from The World Conference on Transport Research Society (1998); Killam Research Prize of Canada-Senior Science Category (2002); Killam Research Fellowship (1988); A Distinguished Fellow of the (US) Transportation & Public Utilities Group (AEA-TPUG) since 2004. He has also been decorated with a Medal of National Order of Merit by the President of Korea (South) in 2005.

Dr. Oum has advised and delivered keynote addresses, invited seminars and executive classes at numerous universities around the world, major international airports (Amsterdam-Schiphol, Seoul-Incheon, Korea Airports Corp, Beijing Capital, Osaka-Kansai, Nagoya-Centrair airports), World Bank, OECD, International Transport Forum, APEC, Transport Canada, Dutch Ministries of Transport and of Economic Affairs, UK Competition



Commission, UK Civil Aviation Authority, UK Rail Regulator, AT&T, Australian Consumer and Competition Commission, JR-Central, Air Canada, United Airlines, Northwest Airlines, Japan Airlines, All Nippon Airways, Korean air, Qantas, Virgin Blue, Turkish Airways, etc.

For Canada, Dr. Oum provided experts services to Royal Commission on National Passenger Services on air transport and passenger rail studies (1990-1993), and International Air Policy Task Force (1990s again), CTRC Experts on Long Distance Telecom Deregulation (1991-92). For British Columbia, he served as the Chairman of Korean Market Advisory Group (KMAG) for the Asia Pacific Trade Council for three years (2006-2009) and helped BC Government (under leadership of Premier Gordon Campbell to organize the Open Skies Summit Conference (organizers: three western Premiers of BC, Alberta and Saskatchewan) in Sept, 2009.

**Sydney**

**Monday, 25 July**

**11:20-12:05 (Local Time)**

**Room: Lec Room 1**

## **Order picking – A Critical Function in Supply Chain Management**

Gerhard W äscher

*Professor and Chair of Management Science*

*Otto-von-Guericke University*

*Faculty of Management and Economics, 39016 Magdeburg, Germany*

Order picking is a warehouse function which deals with the retrieval of items from their storage location in order to satisfy a certain given demand. It arises because incoming articles are received and stored in (large-volume) unit loads while (internal or external) customers order small volumes (less-than-unit loads) of different articles. Order picking is critical for managing supply chains efficiently, since underperformance results in an unsatisfactory customer service (long processing and de-livery times, incorrect shipments) and high costs (labor cost, cost of additional and/or emergency shipments).

In this presentation, the author will give an overview of planning problems and corresponding methods for the reduction of cost and the improvement of customer service in picker-to-product systems. In particular, the following central planning issues will be addressed: Item location, order batching, and picker routing.



Gerhard W äscher serves as Professor and Chair of Management Science at Otto-von-Guericke University Magdeburg since 2002. He received a PhD in Economic Sciences from Ruhr-University Bochum in 1981 and his Habilitation from the University of Stuttgart in 1990. Before he moved to Magdeburg, he has held positions of a full professor of management at the universities of Heidelberg (1990/91), Braunschweig (1991-1995) and Halle (1995-2002). He has also held guest professorships or visiting appointments at the University of Vienna, the University of St.

Gallen, Tong-Ji University Shanghai, Monash University Melbourne, Macquarie University Sydney and others. In 2015, he was appointed as a permanent guest professor and adjunct professor by Beijing Jiaotong University.

Prof. W äscher has (co-)authored five monographs more than 50 papers and (co-)edited more than 15 special issues of scientific journals or conference proceedings. He has also served and is still serving on the editorial boards of renowned international journals, e.g. the European Journal of Operational Research, OR Spectrum, Central European Journal of Operations Research and Business Research. His current research interests refer to the development and application of quantitative approaches to management problems in production and logistics management. In this field he has also been involved in various consulting projects for organizations in industry and administration.

Professionally, Prof. W äscher has been a member of the Executive Committee of EURO – The Association of European Operational Research Societies for nine years, of which he served as its President in 2013 and 2014. From 2003 to 2006, he was also Chairman of the Executive Committee of GOR, the German Operations Research Society.

**Sydney**

**Monday, 25 July**

**12:05-12:50 (Local Time)**

**Room: Lec Room 1**

## **Deep Learning Applications in Traffic and Transportation**

C. L. Philip Chen

*IEEE Fellow, FAAAS Fellow*

*Dean and Chair Professor of the Faculty of Science and Technology*

*University of Macau, Macau, China*

The talk is to discuss recent interesting subject in deep learning technique and its application in traffic flow prediction. Deep learning is a machine learning algorithm that attempt to learn in multiple levels, corresponding to different levels of abstraction. Alternatively, the main advantage of deep learning is about learning multiple levels of representation and abstraction. It is typically used to abstract useful information from data. The levels in these learned statistical models correspond to distinct levels of concepts, where higher-level concepts are defined from lower-level ones, and the same lower level concepts can help to define many higher-level concepts. The concepts can be applied in prediction and decision making in different areas.



C.L. Philip Chen received the M.S. degree in electrical engineering from the University of Michigan, Ann Arbor, in 1985 and the Ph.D. degree in electrical engineering from Purdue University, West Lafayette, IN, in 1988. After having worked at U.S. for 23 years as a tenured professor, as a department head and associate dean in two different universities, he is currently the Dean of the Faculty of Science and Technology, University of Macau, Macau, China and a Chair Professor of the Department of Computer and Information Science. Dr. Chen is a Fellow of the IEEE and the AAAS. He has been the President of IEEE Systems, Man, and Cybernetics Society (2012-2013). Currently, he is the Editor-in-Chief, of IEEE Transactions on Systems, Man, and Cybernetics: Systems (2014-2015) and associate editors of IEEE Access and several IEEE Transactions. He is also the Chair of TC 9.1 Economic and Business Systems of IFAC. His research areas are systems, cybernetics, and computational intelligence. He is also an executive committee member of Chinese Association of Automation, Fellow of CAA, and Associate EIC of CAA Communications , a Fellow of Hong Kong Institute of Engineer. A Program Evaluator of ABET (Accreditation Board of Engineering and Technology) in Electrical Engineering, Computer Engineer and Software Engineering.

---

**Beijing**

**Monday, 25 July**

**10:10 - 11:10 (Local Time)**

**Room: International Conference Center**

## **Management Science in China and The 13th Five-year Plan for Management Science of NSFC**

Yijun Li

*Executive Deputy Director in Management Division of NSFC, China*



Yijun Li serves as professor and Ph.D supervisor at the School of Management in Harbin Institute of Technology. He is also the Executive Deputy Director in Management Division of NSFC. He received his Ph.D degree in Management Engineering from Harbin Institute of Technology in 1991. He is the China's Chang-Jiang Scholars Distinguished Professor, the member of Expert Committee of Undergraduate Teaching Evaluation, Vice Chairman of Systems Engineering Society of China, Vice Chairman of Society of Management Science and Engineering of China, and Vice Chairman of CNAIS. His research interests focus on electronic commerce, business intelligence, decision support system and so on. He has published more than 150 academic papers. And he has authored (co-authored) more than 10 academic books.

**Beijing**

**Monday, 25 July**

**11:10 - 12:10 (Local Time)**

**Room: International Conference Center**

## **Global Value Chain and the Development in Logistics Industrial**

Shouyang Wang

*TWAS Fellow, IASCYS fellow*

*China's Chang-Jiang Scholars Distinguished Professor*

*Vice President of Academy of Mathematics and Systems Science*

*Director of the Center for Forecasting Science*

*Dean of Economic and Management in University of Chinese Academy of Sciences*

*Chairman of International Society of Knowledge and Systems Sciences*

*Chairman of Systems Engineering Society of China*

Prof. Wang's research interests focus on financial management, logistics and supply chain management, strategy and conflict analysis, economic analysis and forecasting, which has been highly praised by the international peers and received great attentions from relevant government departments. He wrote more than 150 Research Reports about Forecasts and Policy, 60 of them received highly attentions from General Secretary, Prime Minister and other state leaders. Many policy recommendations are adopted by the government, which has being used to produce the government's economic policy and industrial policy. He services as editor-in-chief, field editor, associate editor or editorial board of fifty international journals and eight Chinese journals.



From the perspective of global value chain, what kind of development opportunities are the China's logistics industries facing? What are main challenges? How to deal with these main challenges? What are the important issues and the direction in the academic circles? What new theories may they bring about? I wish to discuss these issues in the lecture, and provide PhD students with a panoramic view and a number of research proposals.

---

**Beijing**

**Monday, 25 July**

**14:00-15:00 (Local Time)**

**Room: International Conference Center**

## **Resilience and Sustainability of Container Supply Chains – a risk analysis perspective**

Zaili Yang

*Faculty of Engineering and Technology  
School of Maritime and Mechanical Engineering  
Liverpool John Moores University (LJMU), UK*

Risk research represents an important challenge for the resilience and sustainability of container supply chains (CSCs) due to climate change, terrorism threats and an increasing amount of economic upheaval in the past decade. Its foci are being expanded from classical safety, through security to climate adaptation areas. Addressing risks of different features requires integration across disciplines and across research methodologies. Currently, we lack the critical understanding of which kinds of risk schemes can most effectively harness science and technology for achieving long-term resilient and sustainable CSCs. This work aims at introducing a novel total risk management programme which enables the quantification, integration and communication of risk information from different areas and facilitates the movement of risk culture from a traditional reactive single dimensional scheme towards a new proactive multiple dimensional regime. The presentation is then followed by detailed risk analysis work in two research streams: 1) maritime security resilience assessment and 2) port adaptation to climate change. The work will address the significant methodological issues associated with resilience and sustainability sciences particularly with reference to risk analysis under high uncertainty.



Prof. Yang's research interests are system safety, security and risk based decision making modelling, especially their applications in marine and supply chain systems. Prof. Yang has conducted more than 20 externally funded projects from the EU, UK EPSRC and UK TSB and DTI to support his research. Research funding support has also been received from government collaborators (i.e. UK MoD and Korean research collaborative funds) via PhD research projects. Prof. Yang has successfully completed 4 postdoctoral and 15 PhD projects. He currently has 2 postdoctoral and 11 PhD students under his supervision in the research areas of maritime safety, logistics operations and port optimisation. His research findings have been published in more than 150 technical papers in risk and supply chain areas, including 60 refereed journal papers. Prof. Yang is a member of editorial boards of seven international journals such as IMA Journal of Management Mathematics and Journal of Traffic and Transportation Engineering and (co)editor of four special issues on journals such as Transportation Research Part D and Part E. He has also served as a member of review boards for national research councils of countries such as Norway and USA. He is a Fellow of Institute of Maritime Engineering, Science and Technology (IMarEST) and a Member of International Association of Maritime Economics.

**Beijing**

**Monday, 25 July**

**15:00-16:00 (Local Time)**

**Room: International Conference Center**

## **Logistics Considerations in International Trade**

Martin Dresner

*Professor and Chair of the Logistics, Business and Public Policy Department*

*R.H. Smith School of Business, University of Maryland, USA*

Over the past several decades, there has been a substantial increase in international trade. Firms have increasingly sourced products from foreign countries and expanded their sales into foreign markets. However, increased trade has important implications for firm performance, largely due to longer and more complex supply chains. The results of two papers are presented that highlight how increased international operations impact a key cost center for many manufacturing firms, notably inventory costs. A greater reliance on imports and exports is found to be associated with higher inventory levels. However, further findings show that the establishment of operations in emerging markets may also lead to improved performance.



Martin Dresner has served on the faculty of the R.H. Smith School of Business at the University of Maryland since 1988, where he is currently Professor and Chair of the Logistics, Business and Public Policy Department. He received his Ph.D. in Policy Analysis from the Sauder School of Business at the University of British Columbia. Dresner's research focuses on two broad areas, air transport policy and logistics management. He has published over 75 papers in refereed journals. Professionally, he is President of the Air Transport Research Society (ATRS), an academic organization devoted to research in the aviation industry. In addition, Dresner is on the Scientific and Steering Committees of the World Conference on Transportation Research. Dresner is immediate past editor of *Research in Transportation Economics* and a former editor of *Transportation Journal*. He sits on the editorial boards of several journals in the transportation, logistics and supply chain fields. Dresner is a former president of the Transportation and Public Utilities Group (TPUG) of the Allied Social Sciences Association, and of the Transportation Research Forum (TRF). He has testified before the U.S. House Aviation Subcommittee, and has worked on consulting projects for a number of organizations, including the Maryland Aviation Administration, the Federal Aviation Administration and the U.S. Department of Energy.

---

**Beijing**

**Monday, 25 July**

**16:20-17:20 (Local Time)**

**Room: International Conference Center**

## **To Transport Million Tons of Stored Coal in Datong by Using Overall Planning Method and Optimization Method**

Lei Ji

*President of the Fourth and Fifth Chinese Society of Optimization, Overall Planning and Economic  
Mathematics*

*Director of the Emergency Management of Specialized Committee in Chinese Society of Optimization, Overall  
Planning and Economic Mathematics*

*Professor and Ph. D supervisor in Institute of Policy and Management, CAS*

Lei Ji, Professor, the President of the Fourth and Fifth Chinese Society of Optimization, Overall Planning and Economic Mathematics, Director of the Emergency Management of Specialized Committee in Chinese Society of Optimization, Overall Planning and Economic Mathematics, Professor and Ph. D supervisor in Institute of Policy and Management, CAS. From 1965 to 1985, he was one of the assistants of Professor Luogeng Hua, a famous mathematician in our country, in the field of application orientation research.

During 1960s, his research interesting includes the theory and applications of Optimization and Overall Planning. In 1980s, he applied Optimization and Overall Planning to decision theory and proposed models and methods of project systems analysis for the state's major projects and development project, which greatly improved the level of decision analysis and decision making. In 1990s, he spent major of his time in Chinese Society of Optimization, Overall Planning and Economic Mathematics and had great contribution to the society.



Recent years, professor Lei Ji led a multi-disciplinary research team to study the applications of the theory on data mining, evaluation, diagnosis, optimization on dynamic resource allocation in industries such as finance, civil aviation, electric power etc.

Since 2003, professor Lei Ji engaged in the research on theory and applications of emergency management. He advocated and organized the Emergency Management of Specialized Committee in Chinese Society of Optimization, Overall Planning and Economic Mathematics. He put forward a new research direction of dynamic game of network technology and published a book emergency management (the book was published in 2006 by Higher Education Publishing House, and was selected as a textbook in the Graduate University of Chinese Academy of Sciences). His research group has done many works on the theory and applications of public safety and safety management. The research topics include emergency management system, emergency plan management, resource allocation and layout, scheduling, and applications of emergency management in practice. Recently, his group devoted themselves to solve the safety problem faced by civil aviation enterprises, developed a theoretic framework, some mathematical models and quantitative analysis methods to analyze the accidents occurring production, accident symptom and unsafe events. These works laid foundation for scientific and effective management of safety production. Their research has been applied gradually in a civil aviation enterprise.



# Conference Organisers

---

## **The Institute of Transport and Logistics Studies in the University of Sydney Business School, the University of Sydney, Australia**



Established in 1850, the University of Sydney is Australia's oldest university, ranked 37th in the world by the QS 2014 World University Ranking. The university has been consistently in the top three universities in Australia, and is one of the country's major research-intensive universities and a member of the prestigious Group of Eight. The respected Times Higher Education lists the university among the top 25 universities in the world for humanities and social sciences, and the top 50 for engineering and technology. In the QS 2014/15 World University Rankings, eight disciplines from the university were ranked among the top 20. With an annual research income close to A\$ 200 million, the university is one of the most well-funded universities in Australia. It has educated more than one-fourth of the Australian prime ministers, 5 Nobel Prize laureates, and leaders in international organizations such as the United Nations and World Bank.

The university hosts more than 30,000 undergraduate students and close to 20,000 postgraduate students. It has worldwide alumni of 270,000, and international students from more than 130 countries. The university has 8

campuses, 16 Faculties and 171 research institutes. With more than 3400 academic staff, the university offers the widest range of academic programs of any Australian university from its school and faculties, including the Agriculture and Environment; Architecture, Design and Planning; Arts and Social Sciences; Business (The University of Sydney Business School); Dentistry; Education and Social Work; Engineering and Information Technologies; Health Sciences; Law (The University of Sydney Law School); Medicine (The University of Sydney Medical School); Nursing and Midwifery (Sydney Nursing School); Pharmacy; Science; Sydney College of the Arts; Sydney Conservatorium of Music; Veterinary Science. Students can join more than 200 clubs and societies, and apply for 286 student exchange programs in more than 30 countries.

The university has built an international reputation for outstanding teaching and research over the past 160 years, and as an active and engaged community leader. Teachers are practising professionals as well as exceptional academics and groundbreaking researchers, and many are leaders in their chosen fields, both nationally and internationally.

Established as the Faculty of Economics in 1920, the University of Sydney Business School (as it became known from January 2011) is the oldest of its kind in Australia. The school has an outstanding reputation for the quality of its research across a wide range of academic disciplines. As of March 2015, the school has a total of 329 academic staff, including 38 full Professors. There are about 3,600 undergraduate students and 4,500 postgraduate students enrolled. Over the past ten years (2005-2014), the business school has obtained over \$39 million in research grants; over 2,500 Department of Education, Employment and Workplace Relations (DEEWR) audited research publications and 11 hosted journals.

In 2013 and 2014, the Business School's Master of Management program ranked in the top five in Asia and in the top 50 in the world in the global rankings published by the highly respected London based newspaper, the Financial Times (FT), confirming the School's position as a world class centre for management education. In 2015, the program jumped eight places (up from 47th in 2014) standing at 39th in the world, and remaining in the top five in Asia and the only Australian MMgt program to appear in the FT's prestigious ranking. Read more. The University of Sydney has been ranked in the top 20 in the world in Accounting and Finance in the 2015 QS World University Rankings by subject. In 2013 and again in 2015, the Australian Financial Review's BOSS Magazine's biennial assessment of management programs ranked the Business School's Executive Master of Business Administration (EMBA) the nation's leading executive education program.

The postgraduate research programs offered by the University of Sydney Business School attract a large number of quality local and international students each year. With over 100 students currently enrolled, the Business School has one of the most high-quality and diverse postgraduate research programs in Australia and the Asia-Pacific region.

The Institute of Transport and Logistics Studies at the University of Sydney Business School is a premier international centre of thought leadership in the crucially linked areas of transport, logistics and supply chain management. It achieved the highest possible rank in research in the most recent national assessment (Excellence in Research for Australia rank 5). ITLS undertakes graduate teaching, management development programs, and research and development in the fields of transport and logistics. It is part of Australia's Key Centre of Excellence in Transport Research and Education, an international collaboration at three nodes: ITLS Sydney; ITS Monash, Melbourne; and ITLS Africa.

---

## Henley Business School, University of Reading



Founded in 1945, by business for business, Henley was the first business school in the UK and is one of the oldest and most respected schools in Europe.

Our impressive full-service portfolio includes a range of undergraduate degrees and Postgraduate degrees in Accountancy, Business, Management, Finance, Real Estate, Planning, Informatics, and Coaching. We offer a world-class DBA and have a dynamic community of PhD students on postgraduate research degrees. Henley has an impressive track record of growing leaders and developing managers to make the right choices for their organisations and for the society they live in which are delivered through our executive education programme, the Henley Partnership and the Henley MBA.

One of the very few business schools worldwide to hold triple-accredited status from the major UK, European and US awarding bodies (AMBA, EQUIS, AACSB), we are also the world's third largest provider of MBA education and home to the world-ranked Henley MBA.

The School represents the largest unit within the University of Reading, rated among the UK's most research-intensive institutions and ranked among the world's top 200 universities (The Times, 2008).

## **Business Informatics, Systems and Accounting**

Business Informatics, Systems and Accounting (BISA) are part of the Henley Business School at the University of Reading. Characterised by its distinctive approach, BISA integrates socio-technical thinking and interdisciplinary expertise in many areas such as information management, business processes and systems, accounting and finance. Taught by world-renowned faculty, the programmes within BISA feature a vibrant mix of industry knowledge and academic excellence.

BISA works closely with top international industry and academic partners to deliver a wide range of undergraduate and postgraduate programmes. Our Partners and customers include Beijing Institute of Technology, Renmin University of China, PwC, CapGemini and Deutsche Telekom. BISA has built an excellent record of knowledge transfer and commercialising research outcomes both locally and internationally.

Research centres, based within BISA, aim to provide interdisciplinary centres of excellence and expertise in specialist areas of informatics and Accounting.

Collaborative research has resulted in contributions in various domains such as enterprise strategy and architecture for competitive advantages, enterprise systems solutions, intelligent and sustainable built environments, and information management in healthcare. BISA boasts a thriving PhD programme in a range of informatics and accounting topics with 30 plus doctoral researchers. BISA leads research and manages partner relationships across the globe to consolidate best practices into teaching programmes for the benefit of course participants and partner organisations.

---

## School of Economics and Management, Beijing Jiaotong University



Beijing Jiaotong University (BJTU, formerly known as Northern Jiaotong University) is a national key university under the direct administration of the Ministry of Education and now is jointly supported by the Ministry of Education, the China Railway Corporation (formerly known as the Ministry of Railways) and Beijing Municipal Government. BJTU is one of the first universities selected into the “National 211 Project” and the “985 Strength Discipline Innovation Platform” project, one of the first institutions authorized to confer master’s and doctoral degrees. BJTU, as the leading organization, has established the Collaborative Innovation Centre for Rail Transit Safety, which is one of the first 14 collaborative centers approved by the Chinese government to enter the “National 2011 Projects”.

As one of the three origins of the Jiaotong University, BJTU grew out of Beijing Railway Management Institute, China’s first higher educational institution which was committed to fostering railway management talents and initiated modern China’s education in railway management and telecommunication. Some renowned people in Chinese history received education at the University, including Liu Han, founder of China’s first radio station, Ying Shangcai, inventor of China’s first high-power steam engine, Zheng Zhenduo, famous writer and literary critic and historian, Jin Shixuan, author of China’s first railway management monograph, Xu Jing, pioneer of railway transport economics in China, and Yang Rumei, one of the early four major accountants in China. Some famous scholars worked at the University, including Xiang Zhejun, Chief Prosecutor of the Tokyo Trial and Ma Yinchu, famous demographer and economist.

BJTU has achieved distinction in offering a range of academic programs thanks to its development in over one hundred years. The university has been closely connected with the nation's railway industry since its establishment. The faculty and students of BJTU have made great contributions to the growth of China's railways, having participated in almost all the major events in different stages of development of the industry, from the movements for protecting railway rights and saving the nation in the 1900s to the great endeavor of building railways after the founding of the People's Republic of China, from the six railway-speed-raising campaigns, the completion of the Qinghai-Tibet Railway and the application of heavy-haul trains on the Datong-Qinhuangdao Railway to the building of high-speed railways and modern urban rail transit systems throughout the country in contemporary times. While improving its unique strengths in such disciplines as traffic and transportation, communication and information, economics and management, BJTU has fostered a strong sense of collaboration and innovation. The university has become an important base to turn out talents, especially outstanding talents in information technology and urban rail transit, for the economic and social development of China. It has also remained an influential institution which can help to solve significant technological and policy-making problems appearing in the development of the country's economy, society and modern transportation systems.

BJTU is located in Beijing, the capital city of China with east and west campuses in Haidian District. It covers a total area of almost 1,000 mu (1 mu approximately equals 667 square meters), and its building area is 920 thousand square meters. The university has also established a new Weihai campus and put it into use in 2015. BJTU accommodates 15 academic schools, 2 vocational colleges and 1 independent college. BJTU has 4,428 faculty and staff members including 1,831 full-time teachers. (Among the full-time teaching staff, 1,156 have senior and associate professional titles) Now the University has 14,173 undergraduate students, 7,842 graduate students, 2,727 doctoral students, 7,867 professional degree students and 8,424 adult students. There are 1,884 short-term and long-term international students in total.

So far, BJTU has 8 national key disciplines. There are 15 post-doc research stations, 21 level-1 disciplines offering doctoral degree programs, 35 level-1 disciplines offering master's degree programs, 13 professional degree programs such as MBA, EMBA, M.Eng, M.Acc, M.Law, etc. The University has 50 research platforms at ministry/provincial level and above, including 10 national level research platforms and 40 ministerial and provincial level research platforms. In recent 5 years, the university supervised nearly 11,000 research projects such as National 973 Plan, National 863 Plan, National Science Fund, National Social Science Fund and other projects established by Ministry of Education, Ministry of Railways and so on. The research fund reached 3.7 billion RMB. BJTU has published 6,675 papers in SCIE citations and 4,381 papers in EI citations. There were 2,108 patent applications and 1,360 approvals.

BJTU has established cooperative relations with over 200 universities and famous multi-national enterprises from more than 40 countries including the United States, the United Kingdom, Germany and France in order to cultivate first-class talents with global vision. The university has established Confucius Institutes with KU Leuven in Belgium, Texas Southern University in the United States and University of Campinas in Brazil. The "Hanergy School of Renewable Energy" has been established with international demonstration effect. Taking Weihai Campus as the platform, BJTU has expanded the scale of Chinese-Foreign Cooperation in Running Schools. In order to actively serve the national "Belt and Road" initiatives and "going global" strategy of high-speed railway, BJTU has established the "International Joint Lab on High-Speed Rail Safety and Operation" with University of Illinois Urbana Champaign, the "Institute of Global Supply Chain and Logistics"

---

with Rotterdam School of Management, Erasmus University, the "China-UK High-speed Railway Research Center" with University of Birmingham, the "Russia-China Jiaotong Institute" with Petersburg State Transport University as well as the "China-Russia High-speed Railway Research Center" with Moscow State University of Railway Engineering and Petersburg State Transport University, among which the cooperation projects with the United States, United Kingdom and Russia have been included in people-to-people communication mechanisms of both sides. BJTU has experienced rapid internationalization development from the first enrollment of Weihai Campus in 2015 to the successful holding of the "China High-level Forum of Transportation" and 2nd "China-Russia Transport University Presidents' Forum".

“Think of the source while drinking the water, love the country and honor the alma mater.” Today, with 120 years of glorious history, Beijing Jiaotong University carries on her mission, following the motto of “Learn and Practice” and the spirit of modesty, caution and innovation, remembering the demand and expectations of the former national leaders, and striding towards the goal of building a world-renowned university with high-level distinction.



# **International Center for Informatics Research, Beijing Jiaotong University**

The International Center for Informatics Research (ICIR) of Beijing Jiaotong University was jointly founded on March 2009 by Beijing Jiaotong University and University of Reading (UK). Taking talent training, scientific research, serving our society and cultural inheritance as the responsibilities, ICIR is established as a respected international teaching and research base, in information technology, logistics management and other related areas, through international cooperation and communication. International partners of ICIR include Liverpool University, UC Berkeley, The Pennsylvania State University, University of Maryland, Universitat Politècnica de Catalunya, BarcelonaTech, Université Paris VI, University of Macau as well as more than ten other famous universities in the world. Domestically, ICIR has established cooperation with many research institutes such as Development Research Center of the State Council, Academy of China, Xinhua News Agency and etc.

The research areas of ICIR target information management and service science and logistics management and logistics engineering in IT environment. The information management and service science includes topics of information industry theories and policies, E-Business and enterprise informatization, smart space and smart city, cloud computing technologies and applications. The logistics management and logistics engineering in IT environment includes topics of logistics economy and policies, design and optimization of regional and industrial logistics systems, internet of things (IoT) technology and logistics informatization, logistics planning and architecture design.

The key members of ICIR are Prof. Zhenji Zhang, Prof. Runtong Zhang, Prof. Shifeng Liu, Prof. Xianliang Shi, Prof. Juliang Zhang, Prof. Yisong Li, Prof. Hongjie Lan, Prof. Dan Chang, Prof. Guowei Hua and others, in total 15 full professors and associate professors from China. Prof. Chelsea (Chip) C. White III, Prof. Gerhard Wascher, Prof. James M. Tien, Prof. Kecheng Liu, Prof. Lida Xu, Prof. Philip C. L. Chen, Prof. Martin Dresner, Prof. T. C. Edwin Cheng, Prof. Therese Libourel, Prof. Vicenc Fernandez Alacon, Prof. Zuojun, Max Shen as well as other more than 10 professors from overseas.

The platforms of research and international collaborations include

- IEEE Technical Committee on Logistics Informatics and Industrial Security Systems
- Sino-EU Doctoral School for Sustainability Engineering
- (Program in Logistics, Information, Management and Service Science)
- Beijing Planning Base of Philosophy and Social Science--
- Beijing Research Base for Logistics and Informatics
- Beijing Key Lab for Logistics Management and Technology
- LISS/IEIS International Conferences
- Over 15 Cooperative SCI/SSCI/EI Journals

Up to now, ICIR has been undertaking over 160 projects, including those supported by EU seventh framework, Critical and Major Program of National Natural Science Foundation of China (NSFC), National High Technology Research and Development Program of China (863 Program), Major State Basic Research Development Program of China (973 Program), National Key Technology Research and Development Program

---

of the Ministry of Science and Technology of China, Major Program of Social Science Foundation of Beijing, with a total grant of over 34 Million CNY (5.5 Million US dollar). In addition, members of ICIR has also published over 600 papers in refereed journals and conferences, such as IEEE Trans. Systems, Man and Cybernetics, IEEE Trans. Fuzzy Systems, International Journal of Production Economics, European Journal of Operations Research, Naval Research Logistics, as well as 10 scientific monographs. ICIR has been granted one Science and Technology Progress Award at national level and two Science and Technology Progress Awards at provincial and ministerial level, two Teaching Achievement Awards at national level and two Teaching Achievement Awards at provincial and ministerial level, two Best Courses Awards and 9 Best Textbook Awards at the national level. There are presently 23 post-doctoral research fellows and 41 Ph.D. candidates at ICIR.

## **China Center for Industrial Security Research**

China Center for Industrial Security Research (CCISR) was founded in Beijing Jiaotong University (BJTU) in November, 2007. It is not only the first but also the only academic institute which specializes in the research on industrial security problems in domestic area. CCISR has achieved leapfrog development in such aspects as education, scientific research, talent cultivation and international cooperation and communication through the joint efforts made by all the staff since its foundation. CCISR aims at building the most authoritative academic institution for industrial security problems; takes the promotion of China's industrial security and development as its own duty; and will unremittingly devote itself to scientific creation, educational research, talent cultivation and international academic cooperation and communication.

In recent years, CCISR values highly on the research of industrial security theory and practice. It publishes series of industrial security and development report according to the development status of the first, the second and the third industries and key industries every year. Meanwhile, CCISR also makes monographic studies on the hot issues and difficult problems in current industrial development under the entrustment by governmental departments, international organizations and enterprises. As a result, it has obtained many provincial and ministerial-level projects and horizontal projects including key tender projects of National Social Science Fund, the significant research projects in the prophase of the 12th Five Year Planning of NDRC, the significant research projects of Ministry of Education, ministerial projects of Ministry of Commerce and the ministerial projects of National Insurance Regulatory Commission.

---

# Workshops

---

---

# Sustainable Container Supply Chain Management

*Monday, 25 July*

*08:00-18:00*

*Room: International Conference Center, Beijing, China*

*Tuesday, 26 July*

*09:00-18:00*

*Room 611, 612, Sidong Building, Beijing, China*

## **Workshop Co-chairs:**

Prof. Zaili Yang, Liverpool John Moores University

Prof. Jin Wang, Liverpool John Moores University

## **SCOPE**

Including but not limited to “Container operation efficiency and traffic optimization”, “Risk management in Container Supply Chains”, “Green logistics modelling Container Supply Chains”, “ICT application in the integration of Container Supply Chains”, “Economic effects modelling and analysis in Container Supply Chains”, “Intermodal logistic management in Container Supply Chains”.

## **TOPIC**

- Hazard Identification and Safety Evaluation
- Container throughput forecasting
- Resilient and sustainable CSC design
- Information systems and application in CSCs
- Optimization and allocation modelling in CSCs

## **TECHNICAL COMMITTEE**

### **Chair:**

Prof. Zaili Yang, Liverpool John Moores University

Prof. Jin Wang, Liverpool John Moores University

### **Members:**

Prof. Zhenji Zhang, School of Economy and Management, Beijing Jiaotong University.

Prof. Runtong Zhang, School of Economy and Management, Beijing Jiaotong University.

Prof. Dong Li, University of Liverpool

Prof. Paul Lee, Victoria University Austrian.

Prof. Qianming Shang, Wuhan University of Technology

Prof. Xinlian Xie, Dalian Maritime University.

Prof. Yuhong Wang, EdinburghNapier University

---

Prof. Dongping Song, School of Management, University of Liverpool

## **ORGANIZATIONAL COMMITTEE**

### **General Chairs**

Prof. Zaili Yang, Liverpool John Moores University

Xianliang Shi, Beijing Jiaotong University, China

### **Program Chairs**

Xiaochun Lu, Beijing Jiaotong University, China

Anqiang Huang, Beijing Jiaotong University, China

### **Secretariat**

Chaoyu Li, Liverpool John Moores University

### **Publication Chairs**

Dan Chang, Beijing Jiaotong University, China

### **Organization Chairs**

Dan Chang, Beijing Jiaotong University, China

# INNOVATION IN CONTAINER SUPPLY CHAIN MANAGEMENT

## EC - China Research Network on Integrated Container Supply Chains

### (ENRICH) Workshop in Beijing

#### Agenda

Date: 24 -26 July 2016

<b>24 July 2016</b>		
Venue: Sidong Building, Beijing Jiaotong University, Beijing 100044		
<b>Time</b>	<b>Activities</b>	
14:30-17:30	Registration	

<b>25 July 2016</b>		
Venue: International Conference Center, Mechanical Engineer Building, Beijing Jiaotong University, Beijing 100044		
<b>Time</b>	<b>Activities</b>	<b>Speaker</b>
08:00-09:00	Arrival and Registration	
09:00-09:30	Conference Opening Sessions	
09:30-10:10	Photo/ Coffee Break	
10:10-11:10	Keynote Speech 13th Five Year Plan of Chinese Management Science and NSFC Management Science	Yijun Li
11:10-12:10	Keynote Speech Development of Global Value Chain and Logistics Industry	Shouyang Wang
12:10-14:00	Lunch	
14:00-15:00	Keynote Speech Resilience and Sustainability of Container Supply Chains - a risk analysis perspective	Zaili Yang
15:00-16:00	Keynote Speech Logistics Considerations in International Trade	Martin Dresner
16:00-16:20	Coffee Break	
16:20-17:20	Keynote Speech To Transport Million Tons of Stored Coal in Datong by Using Overall Planning Method and Optimization Method	Lei Ji
18:00	Reception	

<b>26 July 2016</b>			
Venue: Room 611, Sidong Building, Beijing Jiaotong University, Beijing 100044			
<b>Time</b>	<b>Activities/Papers</b>	<b>Speakers</b>	<b>Chairs</b>
9:00-9:20	Hazard identification in chemical supply chains: the development of a novel taxonomy	Chaoyu Li (LJMU)	Zaili Yang
9:20-9:40	An integrated approach for sustainable container supply chain design and evaluation	Jing Shi (UOL)	Zaili Yang
9:40-10:00	The changing nature of cargo container handling needs information sharing as a key per-formance indicator	Bjorn Jager (MUC)	Zaili Yang
10:00-10:20	Potential solutions to upstream buyer consolidation in the China-Europe container trades	Ning Lin (MUC)	Zaili Yang
10:20-10:40	Coffee Break		
10:40-11:00	Current status and framework of China's inland passenger ship safety system	Shiqi Fan (WUT)	Dong Li
11:00-11:20	Information visualization of AIS data	Chen Chen (WUT)	Dong Li
11:20-11:40	An effective heuristic algorithm to solve tractor-and-trailer transportation scheduling problem with time windows	Lei Xing (DMU)	Dong Li
12:00-13:40	Lunch		
13:40-14:00	Applying interval knowledge to facilitate the seaport container throughput volume forecasting	Anqiang Huang (BJTU)	Bjorn Jager
14:00-14:20	Joint distribution vehicle scheduling optimization considering carbon emission and customer urgency	Lei Xing (DMU)	Bjorn Jager
14:20-14:40	The optimization of delivery vehicle scheduling considering the actual road network factors	Xin Lin (DMU)	Bjorn Jager
14:40-15:00	Analysis of the optimization railway route from Romania to Poland in "One Belt and One Road"	Xiaochun Lu (BJTU)	Bjorn Jager
15:00-15:20	Coffee Break		
15:20-15:40	Research on empty container allocation problem	Ji Tian (BJTU)	Xiaochun Lu
15:40-16:00	Sea-rail combined transport model based on queuing theory	Qiwen Du (BJTU)	Xiaochun Lu
16:00-16:20	Evaluation of supply capacity of food emergency logistics in natural disaster	Xiuxian Huang (BJTU)	Xiaochun Lu
16:20-16:40	Relationship of trade and China's logistics	Mingze Liu (BJTU)	Xiaochun Lu



	capability under “the Belt and Road”		
16:40-17:00	Study on Safety Production Management Improvement of Small and Medium Sized Chemical Enterprises	Yunfang Ma (BJTU)	Xiaochun Lu
18:00	ENRICH all-member dinner		

26 July 2016	
Venue: Room 612, Sidong Building, Beijing Jiaotong University, Beijing 100044	
Time	Activities
15:00-17:00	Steering Committee and Communication Meeting

---

# Transport Economics and Modelling

*Monday, 25 July*

*13:00-15:10*

*Room: Lec Room 1, Sydney Australia*

## **Workshop Co-chairs:**

Xiaowen Fu, Senior Lecturer in Aviation and Maritime

## **SCOPE**

This workshop will cover issues related to transport studies that are based on economic analysis, network modelling, and empirical investigations. Studies analysing business and policy decisions in the transport sector (aviation, maritime, rail and road transport) are welcomed.

## **PRESENTATIONS:**

**Presentation 1:** Impact of HSR on the Chinese airline industry

Dr. Gavin Yang.

School of International Trade and Economics, University of International Business and Economics, China

**Presentation 2:** The Wider Economic Benefits of Air Transport

Prof. Peter Forsyth

Monash University and Southern Cross University, Australia

**Presentation 3:** Inter-modal Terminal Location Choice

Prof. Michael Bell

University of Sydney Business School, Australia

**Presentation 4:** Transit-oriented development in an urban transportation corridor

Prof. ZC Li

Huazhong University of Science and Technology, China

**Presentation 5:** Container Shipping in Northern Sea Route and Impacts on Environment

Dr. Xiaowen Fu

University of Sydney Business School, Australia

# Special Sessions

---

## Intelligent Data Analysis

*Tuesday, 25 July*

*13:40-15:10*

*Room: Lec Room 3, Sydney Australia*

### **Chair:**

Xuedong Gao, University of Science and Technology Beijing, China

### **SCOPE AND TOPICS**

Topics for this special session include, but are not limited to, the following:

High Dimensional Data Analysis

Trend Knowledge Detection

Heterogeneous Network Structure Analysis

Streaming Data Analysis

Automatic Data Mining

### **PRESENTATIONS:**

**Presentation 1:** High-Dimensional Data Clustering for Customers with Duplicate Attribute Values

Prof. Sen Wu

Donglinks School of Economics and Management,

University of Science and Technology Beijing, China

**Presentation 2:** Apriori Algorithm based Product Features Extraction Research for Chinese Reviews

Prof. Guiying Wei

Donglinks School of Economics and Management,

University of Science and Technology Beijing, China

**Presentation 3:** A Course-Oriented Book Recommendation Method Based on Library Classification

Ontology

Dr. Yue Huang

Library of Beijing Language and Culture University, China

**Presentation 4:** Overlapping Trend Detection and Application in Prediction

Dr. Kan Gu

Donglinks School of Economics and Management,

University of Science and Technology Beijing, China

**Presentation 5:** Bidirectional CABOSFV for high dimensional sparse data clustering

Dr. Minghan Yang

Donglinks School of Economics and Management,  
University of Science and Technology Beijing, China

**Presentation 6:** Frequent Patterns Discovery and Analysis Granularity Recognition for Shanghai Composite Index Sequence

Dr. Hailan Chen

Donglinks School of Economics and Management,  
University of Science and Technology Beijing, China

**Presentation 7:** Measuring the Contribution Degree of System and Technological Innovation to the Economic Growth

Dr. Ai Wang

Donglinks School of Economics and Management,  
University of Science and Technology Beijing, China

---

# **Social Event**

---

# Performance by Descendance International

## DESCENDANCE INTERNATIONAL

**COMBILAR with Sheik in Dubai 2007**

**Jose & Earl with local dancers Ghana 2007**

**Perform & Gay with John Dancer 20th Africa 2007**

**Descendance with Flamenco dancers Spain 2007**

**Stephen Varotta, Canada Tours 2004-2008**

**Turilo Jose, Ben Lihuanua 2007**

**INDIGENOUS DIVERSITY**  
Descendance has over fifty dancers from diverse tribes across Australia. They range from NSW to Murrumbidgee, across the Tasmanian, through the Central Desert, Western Australia, up to Cape York, and around the Torres Strait Islands. Descendance cultural program is inclusive to Far North Queensland. Descendance today is helping create work for many other Aboriginal artists in areas outside dance, from modelling, painting and popular music, to writing and acting. Descendance has grown out of necessity for indigenous people of Australia, and has become a refuge for Aboriginal culture rearing assistance. Descendance fills Australia's need for a wholesome, exciting and world class traditional and contemporary performing Aboriginal and Torres Strait Islander Dance Company. Today Descendance is providing Australia and the world with some of the finest in traditional and contemporary indigenous culture and music.

**FUSIONS**  
Descendance along with world music artists, Jose Calacero have begun a new genre of contemporary indigenous performance. This fusion style has never been undertaken by an Aboriginal company before, exciting cross cultural work with other cultures in both dance and live music, including Flamenco, Indian, Middle Eastern, Indian American, South American, Asian, Eastern European and African, these cultural exchanges have been invaluable learning experiences for Descendance which has broadened our vision and outlook on life.

**onstage entertainment**

## FLAMENCO in DREAMING

**COMPANY ARTISTS**

Scott Chubbarts	Johnny Marston	George Dow	John Owens	Archie Teason
Nicole Willis	Jason Searle	Peter Williams	Justin Parsons	Darren Compton
Ronnie Calacero	Oliver Drummond	Wayne Langlois	Jacob Dow	Mayra Mc Beatty
Arthur Tait/Johnny	Spide Decker	Kathie Wilks	Leslie Inoué	Wing Ho Shady
Corvinka Wyle	Lucy Williams	Simon Cook	Heathie Thorge	Francis Williams
Union Anderson	Raymond Pitt	Barbara Drummond	Jai Pitt	Justin Tarney
Heather Doonan	Tricki Mia Lala	Debra Butler	Phil Cook	Jason Jay
Renewing Carroll	Nancy Drummond	Pauline Preece	Wayne Kozacz	Darren Bond
Candy Drummond	Stephen Saker	Yvonne Harrison	Nakona Dance	
Earl Isaac	Yvonne Saker	Matt Lang	Taziana Smith	
Albert David	Theresa Pook	Peter Marcell	Phil Smith	
Beathie Saker	Jackie Thakaly	Juanito Fabila	Daniel Brown	

Artistic Director and creator of Flamenco Dreaming Jose Calacero present's his multi-cultural traditional & contemporary dance spectacular "Flamenco Dreaming" exploring hybrid themes & breathtaking fusions. A maestroform of live electric instruments blended with the timeless sounds of the didgeridoo drive the show into a spiritual, high energy & entertaining dance experience never seen before.

The story tells the tale of creation and the tree of life, exploring the roots of dance and expression, in a synergistic collision of art forms, as Indigenous, Flamenco, & Indian dancers explode onto the stage as the past present and the future become one, for all cultures are truly branches of the same tree. Descendance promises new and compelling work as it pioneers in the field of cross-cultural experiences. Descendance captures the essence & emotion of each culture & presents it in a modern overview.

Jose was at the front of the world music & dance movement in the nineties heading four International Dance Companies, including the Antonio Vargas Flamenco Dance Theatre, Flamenco Dreaming, Nguru Aboriginal & Islander Dance Co. and now his most celebrated success Descendance Aboriginal and Torres Strait Islander Dance Theatre.

## Descendance Aboriginal & Torres Strait Islander Dance Theatre

TRADITIONAL & CONTEMPORARY PERFORMANCE

**Toured Over 30 Countries**

**Winner 2004 World Dance and Peace Prize at the World Culture Open (Korea) UNESCO**

**Didgeridoo Players, Dancers, Musicians, Choreographers, Singers, Elders, Painters, Models, Indigenous goods.**

## History of Descendance

The Descendance Aboriginal and Torres Strait Islander Dance Theatre was born from the mighty Nguru Aboriginal Dance Company. Sydney's first professional independent traditional Aboriginal and Torres Strait Islander Dance troupe established in 1983. Nguru means "shaka a leg", a dance style prevalent in the Cape York Peninsula in Far North Queensland.

Nguru had been one of the largest touring professional performing Aboriginal dance troupes in Australia in 2000 the name was changed to "Descendance" to account for the many artists from diverse tribes living in Sydney and joining the company. The motto was "One people all fighting a common cause".

Scott Chubbarts originally formed Nguru in Sydney in 1983. Scott was born in Ipswich in North Queensland and has a background from three Aboriginal tribes, Gimmia from Bully (Bully's side) Kulkadjan from Mount Isa (mother's side) and Kulkupjany from Cooktown (grandfather's side). In 1980 Nguru came under the guidance of the late, great Aboriginal song woman Imelda Willis, and world music pioneer and producer Jose Calacero. Imelda came down from the sleepy coastal Aboriginal mission of Maraboon in the North Queensland on the invitation of Scott Chubbarts. Imelda took on cultural duties for twelve months before her untimely death in 1999 (may she rest in peace). Imelda had just completed a six month season of traditional dance and song at Ayers Rock (Uluru) before finishing her career in Sydney.

Imelda was a gifted pianist and enhanced the Descendance repertoire with some of her original works to encourage indigenous youths living in the city to make something of their lives. Imelda's heritage came from two tribes (Maraboon/Cape York) and (Kulkupjany). Descendance was born out of her legacy to create an independent vehicle and indigenous agency for artists without support or funding. Today her daughter Nicole Willis assumes her legacy.

**INDIGENOUS AWARDS IN TOURISM ALICE SPRINGS**  
The demand for Descendance around the world and throughout Australia saw it evolve into two companies. One is based in Sydney, and one permanent group living and performing nightly shows in Alice Springs (Central Australia) at the Heavitree Resort. The Alice Springs "Red Centre Dreaming Experience" has been running since 2000 attracting thousands of visitors from all over the world. In 2003 Descendance were presented with a Bronze award in tourism for their outstanding performances and cultural input in Alice Springs, the performances in Alice Springs are done with the consent of the Anangu tribe the traditional land owners of the area.

**WORLD TITLE IN KOREA 2004**  
In Sept 2004 Descendance was to claim their ultimate prize on the international stage when they represented Australia at the first cultural style (Kulchura) in Seoul Korea. The event was titled as "The World Culture Open", from 70 countries who entered the competition, Descendance took out the World Dance/Peace Prize, the event was organized by UNESCO.

**INTERNATIONAL TOURING**  
Descendance has also completed hundreds of shows across Europe, Asia, Africa and The Americas, opening up work opportunities in over thirty countries performing at the world's biggest festivals and events, countries include 1,USA, Hawaii, Orlando, Miami, Los Angeles, San Francisco, New York, Baltimore 2,Canada, Toronto, Ottawa, Alberta, Vancouver) 3,Korea, 4,Germany, 5,England, 6,Hungary, 7,Singapore, 8,Brazil, 9,New Zealand 10,Chile 11,Hong Kong 12,France 13,Australia Islands, 13,Australia, 14,Dubai, 15,Spain, 16,South Africa, 17,Africa, 18,Belarus, 19,Poland, 20,Italy 21,1,Spain 22,Denmark 23,Croatia 24,Serbia 25,Indonesia 26,Italy 27,Scotland, 28,Ireland 29,Sweden, 30,Denmark, 31,Norway, 32,Thailand 33,Malaysia, 34,China 35,Japan 36,Victoria Descendance has been one of Australia's most travelled Dance Companies in recent times, indigenous or non indigenous.

## MAJOR EVENTS

Descendance has participated in major world events including the Sydney Olympics in 2000, the opening ceremony of the Rugby Union World Cup in 2003, the Soccer World Cup in Germany 2006; they headlined the United Nations Indigenous Forum in New York City in 2006, and the International Indigenous Forum in Paris (France) 2006. Since the year 2000, Descendance has participated in many of the major international conventions and corporate events held in Australia and around the world, performing for politicians and international dignitaries in the fields of medicine, technology, science, education, humanities, Arts and other diverse practices.

**CLIENT BASE**  
Descendance has worked with some of the world's leading organizations and clients including Aurora Resorts, United Nations, Hawaiian Airlines, P & O Cruises, Qantas, Virgin Airlines, Jetway International, Seoul City Government, Air New Zealand, Ethad Airlines, Korean Air, Australian Grand Prix, Disneyworld Florida, South Corp Wines, Tourism Australia, DFAT, Australian Rugby Union, AMP Australia Council, Canada Council, Aboriginal Tourism Australia, Channel Seven, Samsung, Australian Government, International Aids Society, BMW, SOCOG, Richard Pratt, David Suzuki, Queens Jubilee Organization, Amnesty International, Greenpeace, International Indigenous Funders, Moscow Circus, Sydney Casino, Northern Territory Tourist Commission, Sydney Opera House, Australia, Discovery Channel, many of the major live star festivals, and the world's leading Event Management companies. In 2005 they became the first indigenous company to become a finalist at The Sydney Business Awards.

**CELEBRITY PERFORMANCES**  
Descendance have also worked internationally and across Australia in movies, documentaries, theatre, TV, radio, community work, cultural centres, world's leading festivals, recording projects, education institutions, jails, and countless political events. Descendance have accumulated a distinguished resume of live performances, and have been invited to perform for international celebrities such as The Dalai Lama, Her Majesty Queen Elizabeth II, Nicole Kidman, Mel Gibson, Janet Jackson, Desiree, Jimmy Cliff, Cate Blanchett, Bruce Willis, Arnold Schwarzenegger, Geoffrey Rush, Sylvester Stallone, Olivia Newton John, Steve Irwin, Keith Urban, The Dixie Chicks, Julio Iglesias, Justin Timberlake, The Black Eyed Peas, Delta Goodram, Jennifer Hawkins (Miss Universe) Ian Thorpe and Johnny Knoxville and the Jacksons team. They have also given private performances for many of the world's leading overseas dance companies, ranging from Cuba to Brazil, and Spain to Africa. Descendance starred in Australia's first full-length laser movie "Reef Dreaming", which was shown at Cockle Bay in Darling Harbour Sydney for three years on a screen of jet-propelled water, producing giant hologram Aboriginal images with laser effects. "Reef Dreaming" went on to be watched by almost a million locals and tourists. A documentary by the Discovery Channel titled "Atlas Australia" screened in a record breaking 170 countries and featured Descendance with narration by Russell Crowe. Descendance is also a member of the International Dance Council in Greece.

**BOOK NOW FOR**

Corporate Functions , Conventions , Film , Recordings , Special Events , Schools , Government institutions , Touring Local and International , Radio , Theatre , Museums , Art Galleries , Opening Ceremonies , Festivals.

## DESCENDANCE INTERNATIONAL

United Nations New York 2006

Indigenous Forum Paris France 2006

In Russia 2005

Reunion Islands 2005

Honolulu Festival 2005 - 2008

LA performing for Nicole Kidman 2005

Descendance in Disneyland Florida 2003 - 2006

World Cup Soccer Germany 2006

New Zealand Tours 2005 - 2008

In Hungary 2003 - 2006

London 2004

Cultural Olympic winners Seoul 2004

---

# General Information

---



# General Information

## Registration

**Sydney Venue (Local Time):** 13:30-16:00, Sunday, 24 July (Early Registration)

08:30-10:30 Monday, 25 July (Registration)

**Location:** Level 17, University of Sydney Business School CBD Campus

**China Venue (Local Time):** 14:30-17:30, Sunday 24 July (Early Registration)

08:00-09:00, Monday, 25 July (Registration)

**Location:** Sidong Building Lobby, Beijing Jiaotong University

## Opening Session

**Sydney (Local Time):** 09:00-09:30, Monday, 25 July

Location: Lec Room 1, University of Sydney Business School CBD Campus

**China (Local Time):** 09:00-09:30, Monday, 25 July

Location: International Conference Center, Beijing Jiaotong University

## Meals

Coffee-breaks will be served

### Sydney Venue

Lunch will be served from 12:50 to 13:40 on 25 July

Lunch will be served from 12:20 to 13:20 on 26 July

Dinner will be served from 17:00 to 18:00 on 25 July

Dinner will be served at 18:00 on 26 July

### China Venue

Lunch will be served from 12:30 to 14:00 on 25 July

Lunch will be served from 12:00 to 13:00 on 26 July

Dinner will be served at 18:00 on 25 July

Dinner will be served at 17:30 on 26 July

## Social Activities

Performance by Descendance International at Banquet for participants in Sydney

---

# Rooms Layout

---

## Sydney Venue

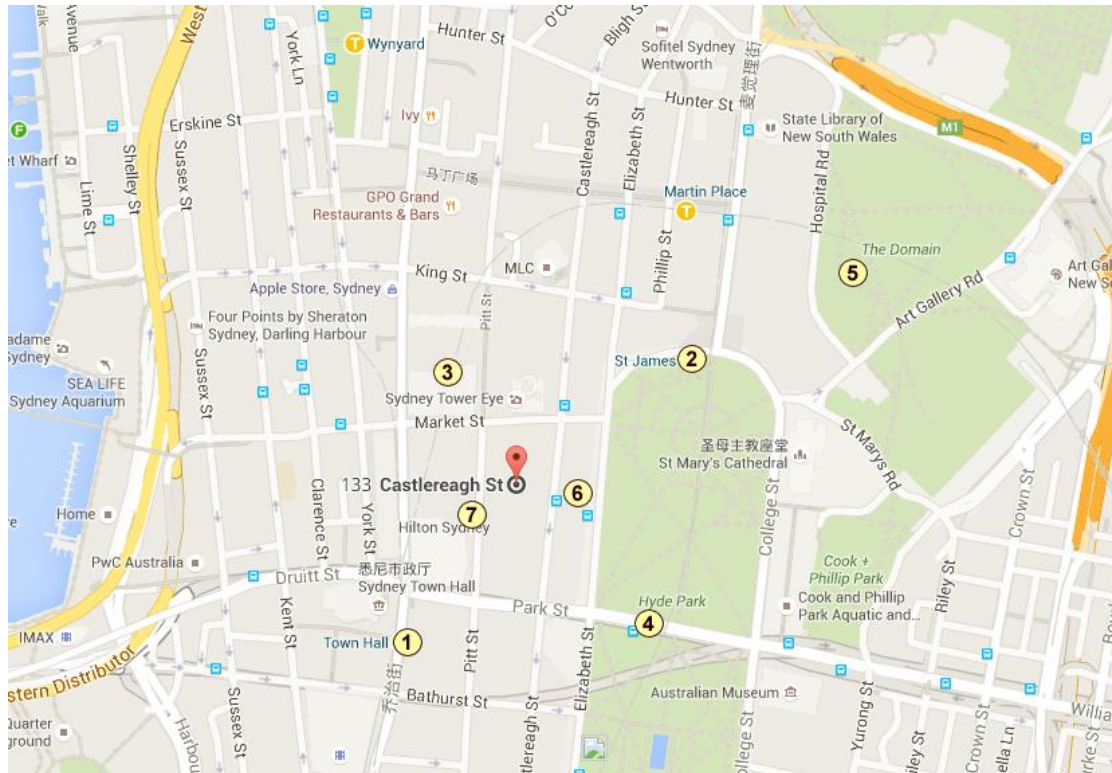

The venue is located at 133 Castlereagh St, the place is in the mid-town precinct of the Sydney CBD and within close proximity to Town Hall and St James train Stations, Pitt Street Plaza, Hyde Park plus the Sheraton on The Park and Hilton Hotels.

AMENITIES	WALKING TIMES
1. Town Hall Station	6 minutes
2. St James Station	5 minutes
3. Pitt Street Plaza	5 minutes
4. Hyde Park	4 minutes
5. The Domain	10 minutes
6. Sheraton on The Park	3 minutes
7. Hilton Hotel	5 minutes

Rooms Layout

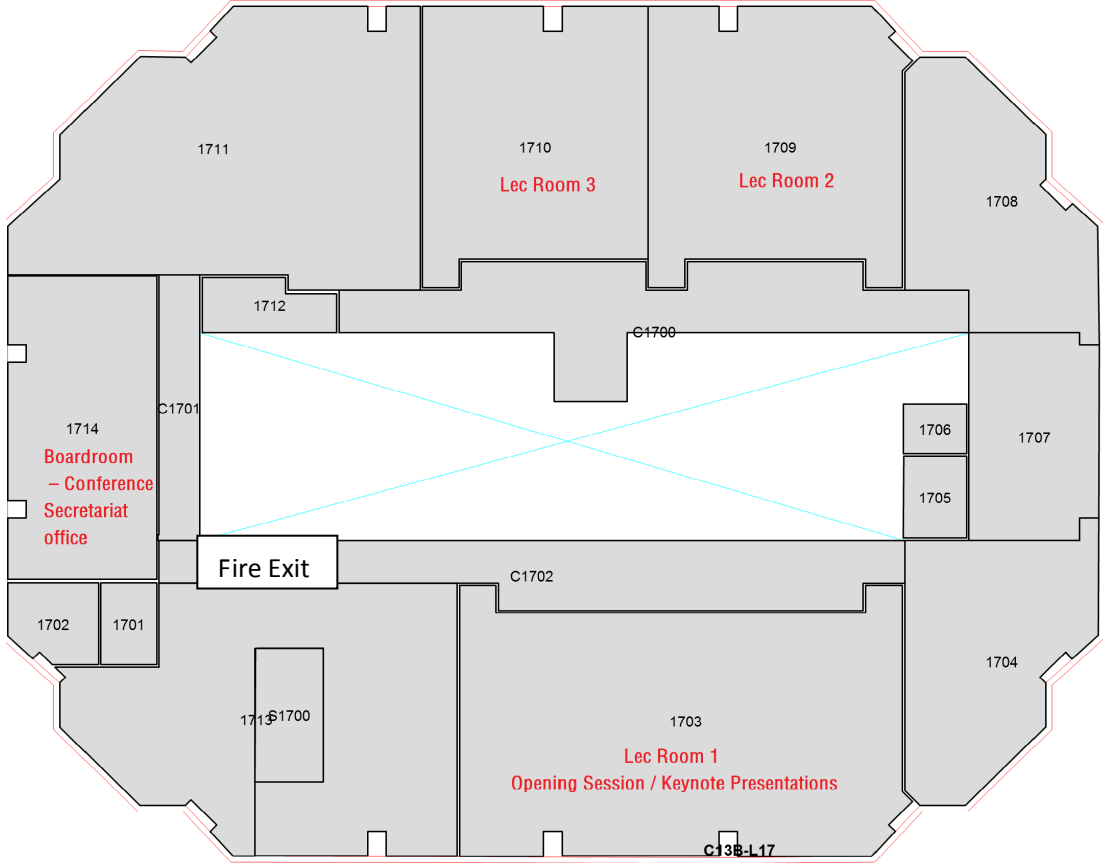

The conference avenue is on the 17th floor.

Level 17 Delegates arrive and register

1703 – Lec Room 1 – Opening Session / Keynote Presentations

1709 – Lec Room 2

1710 – Lec Room 3

1714 – Boardroom – Conference Secretariat Office

1703 – Lec Room 1 – Workshop

## China Venue

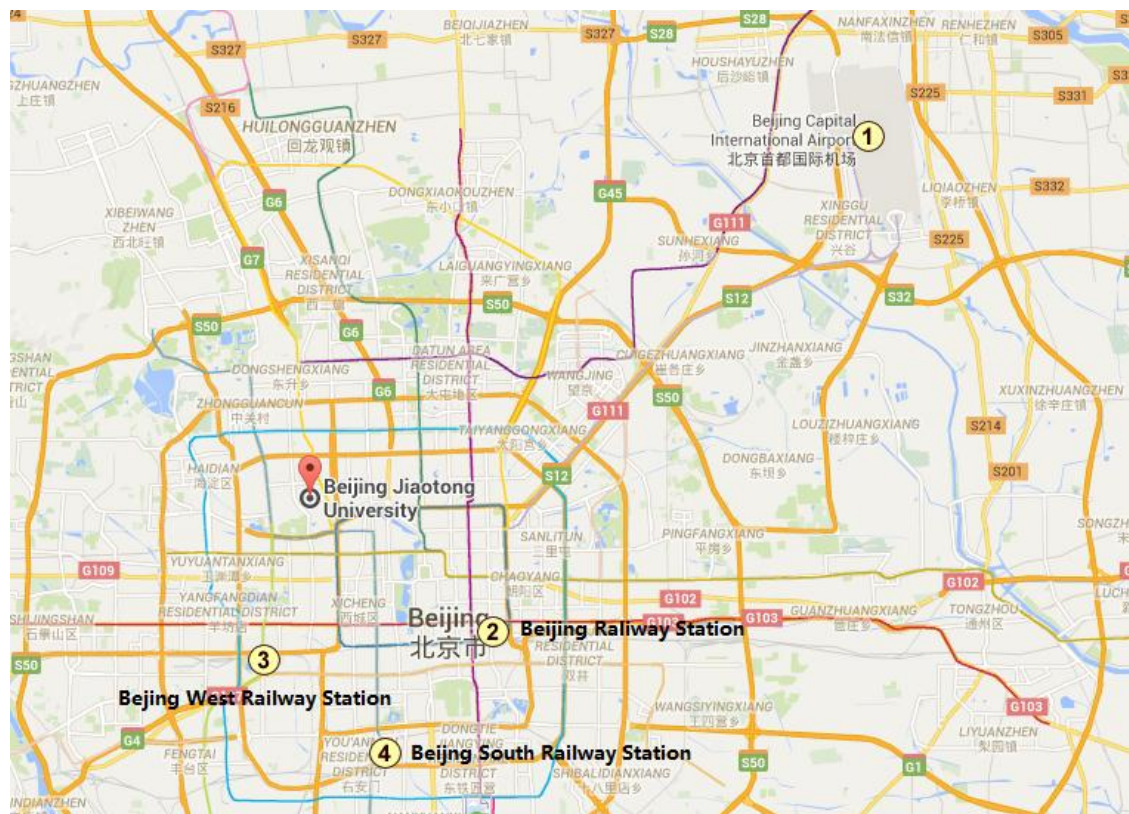

After you arrive in Beijing, you can choose the following way to the meeting place:

- **1. Beijing Capital International Airport**
  - To take the airport express rail (¥25) to Dongzhimen, MTR 2nd line (¥4) to Xizhimen, bus No. 16 in road / express No. 105 (¥2) to Beijing Jiaotong University Station, arrived at **the South Gate of Beijing Jiaotong University**.
  - To take a train to Princess Fen airport bus (¥16), Beijing Friendship Hotel station to get off, walk to the four-way east bus station take the bus No. 26 (¥2) Daliushu station to get off, arrived at **the west gate of Beijing Jiaotong University**.
  - To take a taxi (about ¥100) to get off **the South Gate of Beijing Jiaotong University**, then enter the campus and arrive at the venue.
- **2. Beijing Railway Station**
  - To get out of the station and take the Subway No. 2 line (¥4) to Xizhimen Station after getting off the bus, came out from the mouth of a take bus No. 16 in road / express 105 road to Beijing Jiaotong University Station and get off (¥2), arrived at **the South Gate of Beijing Jiaotong University**.

- Get out of the station and take a taxi (about ¥45) to get off **the South Gate of Beijing Jiaotong University**, then enter the campus and arrive at the venue.

● **3. Beijing West Railway Station**

- To the station take Metro Line 9 to the National Library, the MTR line 4 to Xizhimen Station (¥3, the subway transfer no additional charge), take the bus No. 16 in road / express 105 road to Beijing Jiaotong University Station and get off (¥2) from a port, arrived at **the South Gate of Beijing Jiaotong University**.

- Get out of the station and take a taxi (about ¥30) to get off **the South Gate of Beijing Jiaotong University**, then enter the campus and arrive at the venue.

● **4. Beijing South Railway Station**

- To get out of the station and take the Metro Line 4 to Xizhimen Station (¥4), take the bus No. 16 in road / express 105 road to Beijing Jiaotong University Station and get off (¥2) from a port, arrived at **the South Gate of Beijing Jiaotong University**.

- Get out of the station and take a taxi (about ¥40) to get off **the South Gate of Beijing Jiaotong University**, then enter the campus and arrive at the venue.

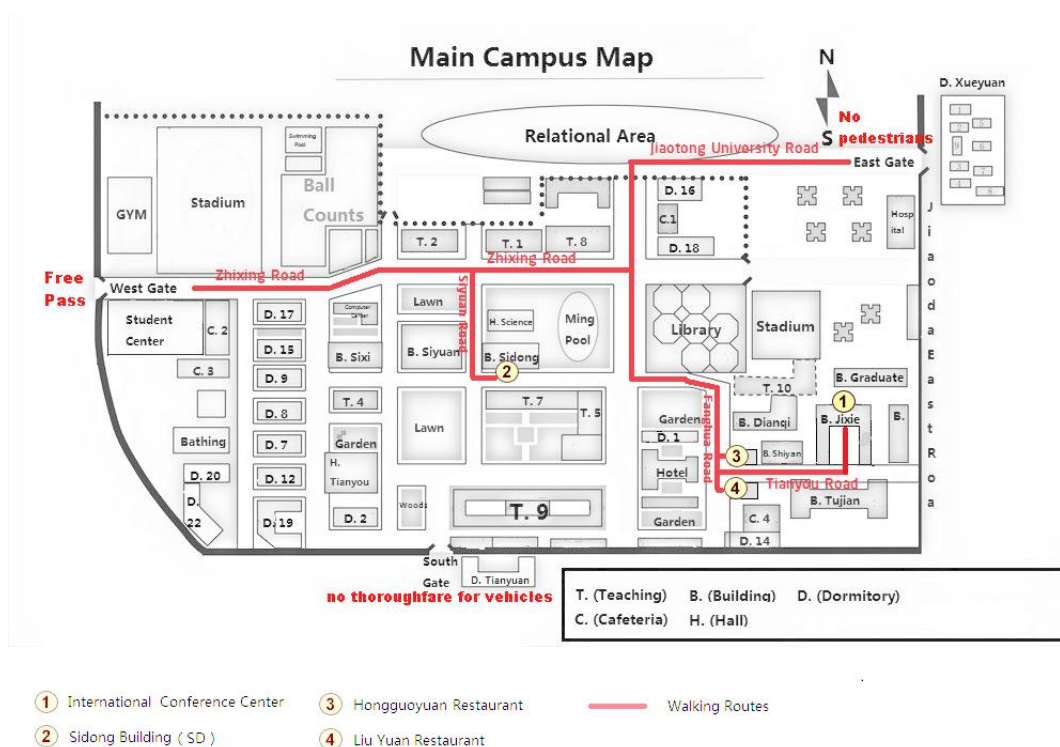

Main Conference Room: International Conference Center

Session Conference Rooms: Sidong Building (SD)

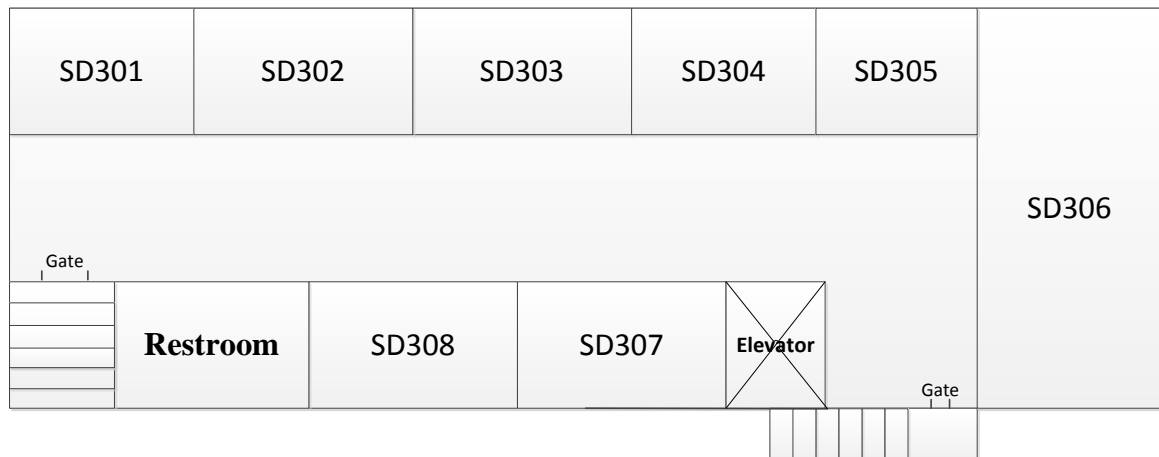

SD302, SD 303, SD 304, SD 308: Session Rooms

SD 611, SD 612: Workshop Rooms

SD306: 2016 Doctoral International Summer School for Modern Logistics Management

SD307: 2<sup>nd</sup> Summer School of Sino-EU Doctoral School for Logistics, Information, Management, and Service Science

---

# Program Layout

---



## Sydney Venue (Local Time)

From	To		Location	Chair
<b>24 July</b>				
13:30	16:00	Registration	Level 17	
<b>25 July</b>				
08:30	09:00	Registration	Level 17	
09:00	09:30	Conference opening session	Lec Room 1	Xiaowen Fu
09:30	10:15	The Sputnik of Servgoods: Autonomous Vehicles James M. Tien	Lec Room 1	Runtong Zhang
10:15	10:35	Photo/Coffee Break	Level 17	
10:35	11:20	Effects of Air Transport Liberalization on Foreign Traffic Inflow and Service Export and Import Trades Tae Hoon OUM	Lec Room 1	James M. Tien
11:20	12:05	Order picking - A critical function in supply chain management Gerhard W äscher	Lec Room 1	Tae Hoon OUM
12:05	12:50	Deep Learning Applications in Traffic and Transportation C. L. Philip Chen	Lec Room 1	Gerhard W äscher
12:50	13:40	Lunch	Level 17	
13:40	15:10	Parallel Sessions	Lec Room 3	
15:10	15:30	Coffee Break	Level 17	
15:30	17:00	Parallel Sessions	Lec Room 3	
17:00	18:00	Welcome Cocktail Event	Level 17	
<b>26 July</b>				
09:00	10:30	Parallel Sessions	Lec Room 3	
10:30	10:50	Coffee Break	Level 17	
10:50	12:20	Parallel Sessions	Lec Room 3	
12:20	13:20	Lunch	Level 17	
13:20	14:50	Parallel Sessions	Lec Room 3	
14:50	15:10	Coffee Break	Level 17	
15:10	16:40	Parallel Sessions	Lec Room 3	

Program Layout

18:00	19:00	Performance by Descendance International	L'Aqua	
19:00		Banquet	L'Aqua	
<b>27 July</b>				
09:00	10:30	Parallel Sessions	Lec Room 3	
10:30	10:50	Coffee Break	Level 17	
10:50	12:20	Parallel Sessions	Lec Room 3	
12:20	13:20	Lunch	Level 17	
13:20	14:50	Parallel Sessions	Lec Room 3	
14:50	15:10	Coffee Break	Level 17	
15:10	16:40	Parallel Sessions	Lec Room 3	

Banquet Restaurant: L'Aqua (The Gold room)

Address: Roof Top Level, Cockle Bay Wharf, Darling Park NSW 2000

Map: <http://docksidegroup.com.au/venues/laqua#tab=Location>

## Presentation Details of Parallel Sessions

Date	25-Jul		26-Jul				27-Jul			
Time	13:40- 15:10	15:30- 17:00	09:00- 10:30	10:50- 12:20	13:20- 14:50	15:10- 16:40	09:00- 10:30	10:50- 12:20	13:20- 14:50	15:10- 16:40
Lec Room 3	IDA	IM6	LM9	LM10	SM4	LM13	LM14	LM15	SM5	SM6

IDA: Intelligent Data Analysis

IM6: Information Management 6

LM9: Logistics Management 9

LM10: Logistics Management 10

LM13: Logistics Management 13

LM14: Logistics Management 14

LM15: Logistics Management 15

SM4: Service Management 4

SM5: Service Management 5

SM6: Service Management 6

TEM: Transport Economics and Modelling

## China Venue (Local Time)

From	To		Location	Chair
<b>24 July</b>				
14:30	17:30	Registration	Sidong Building <i>Lobby</i>	
<b>25 July</b>				
08:00	09:00	Registration	International Conference Center <i>Multi-Function Room</i>	
09:00	09:30	Conference Opening Sessions	International Conference Center	Prof. Zhongliang Guan, General Chair
09:30	10:10	Photo/ Coffee Break	International Conference Center	
10:10	11:10	Management Science in China and The 13th Five-year Plan for Management Science of NSFC Yijun Li	International Conference Center	Prof. Xianliang Shi
11:10	12:10	Global Value Chain and the Development In Logistics Industrial Shouyang Wang	International Conference Center	Prof. Xianliang Shi
12:30	14:00	Lunch	Hongguoyuan Restaurant/Liuyuan Restaurant	
14:00	15:00	Resilience and Sustainability of Container Supply Chains - a risk analysis perspective Zaili Yang	International Conference Center	Prof. Martin Dresner
15:00	16:00	Logistics Considerations in International Trade Martin Dresner	International Conference Center	Prof. Zaili Yang
16:00	16:20	Coffee Break	International Conference Center	
16:20	17:20	To Transport Million Tons of Stored Coal in Datong by Using Overall Planning Method and Optimization Method Lei Ji	International Conference Center	Prof. Zaili Yang
18:00		Reception	Hongguoyuan Restaurant/ Liuyuan Restaurant	
<b>26 July</b>				
08:00	09:50	Parallel Sessions	SD303-304,308	
09:50	10:10	Coffee Break	Third Floor	
10:10	12:00	Parallel Sessions	SD303-304,308	
12:00	13:00	Lunch	Hongguoyuan Restaurant/ Liuyuan Restaurant	
13:00	14:50	Parallel Sessions	SD303-304,308	
14:50	15:10	Coffee Break	Third Floor	
15:10	17:00	Parallel Sessions	SD303-304,308	
17:30		Banquet	Hongguoyuan Restaurant/ Liuyuan Restaurant	

27 July				
08:00	09:50	Parallel Sessions	SD303-304,308	
09:50	10:10	Coffee Break	Third Floor	
10:10	12:00	Parallel Sessions	SD303-304,308	
12:00	13:00	Lunch	Hongguoyuan Restaurant/ Liuyuan Restaurant	
13:00	14:50	Parallel Sessions	SD303-304,308	
14:50	15:10	Coffee Break	Third Floor	
15:10	17:00	Parallel Sessions	SD303-304,308	

## Presentation Details of Parallel Sessions

Date	26-Jul				27-Jul			
Time	08:00-09:50	10:10-12:00	13:00-14:50	15:10-17:00	08:00-09:50	10:10-12:00	13:00-14:50	15:10-17:00
SD303	EM1	IM1	IM4	LM3	LM6	SM1	IM7	IM10
SD304	EM2	IM2	LM1	LM4	LM7	SM2	IM8	LM11
SD308	EM3	IM3	LM2	LM5	LM8	SM3	IM9	LM12

- EM1: Engineering Management 1
- EM2: Engineering Management 2
- EM3: Engineering Management 3
- IM1: Information Management 1
- IM2: Information Management 2
- IM3: Information Management 3
- IM4: Information Management 4
- IM7: Information Management 7
- IM8: Information Management 8
- IM9: Information Management 9
- IM10: Information Management 10
- LM1: Logistics Management 1
- LM2: Logistics Management 2
- LM3: Logistics Management 3
- LM4: Logistics Management 4
- LM5: Logistics Management 5
- LM6: Logistics Management 6
- LM7: Logistics Management 7
- LM8: Logistics Management 8
- LM11: Logistics Management 11
- LM12: Logistics Management 12
- SM1: Service Management 1
- SM2: Service Management 2
- SM3: Service Management 3

---

# Final Program

---

---

# Contents



## Sydney Venue (Local Time)

### 25 July Sessions

**Conference opening session (09:00 - 09:30)**

**Chair: Xiaowen Fu**

**Room: Lec Room 1**

**Plenary Session 1 (9:30 - 10:15)**

**Title: The Sputnik of Servgoods: Autonomous Vehicles**

**Speaker: *James M. Tien***

**Chair: Runtong Zhang**

**Room: Lec Room 1**

**Photo (10:15-10:35)**

**Location: Lec 17**

**Plenary Session 2 (10:35 - 11:20)**

**Title: Effects of Air Transport Liberalization on Foreign Traffic Inflow and Service Export and Import Trades**

**Speaker: *Tae Hoon OUM***

**Chair: James M. Tien**

**Room: Lec Room 1**

**Plenary Session 3 (11:20 - 12:05)**

**Title: Order picking – A critical function in supply chain management**

**Speaker: *Gerhard Wäscher***

**Chair: Tae Hoon OUM**

**Room: Lec Room 1**

**Plenary Session 4 (12:05 - 12:50)**

**Title: Deep Learning Applications in Traffic and Transportation**

**Speaker: *C. L. Philip Chen***

**Chair: Gerhard Wäscher**

**Room: Lec Room 1**

## Parallel Sessions (13:40-15:10)

**Room: Lec Room 3**

**IDA: Intelligent Data Analysis**

**Chair: Xuedong Gao**

- LISS2016\_95: Measuring the Contribution Degree of System and Technological Innovation to the Economic Growth  
(*Xiao Wang, Ai Wang, Xuedong Gao*)
- LISS2016\_194: A Course-Oriented Book Recommendation Method Based on Library Classification Ontology  
(*Yue Huang*)
- LISS2016\_253: High-Dimensional Data Clustering for Customers with Duplicate Attribute Values  
(*Sen Wu, Liwei Fu*)
- LISS2016\_296: Bidirectional CABOSFV for high dimensional sparse data clustering  
(*Xuedong Gao, Minghan Yang, Ling Li*)
- LISS2016\_301: Research on Product Feature Extraction for Chinese Reviews  
(*Gui-ying Wei, Wen-ming Cai, Lan Qin*)
- LISS2016\_329: Overlapping Trend Detection and Application in Prediction  
(*Xuedong Gao, Kan Gu, Danyue Wang*)
- LISS2016\_343: Frequent Patterns Discovery and Analysis Granularity Recognition for Shanghai Composite Index Sequence  
(*Xuedong Gao, Hailan Chen*)

## Parallel Sessions (15:30-17:00)

**Room: Lec Room 3**

**IM6: Information Management6**

**Chair: Jianbin Chen**

- LISS2016\_152: Node Importance Evaluation of World City Networks: A Survey  
(*Shan Xue, Li Xiong, Lu Zhao*)
- LISS2016\_361: Subsequence Pattern Discovery in Chinese University Financial Data  
(*Yixuan Ma, Zhenji Zhang*)
- LISS2016\_349: Dynamic Online Consumer Trust Forming Mechanism Research based on Beijing, China  
(*Qianqian Zhang, Honglu Liu, Shifeng Liu, Zhihong Tian*)
- LISS2016\_210: The Impact of ICT Costs on US Trade in Education  
(*Christina Tay*)
- LISS2016\_145: Order Promising Model With Random Demand And Supply  
(*Wen Yang, Jianhua Ma, Yanchun Pan*)
- LISS2016\_116: Fuzzy Evaluation Modeled Risk Assessment of Colleges and Universities' Sci-tech Innovation  
(*Zhe Zhang, Zhongliang Guan*)
- LISS2016\_373: Research on the Theory and Application of IOII in China  
(*Kun Zhang, Zhenji Zhang*)
- LISS2016\_263: Game Analysis on the Lower Bound of Optimal Interval of Knowledge Heterogeneity in Virtual Practice Community

- (*Jing Liu, Yanyang Ma, Yanli Guo, Jianbin Chen*)
- LISS2016\_411: Declarative Modeling Cases of Cyber Physical Systems  
(*Wei Ding, William Engel, Andre Goode, Giovanni Santostasi*)

## 26 July Sessions

### Parallel Sessions (09:00-10:30)

**Room: Lec Room 3**

**LM9: Logistics Management9**

**Chair: Shouting Zhao**

- LISS2016\_368: Optimal Reorder Decision-Making Under the Uncertain Production Cost  
(*Shouting Zhao*)
- LISS2016\_254: Revenue-sharing Contract for supply chain under a Cap and Trade system  
(*Jianfeng Yuan, Jianhua Ma, Wen Yang*)
- LISS2016\_331: Production Strategy with Substitution Under Cap-and-Trade Regulation  
(*Hua He, Changsong Ma, Zhenyu Luo, Hang Yu*)
- LISS2016\_207: Siting Public Charge Stations for Taxis in Beijing Based on Monte Carlo Simulation  
(*Zhenwei Wang, Xiaomin Zhu, Qian Pu*)
- LISS2016\_127: New Products Advance Selling Considering Strategic Customers  
(*Mingyang Zhang*)
- LISS2016\_333: Pricing Decisions of Two Products with Carbon Emissions Trading and Green Technology Investment  
(*Xiangchao Liu, Changsong Ma, Hua He, Hongmei Zhang*)

### Parallel Sessions (10:50-12:20)

**Room: Lec Room 3**

**LM10: Logistics Management10**

**Chair: Haitao Wen**

- LISS2016\_342: Production and Pricing Policy of ATO Manufacturer with Heterogeneous Customer Segment and Demand  
(*Yuyu Li, Hui Huang, Bo Huang*)
- LISS2016\_322: Matching the Supply of and Demand for Logistics Talent: an Investigation in Northeast of China  
(*Haitao Wen, Huasha Wu, Xing Wang*)
- LISS2016\_58: Supply Chain Coordination under Information Asymmetry Considering Customer's Service Free-riding Behavior  
(*Can Liu, Bin Dan, Maosen Zhou, Xumei Zhang*)
- LISS2016\_286: Pricing for Perishable Goods in Advance Selling Strategy  
(*Xing Wang, Bofeng Yu, Haitao Wen, Yan Li, Shuzhi Zhao*)
- LISS2016\_425: Optimal Inventory Policy for Perishable Products without Replenishment

*(Hengyu Liu, Yihong Ru)*

- LISS2016\_37: Seasonal Product Pricing Under RFID Application Environment  
*(Wenjie Wang, Qi Xu, Changchun Gao, Weiwei Ma)*

### **Parallel Sessions (13:20-14:50)**

**Room: Lec Room 3**

**SM4: Service Management4**

**Chair: Alberto Abadia**

- LISS2016\_415: The Road to Disruptive Success  
*(Alberto Abadia)*
- LISS2016\_59: Study on the relationship between the team commitment, knowledge sharing and performance  
*(Ling Cao, Qijing Wu)*

### **Parallel Sessions (15:10-16:40)**

**Room: Lec Room 3**

**LM13: Logistics Management13**

**Chair: Qilan Zhao**

- LISS2016\_224: Study on Quantity Flexibility Supply Chain Contract Based on System Dynamics  
*(Jingbo Wu, Dong Mu, Jing Xiang, Jian Zhang)*
- LISS2016\_215: Analysis on the Formation of the Third Party Logistics Strategic Alliance  
*(Qiuyan Li, Qilan Zhao)*
- LISS2016\_211: Network Layout of Multimodal Logistics Park for the Central Region in China  
*(Rongyan Zhu, Yong Wang, Shufan Zhu, Zhiqiang Zhao)*
- LISS2016\_203: The Backbone Network Optimization Problem of Air Express: The Case of China Air Express  
*(Jie Xu, Dongmei Wang, Jing Wang, Xiru Yang)*
- LISS2016\_200: Research on the Collaboration of Express Service Network Based on Resource Integration  
*(Wang Qianying, Keming Zhang, Dong Mu)*
- LISS2016\_189: Logistics Cloud Service Context Description  
*(Shuiwang Zhang, Chaolong Yue)*
- LISS2016\_155: Research on the Allocation Decision of Emergency Material Productivity Reserve under the Cooperation between the Government and the Enterprise  
*(Junjun Li, Qilan Zhao)*
- LISS2016\_135: Logistics Capabilities of Cement Transport Firm: Towards an Understanding of Capabilities Portfolio  
*(Mingming Song, Qilan Zhao, Zhigang Song)*
- LISS2016\_134: SEM Research on the Economic Traffic Demand Management Policy of Beijing Based on the Sustainable Development  
*(Cao Xing, Jing Li)*

## 27 July Sessions

### Parallel Sessions (09:00-10:30)

**Room: Lec Room 3**

**LM14: Logistics Management14**

**Chair: Chengcheng Yin**

- LISS2016\_133: A research on the storage strategy of university apartment spare parts based on the stochastic inventory model  
(*Guang Han, Xi-an Sun*)
- LISS2016\_112: Research on Inventory Issues Based on Carbon Trading when the Inventory Capacity Is Limited  
(*Chengcheng Yin*)
- LISS2016\_103: Research on the Coordination Strategy in the Supply Chain with Substituting Procurement Financing Based on Option Contract  
(*Bing Su, Wenliang Bian*)
- LISS2016\_94: Research on the energy efficiency and Coordinating relations of the transportation in Guangdong Province  
(*Jianfeng Lu, Hui Fu*)
- LISS2016\_92: Can Delivery Speed Affect Sale In China's B2C Ecommerce  
(*Fengyangzi Zhang, Guang Song*)
- LISS2016\_86: Research on Dairy Supply Chain Traceability System and its Pre-warning Model  
(*Huilin Zhong, Changgui Lin, Cong Wu, Guanxiang Zhang*)
- LISS2016\_74: Carbon Emission Research of Beijing Transportation System based on SD  
(*Hongqi Yu, Dong Mu*)

### Parallel Sessions (10:50-12:20)

**Room: Lec Room 3**

**LM15: Logistics Management15**

**Chair: Dong Mu**

- LISS2016\_66: Supply Chain Performance under Consignment Contract with Time-and-Price Sensitive Demands  
(*Huiying Zhang, Zikui Lin*)
- LISS2016\_64: Research on Emission Reduction in Supply Chain under the Energy Performance Contracting Mode  
(*Xiaoxue Zeng, Dong Mu, Xibao Xu*)
- LISS2016\_61: Coordination of Online Dual-channel Supply Chain under Differentiated Products  
(*Xiru Yang, Jie Xu*)
- LISS2016\_56: Study on the inventory management of company E auto parts based on Storage Theory  
(*Li Yao, Zikui Lin*)

- LISS2016\_33: Research on the Location of the Railway Logistics Center Based on Existing Railway Freight Station  
(*Liuyi Wu, Haihong Xie*)
- LISS2016\_11: The Design and Implement of China-Japan-South Korea Logistics Information Platform Based on Information Service Exchange  
(*Weiwei Li, Yingjun Yang*)
- LISS2016\_1: The Game of Excess Profits of Logistics Alliance Distribution based on Fair Seats  
(*Zhuangkuo Li, Xintong Chen*)

### Parallel Sessions (13:20-14:50)

**Room: Lec Room 3**

**SM5: Service Management5**

**Chair: Zhuqing Nie**

- LISS2016\_419: EVA model in Enterprise Valuation  
(*Zhuqing Nie*)
- LISS2016\_410: Will CSR Pay in the Financial Sector? An Empirical Study of a Commercial Bank's CSR Orientation, Corporate Reputation and Customer Loyalty in Western China  
(*Yanhai Zhao, Guoxing Zhang, Wei Hou*)
- LISS2016\_344: A Multi-theoretical Perspective Analysis of Radical Innovation Research: An Integrated Framework  
(*Jisheng Huang, Lina Mao, Jinghua Li*)
- LISS2016\_340: Study on the Relationship between Competency and Job Performance of University Counselors: Moderating Role of Responsibility Consciousness  
(*Yingchun Wen, Ming Guo*)
- LISS2016\_336: Psychological Contract's Mediating Effect between Psychological Capital and Job Burnout  
(*Xiaolun Cai, Long Ye*)
- LISS2016\_323: Analysis of Public Crisis Management and Development Strategies  
(*Shuang Lai, He Wang, Cunge Gong*)
- LISS2016\_317: Income Tax's Rate and M&A Transactions  
(*Xiangfei Fu, Yongmei Cui, Lei Du*)
- LISS2016\_292: The Research of Service Innovation on the Base of Catering Service Process ——Taking Haidilao as An Example  
(*Zhiyuan Zhang, Lijuan Xu*)
- LISS2016\_262: Bi-level Programming Model to Ticket Price of Lan-Xin High-speed Railway Based on Competitive Perspective  
(*Xia Luo, Zhipeng Wang, Yue Liu*)
- LISS2016\_246: Satisfaction, Trust and Online Purchase Intention: A Study of Consumer Perceptions  
(*Fulei Chu, Xuan Zhang*)
- LISS2016\_243: An Empirical Study on the Factors Impacting Chinese Customers Purchasing Intention on Samsung Smart Phones  
(*Ruan Xiaowen*)
- LISS2016\_41: How to build a standards system of Community care service for elderly? ——A research based on the condition of China  
(*Zehao Zhang, Jingen Du, Kun Lan, Min Tang*)

## Parallel Sessions (15:10-16:40)

**Room: Lec Room 3**

**SM6: Service Management6**

**Chair: Yongmei Cui**

- LISS2016\_233: Research and implementation of the medical logistics vehicle monitoring and management  
(Cheng Wang, Jinhui Ge)
- LISS2016\_217: Research on the Influence of Mentoring Relationship on Improving the Career Satisfaction of Young Teachers in Universities and Colleges  
(Ruijian Liu, Long Ye, Ming Guo)
- LISS2016\_216: Research on the Relationship between Work Value and Work Performance of Online Sales Staff  
(Yanyu Chen, Long Ye, Ming Guo)
- LISS2016\_202: Quality Cost Model Improvement Based on 6 $\sigma$  Management  
(Baoguang Bai, Jian Zhang)
- LISS2016\_195: Study on the Agricultural Product Distribution Route under Agricultural Super Docking Mode  
(Xueping Zhu, Xiaoguang Geng)
- LISS2016\_188: Self-organizing and Edge of Chaos Analysis of the Multi-agent Traffic Evolution Model  
(Xueyan Li, Xuemei Li)
- LISS2016\_175: High-Performance Work Systems and Job Satisfaction: Mediation Role of Organizational Identification  
(Shuzhen Liu, Long Ye, Ming Guo)
- LISS2016\_174: Institutional Review of China's M&A Policy and An Analysis on Its Effectiveness  
(Yan Zhao, Yongmei Cui)
- LISS2016\_161: Science & Technology Industry Cluster's Collaborative Innovation Risks Identification —Based on Sustainable Innovation  
(Junheng Ji, Qilan Zhao)
- LISS2016\_157: Operation Support of Beijing Metro Automatic Fare Collection System Clearance House System  
(Zhongliang Liu, Shifeng Liu)
- LISS2016\_114: Simulation Research on Educational Management Services of College Students based on the System Dynamics  
(Bo Gao, Tiezhong Liu)
- LISS2016\_101: Research on Database Audit Scheme Design of Life Insurance Industry Based on OLAP Technology  
(Jia Shi, Jiayi Yao, Miao Liu)
- LISS2016\_52: Government Subsidies for Straw Recycling  
(Jingjing Qin, Zikui Lin)

## China Venue (Local Time)

### 25 July Sessions

**Conference opening session (09:00 - 09:30)**

**Chair: Xianliang Shi**

**Room: International Conference Center**

**Photo (09:30 – 10:10)**

**Location: International Conference Center**

**Plenary Session 1 (10:10 - 11:10)**

**Title: Management Science in China and The 13th Five-year Plan for Management Science of NSFC**

**Speaker: *Yijun Li***

**Chair: Xianliang Shi**

**Room: International Conference Center**

**Plenary Session 2 (11:10 - 12:10)**

**Title: Global Value Chain and the Development in Logistics Industrial**

**Speaker: *Shouyang Wang***

**Chair: Xianliang Shi**

**Room: International Conference Center**

**Plenary Session 3 (14:00 - 15:00)**

**Title: Resilience and Sustainability of Container Supply Chains - a risk analysis perspective**

**Speaker: *Zaili Yang***

**Chair: Martin Dresner**

**Room: International Conference Center**

**Plenary Session 4 (15:00 - 16:00)**

**Title: Logistics Considerations in International Trade**

**Speaker: *Martin Dresner***

**Chair: Zaili Yang**

**Room: International Conference Center**

**Plenary Session 4 (16:20 - 17:20)**

**Title: To transport million tons of stored coal in Datong by using Overall Planning Method and Optimization Method**

**Speaker: *Lei Ji***

**Chair: Zaili Yang**

**Room: International Conference Center**



## 26 July Sessions

### Parallel Sessions (08:00-09:50)

**Room: SD303**

**EM1: Engineering Management1**

**Chair: Yisheng Liu**

- LISS2016\_60: Research on the Strategy of “Go-global” for Hydropower Engineering Construction Enterprises  
(*Chenwei Zhang, Yisheng Liu*)
- LISS2016\_279: Game Model of Safety Investment in Mines based on Utility Function  
(*Jian Yu*)
- LISS2016\_122: Research on Risk Management of Engineering Project  
(*Xiaohua Sun*)
- LISS2016\_390: Analysis and Prevention of Construction Contract Risk Management Based on the Contractors' Interests  
(*Yunkai Yan, Yisheng Liu*)
- LISS2016\_191: Study of Railway Passenger Volume Forecast based on Grey Forecasting Model  
(*Ziren Niu*)
- LISS2016\_309: Tangshan iron and steel manufacturing equipment update time point of economic analysis  
(*Shuai Wang, Xindi Wang*)
- LISS2016\_241: Railway Ticket Pricing Policy Portfolio  
(*Mao Qin, Yanjin Li, Guopeng Che*)

### Parallel Sessions (08:00-09:50)

**Room: SD304**

**EM2: Engineering Management2**

**Chair: Jianhua Huang**

- LISS2016\_235: Research on Purchasing management Strategies about graduation and Classification of Railway materials based on materials grouping  
(*Chen Zhao, Gang Xu, Taixin Liang, Yaming Tian, Wei Ren, Chengwen Lv, Bing Yin*)
- LISS2016\_150: Design and Analysis of the Supervision System on Entry Special Articles  
(*Mingxing Song, Yihong Ru, Jing Zhang, Jianhua Huang*)
- LISS2016\_354: Comparison of the System of Construction Quality Control on Cross-Strait  
(*Xiaoxiao Zheng, Yisheng Liu, Ying Shi, Nan Su*)
- LISS2016\_234: Research on Project Financing Modes of BOT and PPP Based on Case Studies  
(*Xiaoting Li*)
- LISS2016\_29: Post Evaluation of Success Degree of a Library Overhaul and Energy-saving Renovation Project  
(*Li Chen, Fushen Sheng, Jing Chen*)
- LISS2016\_303: The Risk Management under Conditions of Contract for EPC in Overseas Projects

- (*Chunguang Lin*)
- LISS2016\_196: Political Risks Analysis for International Project under the New Situation-Case Study on the Market of Saudi Arabia  
(*Jian Zhang, Yuming Liu*)

### Parallel Sessions (08:00-09:50)

**Room: SD308**

**EM3: Engineering Management3**

**Chair: Ximing Ruan**

- LISS2016\_226: Relationship Analysis of the Urban Rail Service Quality, Passenger Satisfaction and Loyalty based on the Structural Equation Model  
(*Liyu Peng, Yunqing Feng, Xuwei Li, Xuemei Li*)
- LISS2016\_73: An Appraisal of Lean Construction Project Delivery: Application of Lean Construction  
(*Ximing Ruan, Edward Ochieng, Tarila Zuofa, Miying Yang*)
- LISS2016\_264: Analysis of The Development of Housing Industrialization Based on System Dynamics  
(*Xiaoting Li*)
- LISS2016\_401: Study on Third Rail Current Collector Shoes Wear of Metro Trains  
(*Chen Yang, Xi Li, Guoqiang Cai, Jinqing Bo*)
- LISS2016\_402: GO-Bayes System Simulation and Verification Method for RCM  
(*Qiong Song, GuoQiang Cai, LiMin Jia*)
- LISS2016\_421: Research on Integrated Management of Railway Engineering Survey and Design Project  
(*Qianqian Wu, Yisheng Liu*)
- LISS2016\_388: The Optimal Parameter Combination For Vehicle Detection From WorldView-2 Imagery  
(*Liang Yanping, Yang Qiang*)

### Parallel Sessions (10:10-12:00)

**Room: SD303**

**IM1: Information Management1**

**Chair: Xiaolan Guan**

- LISS2016\_153: Modelling of Intelligent Publishing Cloud Platform Based on Internet +  
(*Xiaolan Guan, Menggang Li*)
- LISS2016\_222: The Impact of Current Institutional Arrangements on SOE's Privatization  
(*Huili Guo, Xuemei Li*)
- LISS2016\_176: Research on Building Financial Sharing Services Mode of Construction Enterprise  
(*Yanting Shen, Xiyan Lv*)
- LISS2016\_53: Study on Labor Relations from the Perspective of "The Belt and Road Initiative"  
(*Wangli Zhu, Meixia Shi*)
- LISS2016\_230: Study on the Construction of Teaching Management System Based on Knowledge Management  
(*Ying Chai, Jing Zhou, Yujia Liu*)

- LISS2016\_120: The Situation and Development Research of Internet Finance  
(*Xuefeng Xiao, Hua Feng, Jiange Li, Xiaoyan Kui*)
- LISS2016\_404: Behavior Simulation of “Chinese Style Road Crossing” Based on Evolutionary Game Theory  
(*Juanqiong Gou, Xiahui Cai, Shuihai Dou*)
- LISS2016\_434: A Research on Tracing Code of Culture of Food safety traceability Based on RFID and Improved EPC  
(*Peng Liu, Wen Liu, Qiang Li, Min Duan, yanrong wang, Yue Dai*)

### Parallel Sessions (10:10-12:00)

**Room: SD304**

**IM2: Information Management2**

**Chair: Hameeda Akhtar**

- LISS2016\_231: Impact of Corporate Social Responsibility on the Speed of Capital Structure Adjustment A Structural Equation Modeling Approach  
(*Hameeda Akhtar, Xiao Ming, Abdur Rauf Usama*)
- LISS2016\_313: Fuzzy Delphi Method: Issues and Challenges  
(*Khairul A. Rasmani, Nur Amira Mat Saffie, Nur Amirah Mohd Shukor*)
- LISS2016\_28: A Hierarchical Wind Driven Optimization Method for Solving the Bi-level Programming Problem  
(*Lan Xu, Wei Teng*)
- LISS2016\_320: The Reasearch of the Confidential Self-Inspection Automation for the Military Units  
(*Yihan Xue, ChunFang Guo*)
- LISS2016\_102: Influencing Factors of Highly Send and Transfer Stocks: Evidence from Chinese Listed Companies  
(*Zirui Xie, Kai Yuan Zhang*)
- LISS2016\_304: Research on the improvement of human error in the process of production operation  
(*Liu Liu, ChunFang Guo*)
- LISS2016\_395: The Relationship between Company Performance and Executive Compensation of Construction Industry State-owned Listed Companies  
(*Yingying Wang, Bing Zhu*)

### Parallel Sessions (10:10-12:00)

**Room: SD308**

**IM3: Information Management3**

**Chair: Liping Shao**

- LISS2016\_162: How inter-organizational ICT impact on supply chain performance with considering supply chain integration and uncertainty  
(*Xuan Zhang, Xuerong Yang*)
- LISS2016\_48: Construction of the Comprehensive Student Service Platform for Institutions of Higher Education  
(*Yang Xia*)
- LISS2016\_311: Research of the competency model of classified personnel quality evaluation

- (*Qingyang Lv, Liping Shao*)
- LISS2016\_130: Technology Innovation Risk Identification based on sequential CBR  
(*Quan Xiao*)
- LISS2016\_76: The Analysis of the Causes of Alibaba's "double eleven shopping festival"  
Sales Growth Rate Slowing Under The New Normal  
(*Yunguang Deng*)
- LISS2016\_124: The Select of Cross Border Electronic Commerce Information System  
Modes  
(*Xiaotong Li, Xiyun Lv*)
- LISS2016\_391: Capacity Assessment Error Elimination and Evaluation Methods  
(*Yi Mao, Shan'e Xu, Ming Tong*)

### Parallel Sessions (13:00-14:50)

**Room: SD308**

**LM2: Logistics Management2**

**Chair: Yong Lin**

- LISS2016\_171: A Multi-objective, Multi-product and Multi-transportation mode  
Sustainable Closed-loop Supply Chain Network Design  
(*Truong Van Nguyen, Li Zhou, Yong Lin*)
- LISS2016\_182: Smart Manufacturing and Supply Chain Management  
(*Yong Lin, Petros Ieromonachou, Wenxian Sun*)
- LISS2016\_184: Hybrid Supply Patterns in the Automotive Industry  
(*Joachim Kuhn*)
- LISS2016\_250: Unilateral Commitments: A Prisoner's Dilemma Perspective  
(*John-Patrick Paraskevas, Curtis Grimm, Stephanie Eckerd*)
- LISS2016\_255: Low-carbon Logistics Distribution Route Planning With Improved  
Particle Swarm Optimization Algorithm  
(*Keming Zhang, Bin Qiu, Dong Mu*)
- LISS2016\_106: Benefit distribution mechanism of swap trailer transport alliance  
(*Shougeng Gu, Hongjie Lan*)
- LISS2016\_290: Logistics Industry Intergration and Risk Assessment Based on Business  
Process  
(*Xianwen Gong*)
- LISS2016\_24: Research on the Dynamic Capability Affecting the Growth Performance of  
Logistics Service Integrator  
(*Wei Liu, Ling Sun, Juan Li, Wenjuan Li, Hanwen Zhang*)

### Parallel Sessions (13:00-14:50)

**Room: SD304**

**LM1: Logistics Management1**

**Chair: Hongjie Lan**

- LISS2016\_240: Application of BP Neural Network to Animal Transports Monitoring  
(*Miner Zhong, Yong Zhang*)
- LISS2016\_181: The Risk Assessment Model of International Multimodal Transport  
System Based on Complex Network  
(*Lijun Yao, Hongjie Lan*)

- LISS2016\_125: Pricing and Collection Effort Decisions in Supply Chain with Product Remanufacturing  
(*Jian Liu, Huimin Wang, Liuxin Chen*)
- LISS2016\_75: Integrated Platform for Smart Traffic Big Data  
(*Xiaoxia Wang, Zhanqiang Li*)
- LISS2016\_289: Quality Control for Express Items Based on Markov Decision Process  
(*Xu Han, Yisong Li*)
- LISS2016\_278: Optimization of the Steel Supply Chain Costs  
(*Wei Xu, Yu Hou, Ying Ning*)
- LISS2016\_81: Simulation Research of Beijing Urban Distribution Based On the Coordinated Development of Beijing-Tianjin-Hebei  
(*Jun Yin, Xiaochun Lu*)
- LISS2016\_78: The effect of LSSC networks on the growth performance of Logistic Service Integrator  
(*Wei Liu, Juanjuan Song, Wenjuan Li*)

### Parallel Sessions (13:00-14:50)

**Room: SD303**

**IM4: Information Management4**

**Chair: Zhongliang Guan**

- LISS2016\_300: Profiles of Dual Commitment to the Company and Union: Relations to Turnover Intentions and Organizational Citizenship Behavior  
(*Xiangrong Xu, Enhua Hu*)
- LISS2016\_364: Design of Navigation System and Transmitter based on GPS And GSM  
(*Subira Exauty, Hongmin Gao, Xuetian Wang, Xiangzhi Yu*)
- LISS2016\_198: The Preliminary Discussion of Financial Information Management Solutions for Universities  
(*Yujia Liu*)
- LISS2016\_19: Application of a Multi-level Fuzzy Comprehensive Evaluation Method in the Purchase Decision for Library Information Resources  
(*Jing Di, Zhimei Jin, Bo He*)
- LISS2016\_69: The impact that research and development investment has on financial performance in environmental protection industry  
(*Xiangge Wang*)
- LISS2016\_267: Research on fuzzy comprehensive evaluation model of secret-related personnel qualification assessment  
(*Rui Ma, Liping Shao*)
- LISS2016\_68: Evaluation Model of Grape Wine Quality Based on BP Neural Network  
(*Xiaojie Wang, Zhongliang Guan*)
- LISS2016\_362: Risk forewarning model of freight period based on scenario merging  
(*Beibei Pang, Juanqiong Gou, Wenxin Mu, Huan Qiao*)

### Parallel Sessions (15:10-17:00)

**Room: SD303**

**LM3: Logistics Management3**

**Chair: Xiaoling Fu**

- LISS2016\_236: A Hybrid Algorithm for the Truck-and-Trailer Routing Problem with Time Windows  
(*Zhan Bian*)
- LISS2016\_406: A low Carbon Supply Chain network Equilibrium Model with Different Product's Environmental factors  
(*Xiangxiang Huang,Xiaoling Fu*)
- LISS2016\_93: A Uniform Pricing and Channel Selection Model with Random Demand  
(*Ming Lei,Haichao Ma,Xiangdong Liu*)
- LISS2016\_128: Study on Inbound special goods Traceability System on the basis of RFID Technology  
(*Yuan Ye*)
- LISS2016\_363: Analytical Travel Time Models for Multi-Aisle Automated Storage and Retrieval Systems  
(*Xin Lu,Hong-yuan Shi,Li Wang,Da-wei Li*)
- LISS2016\_126: Study on the Recycling Cooperation in Reverse Logistics Participating in Multi-client to Multi- agent under Multi-stage  
(*Jie Wei,Hang Wei*)
- LISS2016\_305: Comparative Analysis of the Supply Situation of Chinese Medicine Service System in Hubei Province  
(*Juan Zhang,Lu Zhang,Jun Li,cuiling guan*)

### Parallel Sessions (15:10-17:00)

**Room: SD304**

**LM4: Logistics Management4**

**Chair: Yisong Li**

- LISS2016\_266: Study on decisions of centralized and decentralized inventory control of fresh food dual-channel  
(*Lihong Wu,Qilan Zhao*)
- LISS2016\_223: A Study on the Business Services Network Node Optimization of Integration  
(*Chao Yin,Mingyu Zhang*)
- LISS2016\_265: Allocation of Carbon Emission Abatement Target and Pricing in a supply chain with two retailers and Government Subsidy  
(*Wei Qi,Xiaomei He,Yong He*)
- LISS2016\_392: Joint decision on promotion and Inventory control for similar item under capacity constraints  
(*Zili Liao,Yisong Li*)
- LISS2016\_140: The Model for the Online Shopping Supply Chain and Its Optimization Based on Online to Offline  
(*Yisheng Wu,Shaobu Bai,Qinghua Lv*)
- LISS2016\_31: A Study on International Cooperation of Chinese Ports under the Context of the 21st Century Maritime Silk Road  
(*Zhaomeng Chen*)
- LISS2016\_108: Research on the problem of warehouse supervisors' arrangement of medicine logistics  
(*Xiaofei Tang, Jiaxing Huang,Hongyun Zheng*)

## Parallel Sessions (15:10-17:00)

**Room: SD308**

**LM5: Logistics Management5**

**Chair: Zhenhua Liu**

- LISS2016\_192: Collaboration Research on Fresh Production Supply Chain Information System  
(*Yong Wang, Peilin Zhang, Qian Lu*)
- LISS2016\_50: The Opportunities and Solutions to Solve Critical Issues of Chinese Logistics in Internet Plus Era  
(*Aoqing Lu, Zhenhua Liu*)
- LISS2016\_62: Demand level judgment under buyback contract: Effects of newsvendor behavior  
(*Zhiru Juan, Haiyan Wang*)
- LISS2016\_159: Industry Reconstruction and Coordinated Development of Yangtze River Economic Zone  
(*Minghao Zhu*)
- LISS2016\_98: Dual-channel Ordering Strategy of New Energy Vehicles  
(*Sijie Diwu, Xiang Zhang*)
- LISS2016\_119: Study on Efficiency of Supply Chain Based on Single Revenue Sharing Contract and Double Contracts Combination  
(*Hongtao Yang, Jianbang Du*)
- LISS2016\_183: Vehicle Routing Optimization of Urban Distribution with Self-pick-up Lockers  
(*Jing Wen, Yisong Li*)

## 27 July Sessions

### Parallel Sessions (08:00-09:50)

**Room: SD303**

**LM6: Logistics Management6**

**Chair: Hanping Hou**

- LISS2016\_105: Key Factors Influencing Adoption of the New Energy Vehicles in China  
(*Ruiting Wang, Xiang Zhang*)
- LISS2016\_79: Research on the Conflict Analysis of dual-channel Supply Chain based on Graph Model  
(*Leizhou Zhao, Qing Zhang*)
- LISS2016\_366: Research on Loading and Routing Problem of Finished Car Logistics  
(*Zhenping Li, Yuan Zhang*)
- LISS2016\_89: Vehicle Scheduling by Freight Forwarder in Collecting-Dispatching System  
(*Mingli Yu, Hanping Hou*)
- LISS2016\_80: Income Distribution of Vehicle Logistics Alliance Based on principal-agent theory  
(*Mingbao Wang, Zhiping Du*)
- LISS2016\_118: Study on Appreciation Strategy of Meat Cold Chain in China  
(*Pei Zhang, Hanping Hou, Jianliang Yang, Dawei Zhang*)
- LISS2016\_357: E-commerce Distribution Vehicle Routing Optimization Research Based on Genetic Algorithm  
(*Lu Han, Hanping Hou, Jianliang Yang, Jieyi Xie*)

### Parallel Sessions (08:00-09:50)

**Room: SD304**

**LM7: Logistics Management7**

**Chair: Xuebing Wang**

- LISS2016\_185: Robust Optimization Model of Multi-logistics-task Allocation Under Service Time Uncertainty  
(*Li Teng*)
- LISS2016\_17: Research on the Comprehensive Material Flow Index of the State based on Sustainable Development  
(*Yuan Tian, Bohui Song, Mengying Liu*)
- LISS2016\_251: Research on the Logistics Efficiency and Simulation of Tianjin Port  
(*Baoqin Yu, Linlin Cui, Xinman Lu*)
- LISS2016\_138: The cold chain logistics enterprise's green level evaluation  
(*Shaoxun Chen, Hongjie Lan*)
- LISS2016\_319: Keep the products fresh: A QFD approach to improve the logistics service quality of cold chain  
(*Xuebing Wang*)
- LISS2016\_352: Research on O2O Model of Fresh Products  
(*Bowen Qin, Hanping Hou*)



- LISS2016\_274: A Study of Distribution Service Modularity Based on Mass Customization  
(*Yixin Zhang, Qilan Zhao*)

### Parallel Sessions (08:00-09:50)

**Room: SD308**

**LM8: Logistics Management8**

**Chair: Dongmei Wang**

- LISS2016\_228: A Two-Phase Greedy Strategy in One to Many PDVRP  
(*Jianing Min, Cheng Jin*)
- LISS2016\_197: A Research on Logistics Model of Electric Energy Metering Device Considering its Continuous Detection Process  
(*Wenliang Bian, Yao Sun*)
- LISS2016\_18: Research on the Comprehensive Material Flow Index of Logistics Enterprise based on Sustainable Development  
(*Yuan Tian, Qianru Shi, Bohui Song*)
- LISS2016\_177: Modeling and Algorithm of Logistics Channel Selection Based on the Network Utility of Nodes and Edges  
(*Lina Chuan, Wenliang Bian, Hongzhen Wang*)
- LISS2016\_259: Resident's Consumer Demand, Government Assignment and Development of Urban Agricultural Products Logistics - Based on the data of agricultural market in Beijing  
(*Fengjiao Jia, Yisong Li*)
- LISS2016\_166: The research on internal game of enterprise based on game theory and analytic hierarchy process  
(*Yunfei Xia*)
- LISS2016\_34: Problems and improvements of the evaluation method of tax burden of logistics industry in China  
(*Dongmei Wang, Yu Sun, Chao Zhang, Jingju Li*)

### Parallel Sessions (10:10-12:00)

**Room: SD303**

**SM1: Service Management1**

**Chair: Jiun-Hung Lin**

- LISS2016\_205: Large, complex systems integrated support system research  
(*Hui Li, Xusheng Shang, Zhaofeng Zhang*)
- LISS2016\_3: The Spatial Transformation Mechanism of Beijing Songzhuang Cultural and Creative Industry Zone: A Perspective of Production of Space  
(*Yazhi Yao, Xianzhu Si, Wen Ye*)
- LISS2016\_321: Electronic Commerce in Romania—History, Overview and Projections  
(*Dan Petrica*)
- LISS2016\_71: Management Practices and Firm Performance Mediating Role of Information Technology, Evidence from Hotel Industry, China  
(*Muhammad Waseem Bari, Meng Fanchen, Muhammad Awais Baloch*)
- LISS2016\_131: Service Quality based passenger segmentation for city bus and service strategy

- (*Jiun-Hung Lin*)
- LISS2016\_55: Study on Online Music Business Model Innovation Based on Value Chain Theory  
(*Jialu Chang, Sijing Liu, Huishan Huang, Dayu Qi, Zhichen Zhao*)
  - LISS2016\_408: The Determinant Analysis of Capital Structure for Listed Companies in Hebei Province  
(*Lin Li*)

### Parallel Sessions (10:10-12:00)

**Room: SD304**

**SM2: Service Management2**

**Chair: Quan Xiao**

- LISS2016\_330: Risk Evaluation of Technology Innovation based on improved matter-element model  
(*Quan Xiao*)
- LISS2016\_214: An empirical analysis of the spatial links in China's outward foreign direct investment  
(*Changfu Sun, Yanmin Shao*)
- LISS2016\_170: A Game Theory Approach in Subsidizing Electric Vehicle Supply Chain  
(*Xiaoyu Gu, Petros Ieromonachou, Li Zhou*)
- LISS2016\_164: Modeling of Multi-Train Seat Inventory Control Based on Revenue Management  
(*Hao Luo, Lei Nie, Zhenhuan He*)
- LISS2016\_22: Financial Supporting Strategies for Regional Economic Growth: A Case Study of Shaanxi Province in China  
(*Jianjun Zhang, Wenxia Shi*)
- LISS2016\_291: Letv's Acquisition of Flowers Film and Letv New Media--A case study based on event and accounting method  
(*Lingyu Wang*)

### Parallel Sessions (10:10-12:00)

**Room: SD308**

**SM3: Service Management3**

**Chair: Lingyu Wang**

- LISS2016\_187: Cyclic Train Timetabling Model for High Speed Railway  
(*Shishun Ding, Dewei Li*)
- LISS2016\_77: Research on Financing Method of Public Charging Facilities Based on Cooperative Game  
(*Cuiwei Li, Shiyu Ma, Yi Ren, Xiao Li, Pining Zhang*)
- LISS2016\_220: The Mode of Cultivating Clothing Talents for Service-oriented Production  
(*Xiaobing Yang*)
- LISS2016\_121: Government Subsidies, Capital Structure and Enterprise Growth--An empirical study based on the new energy industry  
(*Lingyu Wang*)
- LISS2016\_381: The Coupling-Coordination Relationship between Accessibility and

Economic Linkage in Jing-Jin-Ji Metropolitan Area

(*Meiqing Zhang, Dayang Hu*)

- LISS2016\_375: Study on Evolutionary Game of enterprise-oriented university-industry cooperation knowledge flow  
(*Qingling Guan, Jing Zhou, Yujia Liu*)

### Parallel Sessions (13:00-14:50)

**Room: SD303**

**IM7: Information Management7**

**Chair: Dagang Wang**

- LISS2016\_427: the Dynamic Relationship between the Real Estate Stocks and Price in China New Normal  
(*Dagang Wang, Ming Lai*)
- LISS2016\_417: Analysis and Design of Campus E-commerce System  
(*Yanmin Cheng, Baotian Dong*)
- LISS2016\_413: Research on the Policy of the Development of Railway Transportation Industry Based on Value Chain  
(*Xiaobo Dang, Lunqu Yuan*)
- LISS2016\_409: Research on Bus Travel Decision System Based on Generalized Cost Calculation  
(*Mao Qin, Nian Zhang, Zhipeng Wang*)
- LISS2016\_244: The Market Segmentation on Passenger Transportation of High-speed Railway with Logistic Regression Model  
(*Yanjin Li, Hai Zhu, Yonghong Liu*)
- LISS2016\_239: Study of Risk Allocation in PPP Projects Based on Altruistic Theory  
(*Yinglin Wang, Jicai Liu, Bon-Gang Hwang*)
- LISS2016\_238: Analysis of the Competition between CRH Sleeper and Aviation in Beijing-Guangzhou Corridor Based on SP Survey  
(*Xia Luo, Zhi Liu, Hai Zhu*)
- LISS2016\_193: Traffic Mode Share Analysis under Competition of CRH Sleeper And Aviation in Beijing-Guangzhou Transportation Corridor  
(*Xia Luo, Qian Huang, Hai Zhu*)
- LISS2016\_117: Study on Coordinated Relationship between Urban Rail Transit and Land-use  
(*Yuling Zhang, Lihua Guo*)

### Parallel Sessions (13:00-14:50)

**Room: SD304**

**IM8: Information Management8**

**Chair: Yang Zhou**

- LISS2016\_407: The Evaluation on Resource Configuration of Telecom Assets  
(*Yang Zhou*)
- LISS2016\_400: The Internet company realize independent innovation from imitation  
(*Li Ting*)
- LISS2016\_399: The Quantity Prediction of 4G Customers of China Mobile

Communications Corporation Based on SPSS Modeler

*(Yajing Li, Jiayi Yao)*

- LISS2016\_397: The Empirical Study on The Impact of Economic Value Added on Capital Structure of Listed Company in Information Technology Industry  
*(Hu Qing)*
- LISS2016\_372: Granger Causality Relationship between Automobile Sales Volume and Income of Urban Residents  
*(Chenyang Cai, Xuedong Chen)*
- LISS2016\_350: Application of Information Technology in Cultivating College English Learning Motivation  
*(Kun Wang)*
- LISS2016\_339: Integration Application System of Chinese Wooden Architecture Heritages Based on BIM  
*(Yunan Zhang, Zhiying Zhu, Chuangang Li, Lei Chang)*
- LISS2016\_335: Content Analysis of We Media Marketing  
*(Qingyun Ran, Lei Huang, Ying Wang, Xin Song, Chi Zhang)*
- LISS2016\_302: The relationship between the quality of accounting information disclosure and the liquidity -Based on the NEEQ Market  
*(Zuqiang Zhu, Xiaoqian Shen)*
- LISS2016\_273: Mining Organizational Behaviors in Collaborative Logistics Chain: An Empirical Study in a Port  
*(Jie Wang, Bing Zhu, Ying Wang, Lei Huang)*

### Parallel Sessions (13:00-14:50)

**Room: SD308**

**IM9: Information Management9**

**Chair: Xiaoting Qu**

- LISS2016\_298: The Marketing Strategy Research on the O2O Model Online Order Meals System in College Students Group  
*(Bo Xie)*
- LISS2016\_295: A Research on the Model of University Apartment Occupancy Distribution Based on the Student Preferences  
*(Qilin Yu, Xi-an Sun)*
- LISS2016\_284: The Research On the Status-quo of Local Life Service  
*(Fei Dong, Xiaoting Qu)*
- LISS2016\_275: The Hybrid Recommendation model of Commodity based on Parallel Computing  
*(Duan Pengzhe, Dong Baotian)*
- LISS2016\_260: Tianjin Port Throughput Prediction Based on PCA and BP Neural Network  
*(Min Zhang, Yuan Tian)*
- LISS2016\_249: The Study on Executives' Competing for Corporate Control in China's Private Listed Companies  
*(Qiusheng Zhang, Chaofeng Li, Mingjing Yang)*
- LISS2016\_248: Study on the influential mechanism of monetary policy fluctuation and internal control on firm financial constraints  
*(Mingjing Yang, Chaofeng Li)*
- LISS2016\_213: Method Research for High-speed Train Operation Adjustment Based on

Immune Genetic Algorithm

*(Yifeng Miao, Qi Zhang, Xiaozhao Zhou, Feng Chen)*

- LISS2016\_212: An Empirical Research on the Relationship of Equity Incentive and Performance of Chinese Listed Companies  
*(Hong Li)*
- LISS2016\_209: “Internet +” Railway Construction Projects’ Creative Purchasing Model  
*(Jiaying Liu, Lijuan Xu)*

### Parallel Sessions (15:10-17:00)

**Room: SD303**

**IM10: Information Management10**

**Chair: Shifeng Liu**

- LISS2016\_206: Frontier Exploration of Internet Thinking and Case Study  
*(Lifeng Li, Shifeng Liu, Kun Zhang)*
- LISS2016\_168: A Brief Analysis of Favorable and Unfavorable Conditions for Future Development of Pharmaceutical E-commerce in China  
*(Yifei Wang)*
- LISS2016\_143: The Application of Data Mining in the Analysis of High Underpricing Rate of IPO  
*(Ting Han)*
- LISS2016\_141: A Cloud-oriented Two-layer Database Model and Its Algebraic Operations  
*(Ying Li)*
- LISS2016\_132: Research on the Relevant Issues of Intellectual Property Management in Colleges and Universities  
*(Jing Zhou, Juanjuan Du)*
- LISS2016\_115: Disaster Risk Communication Practice: a Comparison between the government of China and USA  
*(Bo Gao, Tiezhong Liu)*
- LISS2016\_110: Using support vector machine for online purchase predication  
*(Xiaoman Liu, Jing Li)*
- LISS2016\_57: Vegetable price fluctuations estimated effect on consumer welfare  
*(Rongxia Zhao)*
- LISS2016\_38: Research on the Application of Data Mining Technology in User Management of P2P Network Financial Platform  
*(Yutong Jiang, Jiayi Yao, Jiangfeng Xu)*
- LISS2016\_20: Analysis on Business Defect Management Driving and Enabling Factors  
*(Yingying Ding)*

### Parallel Sessions (15:10-17:00)

**Room: SD304**

**LM11: Logistics Management11**

**Chair: Ping Li**

- LISS2016\_394: Simulation and Analysis on the Bullwhip Effect based on “Farming-Supermarket Docking”  
*(Hong Ji)*

- LISS2016\_378: The optimal equilibrium of the capital constrained green supply chain under bank credit  
(*Simin An, Jiayi Yao*)
- LISS2016\_376: Vehicle routing problem with simultaneous delivery and pick-up under different weights  
(*Guohua Wang, Wenliang Bian*)
- LISS2016\_370: Research on the Cooperation and Competition Strategies of Port Based on Hinterland Traffic Condition  
(*Nannan Hu, Jie Wang, Dong Mu*)
- LISS2016\_359: Based on the Regression Analysis Model Throughput Forecast of Port Group in the upper Yangtze River  
(*Ping Li*)
- LISS2016\_353: Study on China's Rapid Rescue System of Natural Disasters Emergency Logistics  
(*Jianliang Yang, Hanping Hou, Lu Han, Dawei Zhang*)
- LISS2016\_347: Automated Warehouse Storage Assignment Policy Based on Storage Frequency and Workload Balance  
(*Jinwen Cai, Xiang'an Kuang, Shaohua Song, Qilan Zhao*)
- LISS2016\_345: Research of the influence of logistics service negative comments on online sales  
(*Shaohua Song, Jinwen Cai, Shuya Yu, Mengyue Wang*)
- LISS2016\_314: Optimizing Berth Operation System in Container Terminal by Simulation  
(*Lu Bo*)
- LISS2016\_312: Improve TSP problem allowing multiple vehicles distribution  
(*Qiguang Wang*)

### Parallel Sessions (15:10-17:00)

**Room: SD308**

**LM12: Logistics Management12**

**Chair: Jianqin Zhou**

- LISS2016\_310: A multi-stage location problem in route construction project management  
(*Ke Li, Jianqin Zhou*)
- LISS2016\_306: Online Consumer's Optimal Purchasing Decisions Under Contingent Free Delay Shipping  
(*Qianqian Liu, Wenliang Bian*)
- LISS2016\_297: The Impact of Organizational Learning and Supply Chain Collaboration on Service Innovation Performance  
(*Min Li, Zhaoquan Jian, Lei Li*)
- LISS2016\_293: Dynamic Pricing Considering Strategic Customers  
(*Yongli Wang*)
- LISS2016\_287: Allocating profits among collaborative carriers in less-than-truckload industry  
(*Yuqian Wan, Jingzhi Ding*)
- LISS2016\_283: A Route-like Demand Location Problem Based on Squared-Euclidean Distance  
(*Lu Liu, Jianqin Zhou*)
- LISS2016\_276: Research on the Simulation Model of the Supply Chain with the Constraint of Carbon Emissions

- (Chunyue Wang, Keming Zhang, Dong Mu)*
- LISS2016\_245: The Identification and Analysis of the Logistics System in Management of the Division of the Assay Office  
*(Marta Kadlubek, Paula Koch)*
  - LISS2016\_237: The Carbon Emission Reduction Coordination of Fresh Supply Chain Based on the Limited Carbon Quota and Trading  
*(Jinxiao Wang, Guowei Hua, Keming Zhang)*
  - LISS2016\_148: Collaboration Modes and Advantages in Supply Chain  
*(Lin Huang, Yong Lin, Petros Ieromonachou, Wenxian Sun)*

# Session Schedule



Paper ID	Author	Group	Session name	Date	Time	Room
1	Zhuangkuo Li,Xintong Chen	LM15	Logistics Management15	2016-07-27	10:50-12:20	Lec Room 3
3	Yazhi Yao,Xianzhu Si,Wen Ye	SM1	Service Management1	2016-07-27	10:10-12:00	SD303
11	Weiwei Li,Yingjun Yang	LM15	Logistics Management15	2016-07-27	10:50-12:20	Lec Room 3
17	Yuan Tian,Bohui Song,Mengying Liu	LM7	Logistics Management7	2016-07-27	08:00-09:50	SD304
18	Yuan Tian,Qianru Shi,Bohui Song	LM8	Logistics Management8	2016-07-27	08:00-09:50	SD308
19	Jing Di,Zhimei Jin,Bo He	IM4	Information Management4	2016-07-26	13:00-14:50	SD303
20	Yingying Ding	IM10	Information Management10	2016-07-27	15:10-17:00	SD303
22	Jianjun Zhang,Wenxia Shi	SM2	Service Management2	2016-07-27	10:10-12:00	SD304
24	Wei Liu,Ling Sun,Juan Li,Wenjuan Li,Hanwen Zhang	LM2	Logistics Management2	2016-07-26	13:00-14:50	SD308
28	Lan Xu,Wei Teng	IM2	Information Management2	2016-07-26	10:10-12:00	SD304
29	Li Chen,Fushen Sheng,Jing Chen	EM2	Engineering Management2	2016-07-26	08:00-09:50	SD304
31	Zhaomeng Chen	LM4	Logistics Management4	2016-07-26	15:10-17:00	SD304
33	Liuyi Wu,Haihong Xie	LM15	Logistics Management15	2016-07-27	10:50-12:20	Lec Room 3
34	Dongmei Wang,Yu Sun,Chao Zhang,Jingju Li	LM8	Logistics Management8	2016-07-27	08:00-09:50	SD308
37	Wenjie Wang,Qi Xu,Changchun Gao,Weiwei Ma	LM10	Logistics Management10	2016-07-26	10:50-12:20	Lec Room 3
38	Yutong Jiang,jiayi Yao,Jiangfeng Xu	IM10	Information Management10	2016-07-27	15:10-17:00	SD303
41	Zehao Zhang,Jingen Du,Kun Lan,Min Tang	SM5	Service Management5	2016-07-27	13:20-14:50	Lec Room 3

46	Chen Chen,Qing Wu,Yingping Zhou,Zhe Mao	SCM1	Sustainable Container Supply Chain Management1	2016-07-26	09:00-18:00	SD611
48	Yang Xia	IM3	Information Management3	2016-07-26	10:10-12:00	SD308
50	Aoqing Lu,Zhenhua Liu	LM5	Logistics Management5	2016-07-26	15:10-17:00	SD308
52	Jingjing Qin,Zikui Lin	SM6	Service Management6	2016-07-27	15:10-16:40	Lec Room 3
53	Wangli Zhu,Meixia Shi	IM1	Information Management1	2016-07-26	10:10-12:00	SD303
55	Jialu Chang,Sijing Liu,Huishan Huang,Dayu Qi,Zhichen Zhao	SM1	Service Management1	2016-07-27	10:10-12:00	SD303
56	Li Yao,ZiKui Lin	LM15	Logistics Management15	2016-07-27	10:50-12:20	Lec Room 3
57	Rongxia Zhao	IM10	Information Management10	2016-07-27	15:10-17:00	SD303
58	Can Liu,Bin Dan,Maosen Zhou,Xumei Zhang	LM10	Logistics Management10	2016-07-26	10:50-12:20	Lec Room 3
59	Ling Cao,Qijing Wu	SM4	Service Management4	2016-07-26	13:20-14:50	Lec Room 3
60	Chenwei Zhang,Yisheng Liu	EM1	Engineering Management1	2016-07-26	08:00-09:50	SD303
61	Xiru Yang,Jie Xu	LM15	Logistics Management15	2016-07-27	10:50-12:20	Lec Room 3
62	Zhiru Juan,Haiyan Wang	LM5	Logistics Management5	2016-07-26	15:10-17:00	SD308
64	Xiaoxue Zeng,Dong Mu,Xibao Xu	LM15	Logistics Management15	2016-07-27	10:50-12:20	Lec Room 3
65	Wen Chen,Xiaochun Lu	SCM1	Sustainable Container Supply Chain Management1	2016-07-26	09:00-18:00	SD611
66	Huiying Zhang,Zikui Lin	LM15	Logistics Management15	2016-07-27	10:50-12:20	Lec Room 3
68	Xiaojie Wang,Zhongliang Guan	IM4	Information Management4	2016-07-26	13:00-14:50	SD303
69	Xiangge Wang	IM4	Information Management4	2016-07-26	13:00-14:50	SD303
70	Xiuxian Huang,Xianliang Shi	SCM1	Sustainable Container Supply Chain Management1	2016-07-26	09:00-18:00	SD611

71	Muhammad Waseem Bari,Meng Fanchen,Muhammad Awais Baloch	SM1	Service Management1	2016-07-27	10:10-12:00	SD303
73	Ximing Ruan,Edward Ochieng,Tarila Zuofa,Miying Yang	EM3	Engineering Management3	2016-07-26	08:00-09:50	SD308
74	Hongqi Yu,Dong Mu	LM14	Logistics Management14	2016-07-27	09:00-10:30	Lec Room 3
75	Xiaoxia Wang,Zhanqiang Li	LM1	Logistics Management1	2016-07-26	13:00-14:50	SD304
76	Yunguang Deng	IM3	Information Management3	2016-07-26	10:10-12:00	SD308
77	Cuiwei Li,Shiyu Ma,Yi Ren,Xiao Li,Pinning Zhang	SM3	Service Management3	2016-07-27	10:10-12:00	SD308
78	Wei Liu,Juanjuan Song,Wenjuan Li	LM1	Logistics Management1	2016-07-26	13:00-14:50	SD304
79	Leizhou Zhao,Qing Zhang	LM6	Logistics Management6	2016-07-27	08:00-09:50	SD303
80	Mingbao Wang,Zhiping Du	LM6	Logistics Management6	2016-07-27	08:00-09:50	SD303
81	Jun Yin,Xiaochun Lu	LM1	Logistics Management1	2016-07-26	13:00-14:50	SD304
86	Huiling Zhong,Changgui Lin,Cong Wu,Guanxiang Zhang	LM14	Logistics Management14	2016-07-27	09:00-10:30	Lec Room 3
89	Mingli Yu,Hanping Hou	LM6	Logistics Management6	2016-07-27	08:00-09:50	SD303
92	Fengyangzi Zhang,Guang Song	LM14	Logistics Management14	2016-07-27	09:00-10:30	Lec Room 3
93	Ming Lei,Haichao MA,Xiangdong Liu	LM3	Logistics Management3	2016-07-26	15:10-17:00	SD303
94	Jianfeng Lu,Hui Fu	LM14	Logistics Management14	2016-07-27	09:00-10:30	Lec Room 3
95	Xiao Wang,Ai Wang,Xuedong Gao	IDA	Intelligent Data Analysis	2016-07-25	13:40-15:10	Lec Room 3
98	Sijie Diwu,Xiang Zhang	LM5	Logistics Management5	2016-07-26	15:10-17:00	SD308
101	Jia Shi,jiayi Yao,Miao Liu	SM6	Service Management6	2016-07-27	15:10-16:40	Lec Room

						3
102	Zirui Xie,Kai Yuan Zhang	IM2	Information Management2	2016-07-26	10:10-12:00	SD304
103	Bing Su,Wenliang Bian	LM14	Logistics Management14	2016-07-27	09:00-10:30	Lec Room 3
105	Ruiting Wang,Xiang Zhang	LM6	Logistics Management6	2016-07-27	08:00-09:50	SD303
106	Shougeng Gu,Hongjie Lan	LM2	Logistics Management2	2016-07-26	13:00-14:50	SD308
108	Xiaofei Tang,Jiaying Huang,Hongyun Zheng	LM4	Logistics Management4	2016-07-26	15:10-17:00	SD304
110	Xiaoman Liu,Jing Li	IM10	Information Management10	2016-07-27	15:10-17:00	SD303
112	Chengcheng Yin	LM14	Logistics Management14	2016-07-27	09:00-10:30	Lec Room 3
114	Bo Gao,Tiezhong Liu	SM6	Service Management6	2016-07-27	15:10-16:40	Lec Room 3
115	Bo Gao,Tiezhong Liu	IM10	Information Management10	2016-07-27	15:10-17:00	SD303
116	Zhe Zhang,Zhongliang Guan	IM6	Information Management6	2016-07-25	15:30-17:00	Lec Room 3
117	Yuling Zhang,Lihua Guo	IM7	Information Management7	2016-07-27	13:00-14:50	SD303
118	Pei Zhang,Hanping Hou,Jianliang Yang,Dawei Zhang	LM6	Logistics Management6	2016-07-27	08:00-09:50	SD303
119	Hongtao Yang,Jianbang Du	LM5	Logistics Management5	2016-07-26	15:10-17:00	SD308
120	Xuefeng Xiao,Hua Feng,Jiange Li,Xiaoyan Kui	IM1	Information Management1	2016-07-26	10:10-12:00	SD303
121	Lingyu Wang	SM3	Service Management3	2016-07-27	10:10-12:00	SD308
122	Xiaohua Sun	EM1	Engineering Management1	2016-07-26	08:00-09:50	SD303
124	Xiaotong Li,Xiyan Lv	IM3	Information Management3	2016-07-26	10:10-12:00	SD308
125	Jian Liu,Huimin Wang,Liuxin Chen	LM1	Logistics Management1	2016-07-26	13:00-14:50	SD304
126	Jie Wei,Hang Wei	LM3	Logistics Management3	2016-07-26	15:10-17:00	SD303
127	Mingyang Zhang	LM9	Logistics Management9	2016-07-26	09:00-10:30	Lec Room

						3
128	Yuan Ye	LM3	Logistics Management3	2016-07-26	15:10-17:00	SD303
130	Quan Xiao	IM3	Information Management3	2016-07-26	10:10-12:00	SD308
131	Jiun-Hung Lin	SM1	Service Management1	2016-07-27	10:10-12:00	SD303
132	Jing Zhou,Juanjuan Du	IM10	Information Management10	2016-07-27	15:10-17:00	SD303
133	Guang Han,Xi-an Sun	LM14	Logistics Management14	2016-07-27	09:00-10:30	Lec Room 3
134	Cao Xing,Jing Li	LM13	Logistics Management13	2016-07-26	15:10-16:40	Lec Room 3
135	Mingming Song,Qilan Zhao,Zhigang Song	LM13	Logistics Management13	2016-07-26	15:10-16:40	Lec Room 3
138	Shaoxun Chen,Hongjie Lan	LM7	Logistics Management7	2016-07-27	08:00-09:50	SD304
140	Yisheng Wu,Shaobu Bai,Qinghua Lv	LM4	Logistics Management4	2016-07-26	15:10-17:00	SD304
141	Ying Li	IM10	Information Management10	2016-07-27	15:10-17:00	SD303
143	Ting Han	IM10	Information Management10	2016-07-27	15:10-17:00	SD303
144	Yunfang Ma,Dan Chang	SCM1	Sustainable Container Supply Chain Management1	2016-07-26	09:00-18:00	SD611
145	Wen Yang,Jianhua Ma,Yanchun Pan	IM6	Information Management6	2016-07-25	15:30-17:00	Lec Room 3
148	Lin Huang, Yong Lin, Petros Ieromonachou, Wenxian Sun	LM12	Logistics Management12	2016-07-27	15:10-17:00	SD308
150	Mingxing Song, Yihong Ru, Jing Zhang, Jianhua Huang	EM2	Engineering Management2	2016-07-26	08:00-09:50	SD304
152	Shan Xue,Li Xiong,Lu Zhao	IM6	Information Management6	2016-07-25	15:30-17:00	Lec Room 3
153	Xiaolan Guan,Menggang Li	IM1	Information Management1	2016-07-26	10:10-12:00	SD303
155	Junjun Li,Qilan Zhao	LM13	Logistics Management13	2016-07-26	15:10-16:40	Lec Room 3
157	Zhongliang Liu,Shifeng Liu	SM6	Service Management6	2016-07-27	15:10-16:40	Lec Room 3

159	Minghao Zhu	LM5	Logistics Management5	2016-07-26	15:10-17:00	SD308
161	Junheng Ji,Qilan Zhao	SM6	Service Management6	2016-07-27	15:10-16:40	Lec Room 3
162	Xuan Zhang,Xuerong Yang	IM3	Information Management3	2016-07-26	10:10-12:00	SD308
164	Hao Luo,Lei Nie,Zhenhuan He	SM2	Service Management2	2016-07-27	10:10-12:00	SD304
166	Yunfei Xia	LM8	Logistics Management8	2016-07-27	08:00-09:50	SD308
168	Yifei Wang	IM10	Information Management10	2016-07-27	15:10-17:00	SD303
170	Xiaoyu Gu,Petros Ieromonachou,Li Zhou	SM2	Service Management2	2016-07-27	10:10-12:00	SD304
171	Truong Van Nguyen,Li Zhou,Yong Lin	LM2	Logistics Management2	2016-07-26	13:00-14:50	SD308
174	Yan Zhao,Yongmei Cui	SM6	Service Management6	2016-07-27	15:10-16:40	Lec Room 3
175	Shuzhen Liu,Long Ye,Ming Guo	SM6	Service Management6	2016-07-27	15:10-16:40	Lec Room 3
176	Yanting Shen,Xiyan Lv	IM1	Information Management1	2016-07-26	10:10-12:00	SD303
177	Lina Chuan,Wenliang Bian ,Hongzhen Wang	LM8	Logistics Management8	2016-07-27	08:00-09:50	SD308
181	Lijun Yao,Hongjie Lan	LM1	Logistics Management1	2016-07-26	13:00-14:50	SD304
182	Yong Lin,Petros Ieromonachou,Wenxian Sun	LM2	Logistics Management2	2016-07-26	13:00-14:50	SD308
183	Jing Wen,Yisong Li	LM5	Logistics Management5	2016-07-26	15:10-17:00	SD308
184	Joachim Kuhn	LM2	Logistics Management2	2016-07-26	13:00-14:50	SD308
185	Li Teng	LM7	Logistics Management7	2016-07-27	08:00-09:50	SD304
187	Shishun Ding,Dewei Li	SM3	Service Management3	2016-07-27	10:10-12:00	SD308
188	Xueyan Li,Xuemei Li	SM6	Service Management6	2016-07-27	15:10-16:40	Lec Room 3
189	Shuiwang Zhang,Chaolong Yue	LM13	Logistics Management13	2016-07-26	15:10-16:40	Lec Room 3
191	Ziren Niu	EM1	Engineering Management1	2016-07-26	08:00-09:50	SD303

192	Yong Wang,Peilin Zhang,Qian Lu	LM5	Logistics Management5	2016-07-26	15:10-17:00	SD308
193	Xia Luo,Qian Huang,Hai Zhu	IM7	Information Management7	2016-07-27	13:00-14:50	SD303
194	Yue Huang	IDA	Intelligent Data Analysis	2016-07-25	13:40-15:10	Lec Room 3
195	Xueping Zhu,Xiaoguang Geng	SM6	Service Management6	2016-07-27	15:10-16:40	Lec Room 3
196	Jian Zhang,Yuming Liu	EM2	Engineering Management2	2016-07-26	08:00-09:50	SD304
197	Wenliang Bian,Yao Sun	LM8	Logistics Management8	2016-07-27	08:00-09:50	SD308
198	Yujia Liu	IM4	Information Management4	2016-07-26	13:00-14:50	SD303
200	Wang Qianying,Keming Zhang,Dong Mu	LM13	Logistics Management13	2016-07-26	15:10-16:40	Lec Room 3
202	Baoguang Bai,Jian Zhang	SM6	Service Management6	2016-07-27	15:10-16:40	Lec Room 3
203	Jie Xu,Dongmei Wang,Jing Wang,Xiru Yang	LM13	Logistics Management13	2016-07-26	15:10-16:40	Lec Room 3
205	Hui Li,Xusheng Shang ,Zhaofeng Zhang	SM1	Service Management1	2016-07-27	10:10-12:00	SD303
206	Lifeng Li,Shifeng Liu,Kun Zhang	IM10	Information Management10	2016-07-27	15:10-17:00	SD303
207	Zhenwei Wang,Xiaomin Zhu,Qian Pu	LM9	Logistics Management9	2016-07-26	09:00-10:30	Lec Room 3
209	Jiaying Liu,Lijuan Xu	IM9	Information Management9	2016-07-27	13:00-14:50	SD308
210	Christina Tay	IM6	Information Management6	2016-07-25	15:30-17:00	Lec Room 3
211	Rongyan Zhu,Yong Wang,Shufan Zhu,Zhiqiang Zhao	LM13	Logistics Management13	2016-07-26	15:10-16:40	Lec Room 3
212	Hong Li	IM9	Information Management9	2016-07-27	13:00-14:50	SD308
213	Yifeng Miao,Qi Zhang,Xiaozhao Zhou,Feng Chen	IM9	Information Management9	2016-07-27	13:00-14:50	SD308
214	Changfu Sun,Yanmin Shao	SM2	Service Management2	2016-07-27	10:10-12:00	SD304

215	Qiuyan Li,Qilan Zhao	LM13	Logistics Management13	2016-07-26	15:10-16:40	Lec Room 3
216	Yanyu Chen,Long Ye,Ming Guo	SM6	Service Management6	2016-07-27	15:10-16:40	Lec Room 3
217	Ruijian Liu,Long Ye,Ming Guo	SM6	Service Management6	2016-07-27	15:10-16:40	Lec Room 3
218	Mingze Liu,Xianliang Shi	SCM1	Sustainable Container Supply Chain Management1	2016-07-26	09:00-18:00	SD611
220	Xiaobing Yang	SM3	Service Management3	2016-07-27	10:10-12:00	SD308
222	Huili Guo,Xuemei Li	IM1	Information Management1	2016-07-26	10:10-12:00	SD303
223	Chao Yin,Mingyu Zhang	LM4	Logistics Management4	2016-07-26	15:10-17:00	SD304
224	Jingbo Wu,Dong Mu,Jing Xiang,Jian Zhang	LM13	Logistics Management13	2016-07-26	15:10-16:40	Lec Room 3
226	Liyu Peng,Yunqing Feng,Xuwei Li,Xuemei Li	EM3	Engineering Management3	2016-07-26	08:00-09:50	SD308
228	Jianing Min,Cheng Jin	LM8	Logistics Management8	2016-07-27	08:00-09:50	SD308
230	Ying Chai,Jing Zhou,Yujia Liu	IM1	Information Management1	2016-07-26	10:10-12:00	SD303
231	Hameeda Akhtar,Xiao Ming,Abdur Rauf Usama	IM2	Information Management2	2016-07-26	10:10-12:00	SD304
233	Cheng Wang,JinHui Ge	SM6	Service Management6	2016-07-27	15:10-16:40	Lec Room 3
234	Xiaoting Li	EM2	Engineering Management2	2016-07-26	08:00-09:50	SD304
235	Chen Zhao,Gang Xu,Taixin Liang,Yaming Tian,Wei Ren,Chengwen Lv,Bing Yin	EM2	Engineering Management2	2016-07-26	08:00-09:50	SD304
236	Zhan Bian	LM3	Logistics Management3	2016-07-26	15:10-17:00	SD303
237	Jinxiao Wang,Guowei Hua,Keming Zhang	LM12	Logistics Management12	2016-07-27	15:10-17:00	SD308
238	Xia Luo,Zhi Liu,Hai Zhu	IM7	Information Management7	2016-07-27	13:00-14:50	SD303
239	Yinglin Wang,Jicai Liu,Bon-Gang Hwang	IM7	Information Management7	2016-07-27	13:00-14:50	SD303



240	Miner Zhong, Yong Zhang	LM1	Logistics Management1	2016-07-26	13:00-14:50	SD304
241	Mao Qin, Yanjin Li, Guopeng Che	EM1	Engineering Management1	2016-07-26	08:00-09:50	SD303
243	Ruan Xiaowen	SM5	Service Management5	2016-07-27	13:20-14:50	Lec Room 3
244	Yanjin Li, Hai Zhu, Yonghong Liu	IM7	Information Management7	2016-07-27	13:00-14:50	SD303
245	Marta Kadłubek, Paula Koch	LM12	Logistics Management12	2016-07-27	15:10-17:00	SD308
246	Fulei Chu, Xuan Zhang	SM5	Service Management5	2016-07-27	13:20-14:50	Lec Room 3
248	Mingjing Yang, Chaofeng Li	IM9	Information Management9	2016-07-27	13:00-14:50	SD308
249	Qiusheng Zhang, Chaofeng Li, Mingjing Yang	IM9	Information Management9	2016-07-27	13:00-14:50	SD308
250	John-Patrick Paraskevas, Curtis Grimm, Stephanie Eckerd	LM2	Logistics Management2	2016-07-26	13:00-14:50	SD308
251	Baoqin Yu, Linlin Cui, Xinman Lu	LM7	Logistics Management7	2016-07-27	08:00-09:50	SD304
253	Sen Wu, Liwei Fu	IDA	Intelligent Data Analysis	2016-07-25	13:40-15:10	Lec Room 3
254	Jianfeng Yuan, Jianhua Ma, Wen Yang	LM9	Logistics Management9	2016-07-26	09:00-10:30	Lec Room 3
255	Keming Zhang, Bin Qiu, Dong Mu	LM2	Logistics Management2	2016-07-26	13:00-14:50	SD308
259	Fengjiao Jia, Yisong Li	LM8	Logistics Management8	2016-07-27	08:00-09:50	SD308
260	Min Zhang, Yuan Tian	IM9	Information Management9	2016-07-27	13:00-14:50	SD308
261	Xin Lin, Fei Geng, Zhihong Jin, Qi Xu	SCM1	Sustainable Container Supply Chain Management1	2016-07-26	09:00-18:00	SD611
262	Xia Luo, Zhipeng Wang, Yue Liu	SM5	Service Management5	2016-07-27	13:20-14:50	Lec Room 3
263	Jing Liu, Yanyang Ma, Yanli Guo, Jianbin Chen	IM6	Information Management6	2016-07-25	15:30-17:00	Lec Room 3
264	Xiaoting Li	EM3	Engineering Management3	2016-07-26	08:00-09:50	SD308
265	Wei Qi, Xiaomei He, Yong He	LM4	Logistics Management4	2016-07-26	15:10-17:00	SD304

266	Lihong Wu,Qilan Zhao	LM4	Logistics Management4	2016-07-26	15:10-17:00	SD304
267	Rui Ma,Liping Shao	IM4	Information Management4	2016-07-26	13:00-14:50	SD303
273	Jie Wang,Bing Zhu,Ying Wang,Lei Huang	IM8	Information Management8	2016-07-27	13:00-14:50	SD304
274	Yixin Zhang,Qilan Zhao	LM7	Logistics Management7	2016-07-27	08:00-09:50	SD304
275	Duan Pengzhe,Dong Baotian	IM9	Information Management9	2016-07-27	13:00-14:50	SD308
276	Chunyu Wang,Keming Zhang,Dong Mu	LM12	Logistics Management12	2016-07-27	15:10-17:00	SD308
278	Wei Xu,Yu Hou,Ying Ning	LM1	Logistics Management1	2016-07-26	13:00-14:50	SD304
279	Jian Yu	EM1	Engineering Management1	2016-07-26	08:00-09:50	SD303
280	Lei Xing,Zhenhua Yang,Shujuan Guo,Zhihong Jin	SCM1	Sustainable Container Supply Chain Management1	2016-07-26	09:00-18:00	SD611
282	Zhenhua Yang,Lei Xing,Shujuan Guo,Zhihong Jin,Lixin Shen	SCM1	Sustainable Container Supply Chain Management1	2016-07-26	09:00-18:00	SD611
283	Lu Liu,Jianqin Zhou	LM12	Logistics Management12	2016-07-27	15:10-17:00	SD308
284	Fei Dong,Xiaoting Qu	IM9	Information Management9	2016-07-27	13:00-14:50	SD308
286	Xing Wang,Bofeng Yu,Haitao Wen,Yan Li,Shuzhi Zhao	LM10	Logistics Management10	2016-07-26	10:50-12:20	Lec Room 3
287	Yuqian Wan,Jingzhi Ding	LM12	Logistics Management12	2016-07-27	15:10-17:00	SD308
289	Xu Han,Yisong Li	LM1	Logistics Management1	2016-07-26	13:00-14:50	SD304
290	Xianwen Gong	LM2	Logistics Management2	2016-07-26	13:00-14:50	SD308
291	Lingyu Wang	SM2	Service Management2	2016-07-27	10:10-12:00	SD304
292	Zhiyuan Zhang,Lijuan Xu	SM5	Service Management5	2016-07-27	13:20-14:50	Lec Room 3
293	Yongli Wang	LM12	Logistics Management12	2016-07-27	15:10-17:00	SD308
295	Qilin Yu,Xi-an Sun	IM9	Information Management9	2016-07-27	13:00-14:50	SD308
296	Xuedong Gao,Minghan Yang,Ling Li	IDA	Intelligent Data Analysis	2016-07-25	13:40-15:10	Lec Room 3
297	Min Li,Zhaoquan Jian,Lei Li	LM12	Logistics Management12	2016-07-27	15:10-17:00	SD308
298	Bo Xie	IM9	Information Management9	2016-07-27	13:00-14:50	SD308

300	Xiangrong Xu,Enhua Hu	IM4	Information Management4	2016-07-26	13:00-14:50	SD303
301	Gui-ying Wei,Wen-ming Cai,Lan Qin	IDA	Intelligent Data Analysis	2016-07-25	13:40-15:10	Lec Room 3
302	Zuqiang Zhu,Xiaoqian Shen	IM8	Information Management8	2016-07-27	13:00-14:50	SD304
303	Chunguang Lin	EM2	Engineering Management2	2016-07-26	08:00-09:50	SD304
304	Liu Liu,ChunFang Guo	IM2	Information Management2	2016-07-26	10:10-12:00	SD304
305	Juan Zhang,Lu Zhang,Jun Li,cuiling guan	LM3	Logistics Management3	2016-07-26	15:10-17:00	SD303
306	Qianqian Liu,Wenliang Bian	LM12	Logistics Management12	2016-07-27	15:10-17:00	SD308
308	Ning Lin,Harald Hjelle,Kevin Cullinane,Rickard Bergqvist,Olav Eidhammer,Yuhong Wang,Zaili Yang,Zhuohua Qu	SCM1	Sustainable Container Supply Chain Management1	2016-07-26	09:00-18:00	SD611
309	Shuai Wang,Xindi Wang	EM1	Engineering Management1	2016-07-26	08:00-09:50	SD303
310	Ke Li,Jianqin Zhou	LM12	Logistics Management12	2016-07-27	15:10-17:00	SD308
311	Qingyang Lv,Liping Shao	IM3	Information Management3	2016-07-26	10:10-12:00	SD308
312	Qiguang Wang	LM11	Logistics Management11	2016-07-27	15:10-17:00	SD304
313	Khairul A. Rasmani,Nur Amira Mat Saffie,Nur Amirah Mohd Shukor	IM2	Information Management2	2016-07-26	10:10-12:00	SD304
314	Lu Bo	LM11	Logistics Management11	2016-07-27	15:10-17:00	SD304
317	Xiangfei Fu,Yongmei Cui,Lei Du	SM5	Service Management5	2016-07-27	13:20-14:50	Lec Room 3
319	Xuebing Wang	LM7	Logistics Management7	2016-07-27	08:00-09:50	SD304
320	Yihan Xue,ChunFang Guo	IM2	Information Management2	2016-07-26	10:10-12:00	SD304
321	Dan Petrica	SM1	Service Management1	2016-07-27	10:10-12:00	SD303
322	Haitao Wen,Huasha Wu,Xing Wang	LM10	Logistics Management10	2016-07-26	10:50-12:20	Lec Room 3
323	Shuang Lai,He Wang,Cunge Gong	SM5	Service Management5	2016-07-27	13:20-14:50	Lec Room

						3
328	Anqiang Huang,Zhenji Zhang,Guowei Hua,Zaili Yang,Xianliang Shi	SCM1	Sustainable Container Supply Chain Management1	2016-07-26	09:00-18:00	SD611
329	Xuedong Gao,Kan Gu,Danyue Wang	IDA	Intelligent Data Analysis	2016-07-25	13:40-15:10	Lec Room 3
330	Quan Xiao	SM2	Service Management2	2016-07-27	10:10-12:00	SD304
331	Hua He,Changsong Ma,Zhenyu Luo,Hang Yu	LM9	Logistics Management9	2016-07-26	09:00-10:30	Lec Room 3
333	Xiangchao Liu,Changsong Ma,Hua He,Hongmei Zhang	LM9	Logistics Management9	2016-07-26	9:00-10:30	Lec Room 3
335	Qingyun Ran,Lei Huang,Ying Wang,Xin Song,Chi Zhang	IM8	Information Management8	2016-07-27	13:00-14:50	SD304
336	Xiaolun Cai,Long Ye	SM5	Service Management5	2016-07-27	13:20-14:50	Lec Room 3
338	Shiqi Fan,Di Zhang,Eduardo Blanco-Davis,Jin Wang,Ming Huang,Fan Zhang,Xinping Yan	SCM1	Sustainable Container Supply Chain Management1	2016-07-26	09:00-18:00	SD611
339	Yunan Zhang,Zhiying Zhu,Chuangang Li,Lei Chang	IM8	Information Management8	2016-07-27	13:00-14:50	SD304
340	Yingchun Wen,Ming Guo	SM5	Service Management5	2016-07-27	13:20-14:50	Lec Room 3
342	Yuyu Li,Hui Huang,Bo Huang	LM10	Logistics Management10	2016-07-26	10:50-12:20	Lec Room 3
343	Xuedong Gao,Hailan Chen	IDA	Intelligent Data Analysis	2016-07-25	13:40-15:10	Lec Room 3
344	Jisheng Huang,Lina Mao,Jinghua Li	SM5	Service Management5	2016-07-27	13:20-14:50	Lec Room 3
345	Shaohua Song,Jinwen Cai,Shuya Yu,Mengyue Wang	LM11	Logistics Management11	2016-07-27	15:10-17:00	SD304
347	Jinwen Cai,Xiang'an Kuang,Shaohua Song,Qilan Zhao	LM11	Logistics Management11	2016-07-27	15:10-17:00	SD304

349	Qianqian Zhang,Honglu Liu,Shifeng Liu,Zhihong Tian	IM6	Information Management6	2016-07-25	15:30-17:00	Lec Room 3
350	Kun Wang	IM8	Information Management8	2016-07-27	13:00-14:50	SD304
351	Huiyun Yang,Qianqian Shao,Xin Chang,Zhihong Jin	SCM1	Sustainable Container Supply Chain Management1	2016-07-26	09:00-18:00	SD611
352	Bowen Qin,Hanping Hou	LM7	Logistics Management7	2016-07-27	08:00-09:50	SD304
353	Jianliang Yang,Hanping Hou,Lu Han,Dawei Zhang	LM11	Logistics Management11	2016-07-27	15:10-17:00	SD304
354	Xiaoxiao Zheng,Yisheng Liu,Ying Shi,Nan Su	EM2	Engineering Management2	2016-07-26	08:00-09:50	SD304
355	Chaoyu Li,Jun Ren,Jin Wang,Dan Chang,Zaili Yang	SCM1	Sustainable Container Supply Chain Management1	2016-07-26	09:00-18:00	SD611
357	Lu Han,Hanping Hou,Jianliang Yang,Jieyi Xie	LM6	Logistics Management6	2016-07-27	08:00-09:50	SD303
358	Bjorn Jager,Ning Lin	SCM1	Sustainable Container Supply Chain Management1	2016-07-26	09:00-18:00	SD611
359	Ping Li	LM11	Logistics Management11	2016-07-27	15:10-17:00	SD304
360	Jing Shi,Dong Li,Yang Zhou,Shuo Dang	SCM1	Sustainable Container Supply Chain Management1	2016-07-26	09:00-18:00	SD611
361	Yixuan Ma,zhenji Zhang	IM6	Information Management6	2016-07-25	15:30-17:00	Lec Room 3
362	Beibei Pang,Juanqiong Gou,Wenxin Mu,Huan Qiao	IM4	Information Management4	2016-07-26	13:00-14:50	SD303
363	Xin Lu,Hong-yuan Shi,Li Wang,Da-wei Li	LM3	Logistics Management3	2016-07-26	15:10-17:00	SD303
364	Subira Exauty,Hongmin Gao,Xuetian Wang,Xiangzhi Yu	IM4	Information Management4	2016-07-26	13:00-14:50	SD303
366	Zhenping Li,Yuan Zhang	LM6	Logistics Management6	2016-07-27	08:00-09:50	SD303
368	Shouting Zhao	LM9	Logistics Management9	2016-07-26	09:00-10:30	Lec Room 3
370	Nannan Hu,Jie Wang,Dong Mu	LM11	Logistics Management11	2016-07-27	15:10-17:00	SD304

372	Chenyang Cai,Xuedong Chen	IM8	Information Management8	2016-07-27	13:00-14:50	SD304
373	Kun Zhang,Zhenji Zhang	IM6	Information Management6	2016-07-25	15:30-17:00	Lec Room 3
375	Qingling Guan,Jing Zhou,Yujia Liu	SM3	Service Management3	2016-07-27	10:10-12:00	SD308
376	Guohua Wang,Wenliang Bian	LM11	Logistics Management11	2016-07-27	15:10-17:00	SD304
378	Simin An, Jiayi Yao	LM11	Logistics Management11	2016-07-27	15:10-17:00	SD304
379	Qiwen Du,Xianliang Shi	SCM1	Sustainable Container Supply Chain Management1	2016-07-26	09:00-18:00	SD611
381	Meiqing Zhang,Dayang Hu	SM3	Service Management3	2016-07-27	10:10-12:00	SD308
382	Ji Tian,Dan Chang	SCM1	Sustainable Container Supply Chain Management1	2016-07-26	09:00-18:00	SD611
388	Liang Yanping,Yang Qiang	EM3	Engineering Management3	2016-07-26	08:00-09:50	SD308
390	Yunkai Yan,Yisheng Liu	EM1	Engineering Management1	2016-07-26	08:00-09:50	SD303
391	Yi Mao,Shan'e Xu,Ming Tong	IM3	Information Management3	2016-07-26	10:10-12:00	SD308
392	Zili Liao,Yisong Li	LM4	Logistics Management4	2016-07-26	15:10-17:00	SD304
394	Hong Ji	LM11	Logistics Management11	2016-07-27	15:10-17:00	SD304
395	Yingying Wang,Bing Zhu	IM2	Information Management2	2016-07-26	10:10-12:00	SD304
397	Hu Qing	IM8	Information Management8	2016-07-27	13:00-14:50	SD304
399	Yajing Li, Jiayi Yao	IM8	Information Management8	2016-07-27	13:00-14:50	SD304
400	Li Ting	IM8	Information Management8	2016-07-27	13:00-14:50	SD304
401	Chen Yang,Xi Li,Guoqiang Cai,Jinqing Bo	EM3	Engineering Management3	2016-07-26	08:00-09:50	SD308
402	Qiong Song,GuoQiang Cai,LiMin Jia	EM3	Engineering Management3	2016-07-26	08:00-09:50	SD308
404	Juanqiong Gou,Xiahui Cai,Shuihai Dou	IM1	Information Management1	2016-07-26	10:10-12:00	SD303
406	Xiangxiang Huang,Xiaoling Fu	LM3	Logistics Management3	2016-07-26	15:10-17:00	SD303
407	Yang Zhou	IM8	Information Management8	2016-07-27	13:00-14:50	SD304

408	Lin Li	SM1	Service Management1	2016-07-27	10:10-12:00	SD303
409	Mao Qin,Nian Zhang,Zhipeng Wang	IM7	Information Management7	2016-07-27	13:00-14:50	SD303
410	Yanhai Zhao,Guoxing Zhang,Wei Hou	SM5	Service Management5	2016-07-27	13:20-14:50	Lec Room 3
411	Wei Ding,William Engel,Andre Goode,Giovanni Santostasi	IM6	Information Management6	2016-07-25	15:30-17:00	Lec Room 3
413	Xiaobo Dang,Lunqu Yuan	IM7	Information Management7	2016-07-27	13:00-14:50	SD303
415	Alberto Abadia	SM4	Service Management4	2016-07-26	13:20-14:50	Lec Room 3
417	Yanmin Cheng,Baotian Dong	IM7	Information Management7	2016-07-27	13:00-14:50	SD303
419	Zhuqing Nie	SM5	Service Management5	2016-07-27	13:20-14:50	Lec Room 3
421	Qianqian Wu,Yisheng Liu	EM3	Engineering Management3	2016-07-26	08:00-09:50	SD308
425	Hengyu Liu,Yihong Ru	LM10	Logistics Management10	2016-07-26	10:50-12:20	Lec Room 3
427	Dagang Wang,Ming Lai	IM7	Information Management7	2016-07-27	13:00-14:50	SD303
434	Peng Liu,Wen Liu,Qiang Li,Min Duan,yanrong wang,Yue Dai	IM1	Information Management1	2016-07-26	10:10-12:00	SD303

---

## **Author Index**



Name	Paper ID	Session
Alberto Abadia	415	SM4
Hameeda Akhtar	231	IM2
Simin An	378	LM11
Baoguang Bai	202	SM6
Shaobu Bai	140	LM4
Muhammad Awais Baloch	71	SM1
Dong Baotian	275	IM9
Muhammad Waseem Bari	71	SM1
Rickard Bergqvist	308	SCM1
Wenliang Bian	177	LM8
Wenliang Bian	306	LM12
Wenliang Bian	103	LM14
Wenliang Bian	376	LM11
Wenliang Bian	197	LM8
Zhan Bian	236	LM3
Eduardo Blanco-Davis	338	SCM1
Jinqing Bo	401	EM3
Lu Bo	314	LM11
Chenyang Cai	372	IM8
Guoqiang Cai	401	EM3
GuoQiang Cai	402	EM3
Jinwen Cai	345	LM11
Jinwen Cai	347	LM11
Wen-ming Cai	301	IDA
Xiahui Cai	404	IM1
Xiaolun Cai	336	SM5
Ling Cao	59	SM4
Ying Chai	230	IM1
Dan Chang	144	SCM1
Dan Chang	355	SCM1
Dan Chang	382	SCM1
Jialu Chang	55	SM1
Lei Chang	339	IM8
Xin Chang	351	SCM1
Guopeng Che	241	EM1
Chen Chen	46	SCM1
Feng Chen	213	IM9
Hailan Chen	343	IDA
Jianbin Chen	263	IM6
Jing Chen	29	EM2
Li Chen	29	EM2
Liuxin Chen	125	LM1

Shaoxun Chen	138	LM7
Wen Chen	65	SCM1
Xintong Chen	1	LM15
Xuedong Chen	372	IM8
Yanyu Chen	216	SM6
Zhaomeng Chen	31	LM4
Yanmin Cheng	417	IM7
Fulei Chu	246	SM5
Lina Chuan	177	LM8
Linlin Cui	251	LM7
Yongmei Cui	317	SM5
Yongmei Cui	174	SM6
Kevin Cullinane	308	SCM1
Yue Dai	434	IM1
Bin Dan	58	LM10
Shuo Dang	360	SCM1
Xiaobo Dang	413	IM7
Yunguang Deng	76	IM3
Jing Di	19	IM4
Jingzhi Ding	287	LM12
Shishun Ding	187	SM3
Wei Ding	411	IM6
Yingying Ding	20	IM10
Sijie Diwu	98	LM5
Baotian Dong	417	IM7
Fei Dong	284	IM9
Shuihai Dou	404	IM1
Jianbang Du	119	LM5
Jingen Du	41	SM5
Juanjuan Du	132	IM10
Lei Du	317	SM5
Qiwen Du	379	SCM1
Zhiping Du	80	LM6
Min Duan	434	IM1
Stephanie Eckerd	250	LM2
Olav Eidhammer	308	SCM1
William Engel	411	IM6
Subira Exauty	364	IM4
Shiqi Fan	338	SCM1
Meng Fanchen	71	SM1
Hua Feng	120	IM1
Yunqing Feng	226	EM3
Hui Fu	94	LM14
Liwei Fu	253	IDA
Xiangfei Fu	317	SM5

Xiaoling Fu	406	LM3
Bo Gao	114	SM6
Bo Gao	115	IM10
Changchun Gao	37	LM4
Hongmin Gao	364	IM4
Xuedong Gao	329	IDA
Xuedong Gao	343	IDA
Xuedong Gao	296	IDA
Xuedong Gao	95	IDA
JinHui Ge	233	SM6
Fei Geng	261	SCM1
Xiaoguang Geng	195	SM6
Cunge Gong	323	SM5
Xianwen Gong	290	LM2
Andre Goode	411	IM6
Juanqiong Gou	362	IM4
Juanqiong Gou	404	IM1
Curtis Grimm	250	LM2
Kan Gu	329	IDA
Shougeng Gu	106	LM2
XIAOYU GU	170	SM2
cuiling guan	305	LM3
Qingling Guan	375	SM3
Xiaolan Guan	153	IM1
Zhongliang Guan	116	IM6
Zhongliang Guan	68	IM4
ChunFang Guo	320	IM2
ChunFang Guo	304	IM2
Huili Guo	222	IM1
Lihua Guo	117	IM7
Ming Guo	217	SM6
Ming Guo	340	SM5
Ming Guo	175	SM6
Ming Guo	216	SM6
Shujuan Guo	280	SCM1
Shujuan Guo	282	SCM1
Yanli Guo	263	IM6
Guang Han	133	LM14
Lu Han	357	LM6
Lu Han	353	LM11
Ting Han	143	IM10
Xu Han	289	LM1
Bo He	19	IM4
Hua He	333	LM3
Hua He	331	LM9
Xiaomei He	265	LM4
Yong He	265	LM4

Zhenhuan He	164	SM2
Harald Hjelle	308	SCM1
Hanping Hou	357	LM6
Hanping Hou	118	LM6
Hanping Hou	89	LM6
Hanping Hou	353	LM11
Hanping Hou	352	LM7
Wei Hou	410	SM5
Yu Hou	278	LM1
Dayang Hu	381	SM3
Enhua Hu	300	IM4
Nannan Hu	370	LM11
Guowei Hua	237	LM12
Guowei Hua	328	SCM1
Anqiang Huang	328	SCM1
Bo Huang	342	LM10
Hui Huang	342	LM10
Huishan Huang	55	SM1
Jianhua Huang	150	EM2
Jiaxing Huang	108	LM4
Jisheng Huang	344	SM5
Lei Huang	273	IM8
Lei Huang	335	IM8
Lin Huang	148	LM12
Ming Huang	338	SCM1
Qian Huang	193	IM7
Xiangxiang Huang	406	LM3
Xiuxian Huang	70	SCM1
Yue Huang	194	IDA
Bon-Gang Hwang	239	IM7
Petros Ieromonachou	182	LM2
Petros Ieromonachou	170	SM2
Petros Ieromonachou	148	LM12
Bjorn Jager	358	SCM1
Hong Ji	394	LM11
Junheng Ji	161	SM6
Fengjiao Jia	259	LM8
LiMin Jia	402	EM3
Zhaoquan Jian	297	LM12
Yutong Jiang	38	IM10
Cheng Jin	228	LM8
Zhihong Jin	261	SCM1
Zhihong Jin	351	SCM1

Zhihong Jin	280	SCM1
Zhihong Jin	282	SCM1
Zhimei Jin	19	IM4
Zhiru Juan	62	LM5
Marta Kadłubek	245	LM12
Paula Koch	245	LM12
Xiang'an Kuang	347	LM11
Joachim Kuhn	184	LM2
Xiaoyan Kui	120	IM1
Ming Lai	427	IM7
Shuang Lai	323	SM5
Hongjie Lan	181	LM1
Hongjie Lan	138	LM7
Hongjie Lan	106	LM2
Kun Lan	41	SM5
Ming Lei	93	LM3
Chaofeng Li	248	IM9
Chaofeng Li	249	IM9
Chaoyu Li	355	SCM1
Chuangang Li	339	IM8
Cuiwei Li	77	SM3
Da-wei Li	363	LM3
Dewei Li	187	SM3
Dong Li	360	SCM1
Hong Li	212	IM9
Hui Li	205	SM1
Jiange Li	120	IM1
Jing Li	134	LM13
Jing Li	110	IM10
Jinghua Li	344	SM5
Jingju Li	34	LM8
Juan Li	24	LM2
Jun Li	305	LM3
Junjun Li	155	LM13
Ke Li	310	LM12
Lei Li	297	LM12
Lifeng Li	206	IM10
Lin LI	408	SM1
Ling Li	296	IDA
Menggang Li	153	IM1
Min Li	297	LM12
Ping Li	359	LM11
Qiang Li	434	IM1
Qiuyan Li	215	LM13
Weiwei Li	11	LM15
Wenjuan Li	24	LM2

Wenjuan Li	78	LM1
Xi Li	401	EM3
Xiao Li	77	SM3
Xiaoting Li	264	EM3
Xiaoting Li	234	EM2
Xiaotong Li	124	IM3
Xuemei Li	226	EM3
Xuemei Li	188	SM6
Xuemei Li	222	IM1
Xuwei Li	226	EM3
Xueyan Li	188	SM6
Yajing Li	399	IM8
Yan Li	286	LM10
Yanjin Li	244	IM7
Yanjin Li	241	EM1
Ying Li	141	IM10
Yisong Li	183	LM5
Yisong Li	289	LM1
Yisong Li	259	LM8
Yisong Li	392	LM4
Yuyu Li	342	LM10
Zhanqiang Li	75	LM1
Zhenping Li	366	LM6
Zhuangkuo Li	1	LM15
Taixin Liang	235	EM2
Zili Liao	392	LM4
Changgui Lin	86	LM14
Chunguang Lin	303	EM2
Jiun-Hung Lin	131	SM1
Ning Lin	308	SCM1
Ning Lin	358	SCM1
Xin Lin	261	SCM1
Yong Lin	182	LM2
Yong Lin	171	LM2
Yong Lin	148	LM12
Zikui Lin	52	SM6
ZiKui Lin	56	LM15
Zikui Lin	66	LM15
Can Liu	58	LM10
Hengyu Liu	425	LM10
Honglu Liu	349	IM6
Jian Liu	125	LM1
Jiaying Liu	209	IM9
Jicai Liu	239	IM7
Jing Liu	263	IM6
Liu Liu	304	IM2
Lu Liu	283	LM12

Mengying Liu	17	LM7
Miao Liu	101	SM6
Mingze Liu	218	SCM1
Peng Liu	434	IM1
Qianqian Liu	306	LM12
Ruijian Liu	217	SM6
Shifeng Liu	349	IM6
Shifeng Liu	157	SM6
Shifeng Liu	206	IM10
Shuzhen Liu	175	SM6
Sijing Liu	55	SM1
Tiezhong Liu	114	SM6
Tiezhong Liu	115	IM10
Wei Liu	78	LM1
Wei Liu	24	LM2
Wen Liu	434	IM1
Xiangchao Liu	333	LM3
Xiangdong Liu	93	LM3
Xiaoman Liu	110	IM10
Yisheng Liu	421	EM3
Yisheng Liu	354	EM2
Yisheng Liu	60	EM1
Yisheng Liu	390	EM1
Yonghong Liu	244	IM7
Yue Liu	262	SM5
Yujia Liu	375	SM3
Yujia Liu	230	IM1
Yujia Liu	198	IM4
Yuming Liu	196	EM2
Zhenhua Liu	50	LM5
Zhi Liu	238	IM7
Zhongliang Liu	157	SM6
Aoqing Lu	50	LM5
Jianfeng Lu	94	LM14
Qian Lu	192	LM5
Xiaochun Lu	81	LM1
Xiaochun Lu	65	SCM1
Xin Lu	363	LM3
Xinman Lu	251	LM7
Hao Luo	164	SM2
Xia Luo	238	IM7
Xia Luo	262	SM5
Xia Luo	193	IM7
Zhenyu Luo	331	LM9
Chengwen Lv	235	EM2
Qinghua Lv	140	LM4
Qingyang Lv	311	IM3

Xiyan Lv	124	IM3
Xiyan Lv	176	IM1
Changsong Ma	333	LM3
Changsong Ma	331	LM9
Haichao Ma	93	LM3
Jianhua Ma	145	IM6
Jianhua Ma	254	LM9
Rui Ma	267	IM4
Shiyu Ma	77	SM3
Weiwei Ma	37	LM4
Yanyang Ma	263	IM6
Yixuan Ma	361	IM6
Yunfang Ma	144	SCM1
Lina Mao	344	SM5
Yi Mao	391	IM3
Zhe Mao	46	SCM1
Nur Amira Mat Saffie	313	IM2
Yifeng Miao	213	IM9
Jianing Min	228	LM8
Xiao Ming	231	IM2
Nur Amirah Mohd Shukor	313	IM2
Dong Mu	255	LM2
Dong Mu	74	LM14
Dong Mu	370	LM11
Dong Mu	64	LM15
Dong Mu	224	LM13
Dong Mu	276	LM12
Dong Mu	200	LM13
Wenxin Mu	362	IM4
Lei Nie	164	SM2
Zhuqing Nie	419	SM5
Ying Ning	278	LM1
Ziren Niu	191	EM1
Edward Ochieng	73	EM3
Yanchun Pan	145	IM6
Beibei Pang	362	IM4
John-Patrick Paraskevas	250	LM2
Liyu Peng	226	EM3
Duan Pengzhe	275	IM9
Dan Petrica	321	SM1
Qian Pu	207	LM9
Dayu Qi	55	SM1
Wei Qi	265	LM4
Yang Qiang	388	EM3
Wang Qianying	200	LM13

Huan Qiao	362	IM4
Bowen Qin	352	LM7
Jingjing Qin	52	SM6
Lan Qin	301	IDA
Mao Qin	409	IM7
Mao Qin	241	EM1
Hu Qing	397	IM8
Bin Qiu	255	LM2
Xiaoting Qu	284	IM9
Zhuohua Qu	308	SCM1
Qingyun Ran	335	IM8
Khairul A. Rasmani	313	IM2
Jun Ren	355	SCM1
Wei Ren	235	EM2
Yi Ren	77	SM3
Yihong Ru	425	LM10
Yihong Ru	150	EM2
Ximing Ruan	73	EM3
Giovanni Santostasi	411	IM6
Xusheng Shang	205	SM1
Liping Shao	267	IM4
Liping Shao	311	IM3
Qianqian Shao	351	SCM1
Yanmin Shao	214	SM2
Lixin Shen	282	SCM1
Xiaoqian Shen	302	IM8
Yanting Shen	176	IM1
Fushen Sheng	29	EM2
Hong-yuan Shi	363	LM3
Jia Shi	101	SM6
Jing Shi	360	SCM1
Meixia Shi	53	IM1
Qianru Shi	18	LM8
Wenxia Shi	22	SM2
Xianliang Shi	379	SCM1
Xianliang Shi	218	SCM1
Xianliang Shi	328	SCM1
Xianliang Shi	70	SCM1
Ying Shi	354	EM2
Xianzhu Si	3	SM1
Bohui Song	17	LM7
Bohui Song	18	LM8
Guang Song	92	LM14
Juanjuan Song	78	LM1
Mingming Song	135	LM13

Mingxing Song	150	EM2
Qiong Song	402	EM3
Shaohua Song	345	LM11
Shaohua Song	347	LM11
Xin Song	335	IM8
Zhigang Song	135	LM13
Bing Su	103	LM14
Nan Su	354	EM2
Changfu Sun	214	SM2
Ling Sun	24	LM2
Wenxian Sun	182	LM2
Wenxian Sun	148	LM12
Xi-an Sun	295	IM9
Xi-an Sun	133	LM14
Xiaohua Sun	122	EM1
Yao Sun	197	LM8
Yu Sun	34	LM8
Min Tang	41	SM5
Xiaofei Tang	108	LM4
Christina Tay	210	IM6
Li Teng	185	LM7
Wei Teng	28	IM2
Ji Tian	382	SCM1
Yaming Tian	235	EM2
Yuan Tian	17	LM7
Yuan Tian	18	LM8
Yuan Tian	260	IM9
Zhihong Tian	349	IM6
Li Ting	400	IM8
Ming Tong	391	IM3
Abdur Rauf Usama	231	IM2
Truong Van Nguyen	171	LM2
Yuqian Wan	287	LM12
Ai Wang	95	IDA
Cheng Wang	233	SM6
Chunyue Wang	276	LM12
Dagang Wang	427	IM7
Danyue Wang	329	IDA
Dongmei Wang	203	LM13
Dongmei Wang	34	LM8
Guohua Wang	376	LM11
Haiyan Wang	62	LM5
He Wang	323	SM5
Hongzhen Wang	177	LM8
Huimin Wang	125	LM1

Jie Wang	273	IM8
Jie Wang	370	LM11
Jin Wang	338	SCM1
Jin Wang	355	SCM1
Jing Wang	203	LM13
Jinxiao Wang	237	LM12
Kun Wang	350	IM8
Li Wang	363	LM3
Lingyu Wang	291	SM2
Lingyu Wang	121	SM3
Mengyue Wang	345	LM11
Mingbao Wang	80	LM6
Qiguang Wang	312	LM11
Ruiting Wang	105	LM6
Shuai Wang	309	EM1
Wenjie Wang	37	LM4
Xiangge Wang	69	IM4
Xiao Wang	95	IDA
Xiaojie Wang	68	IM4
Xiaoxia Wang	75	LM1
Xindi Wang	309	EM1
Xing Wang	286	LM10
Xing Wang	322	LM10
Xuebing Wang	319	LM7
Xuetian Wang	364	IM4
yanrong wang	434	IM1
Yifei Wang	168	IM10
Ying Wang	273	IM8
Ying Wang	335	IM8
Yinglin Wang	239	IM7
Yingying Wang	395	IM2
Yong Wang	211	LM13
Yong Wang	192	LM5
Yongli Wang	293	LM12
Yuhong Wang	308	SCM1
Zhenwei Wang	207	LM9
Zhipeng Wang	262	SM5
Zhipeng Wang	409	IM7
Gui-ying Wei	301	IDA
Hang Wei	126	LM3
Jie Wei	126	LM3
Haitao Wen	286	LM10
Haitao Wen	322	LM10
Jing Wen	183	LM5
Yingchun Wen	340	SM5
Cong Wu	86	LM14
Huasha Wu	322	LM10

Jingbo Wu	224	LM13
Lihong Wu	266	LM4
Liuyi Wu	33	LM15
Qianqian Wu	421	EM3
Qijing Wu	59	SM4
Qing Wu	46	SCM1
Sen Wu	253	IDA
Yisheng Wu	140	LM4
Yang Xia	48	IM3
Yunfei Xia	166	LM8
Jing Xiang	224	LM13
Quan Xiao	330	SM2
Quan Xiao	130	IM3
Xuefeng Xiao	120	IM1
Ruan Xiaowen	243	SM5
Bo Xie	298	IM9
Haihong Xie	33	LM15
Jieyi Xie	357	LM6
Zirui Xie	102	IM2
Cao Xing	134	LM13
Lei Xing	280	SCM1
Lei Xing	282	SCM1
Li Xiong	152	IM6
Gang Xu	235	EM2
Jiangfeng Xu	38	IM10
Jie Xu	203	LM13
Jie Xu	61	LM15
Lan Xu	28	IM2
Lijuan Xu	209	IM9
Lijuan Xu	292	SM5
Qi Xu	261	SCM1
Qi Xu	37	LM4
Shan'e Xu	391	IM3
Wei Xu	278	LM1
Xiangrong Xu	300	IM4
Xibao Xu	64	LM15
Shan Xue	152	IM6
Yihan Xue	320	IM2
Xinping Yan	338	SCM1
Yunkai Yan	390	EM1
Chen Yang	401	EM3
Hongtao Yang	119	LM5
Huiyun Yang	351	SCM1
Jianliang Yang	357	LM6
Jianliang Yang	353	LM11
Jianliang Yang	118	LM6
Minghan Yang	296	IDA

Mingjing Yang	248	IM9
Mingjing Yang	249	IM9
Miying Yang	73	EM3
Wen Yang	254	LM9
Wen Yang	145	IM6
Xiaobing Yang	220	SM3
Xiru Yang	203	LM13
Xiru Yang	61	LM15
Xuerong Yang	162	IM3
Yingjun Yang	11	LM15
Zaili Yang	308	SCM1
Zaili Yang	355	SCM1
Zaili Yang	328	SCM1
Zhenhua Yang	280	SCM1
Zhenhua Yang	282	SCM1
Liang Yanping	388	EM3
Jiayi Yao	101	SM6
Jiayi Yao	38	IM10
Jiayi Yao	399	IM8
Jiayi Yao	378	LM11
Li Yao	56	LM15
Lijun Yao	181	LM1
Yazhi Yao	3	SM1
Long Ye	336	SM5
Long Ye	217	SM6
Long Ye	216	SM6
Long Ye	175	SM6
Wen Ye	3	SM1
Yuan Ye	128	LM3
Bing Yin	235	EM2
Chao Yin	223	LM4
Chengcheng Yin	112	LM14
Jun Yin	81	LM1
Baoqin Yu	251	LM7
Bofeng Yu	286	LM10
Hang Yu	331	LM9
Hongqi Yu	74	LM14
Jian Yu	279	EM1
Mingli Yu	89	LM6
Qilin Yu	295	IM9
Shuya Yu	345	LM11
Xiangzhi Yu	364	IM4
Jianfeng Yuan	254	LM9
Lunqu Yuan	413	IM7
Chaolong Yue	189	LM13
Xiaoxue Zeng	64	LM15
Chao Zhang	34	LM8

Chenwei Zhang	60	EM1
Chi Zhang	335	IM8
Dawei Zhang	118	LM6
Dawei Zhang	353	LM11
Di Zhang	338	SCM1
Fan Zhang	338	SCM1
Fengyangzi Zhang	92	LM14
Guanxiang Zhang	86	LM14
Guoxing Zhang	410	SM5
Hanwen Zhang	24	LM2
Hongmei Zhang	333	LM3
Huiying Zhang	66	LM15
Jian Zhang	202	SM6
Jian Zhang	224	LM13
Jian Zhang	196	EM2
Jianjun Zhang	22	SM2
Jing Zhang	150	EM2
Juan Zhang	305	LM3
Kai Yuan Zhang	102	IM2
Keming Zhang	200	LM13
Keming Zhang	237	LM12
Keming Zhang	255	LM2
Keming Zhang	276	LM12
Kun Zhang	206	IM10
Kun Zhang	373	IM6
Lu Zhang	305	LM3
Meiqing Zhang	381	SM3
Min Zhang	260	IM9
Mingyang Zhang	127	LM9
Mingyu Zhang	223	LM4
Nian Zhang	409	IM7
Pei Zhang	118	LM6
Peilin Zhang	192	LM5
Pinning Zhang	77	SM3
Qi Zhang	213	IM9
Qianqian Zhang	349	IM6
Qing Zhang	79	LM6
Qiusheng Zhang	249	IM9
Shuiwang Zhang	189	LM13
Xiang Zhang	105	LM6
Xiang Zhang	98	LM5
Xuan Zhang	246	SM5
Xuan Zhang	162	IM3
Xumei Zhang	58	LM10
Yixin Zhang	274	LM7

Yong Zhang	240	LM1
Yuan Zhang	366	LM6
Yuling Zhang	117	IM7
Yunan Zhang	339	IM8
Zehao Zhang	41	SM5
Zhaofeng Zhang	205	SM1
Zhe Zhang	116	IM6
zhenji Zhang	361	IM6
Zhenji Zhang	328	SCM1
Zhenji Zhang	373	IM6
Zhiyuan Zhang	292	SM5
Chen Zhao	235	EM2
Leizhou Zhao	79	LM6
Lu Zhao	152	IM6
Qilan Zhao	135	LM13
Qilan Zhao	266	LM4
Qilan Zhao	155	LM13
Qilan Zhao	215	LM13
Qilan Zhao	161	SM6
Qilan Zhao	274	LM7
Qilan Zhao	347	LM11
Rongxia Zhao	57	IM10
Shouting Zhao	368	LM9
Shuzhi Zhao	286	LM10
Yan Zhao	174	SM6
Yanhai Zhao	410	SM5
Zhichen Zhao	55	SM1
Zhiqiang Zhao	211	LM13
Hongyun Zheng	108	LM4
Xiaoxiao Zheng	354	EM2
Huiling Zhong	86	LM14
Miner Zhong	240	LM1
Jianqin Zhou	310	LM12
Jianqin Zhou	283	LM12
Jing Zhou	132	IM10
Jing Zhou	375	SM3
Jing Zhou	230	IM1
Lis Zhou	170	SM2
Li Zhou	171	LM2
Maosen Zhou	58	LM10
Xiaozhao Zhou	213	IM9
Yang Zhou	407	IM8
Yang Zhou	360	SCM1
Yingping Zhou	46	SCM1
Bing Zhu	273	IM8
Bing Zhu	395	IM2
Hai Zhu	193	IM7

Hai Zhu	238	IM7
Hai Zhu	244	IM7
Minghao Zhu	159	LM5
Rongyan Zhu	211	LM13
Shufan Zhu	211	LM13
Wangli Zhu	53	IM1
Xiaomin Zhu	207	LM9
Xueping Zhu	195	SM6
Zhiying Zhu	339	IM8
Zuqiang Zhu	302	IM8
Tarila Zuofa	73	EM3



